

ULINE H-10923, H-10924
H-10925, H-10926

PLASTIC PLATFORM TRUCKS

1-800-295-5510
uline.com

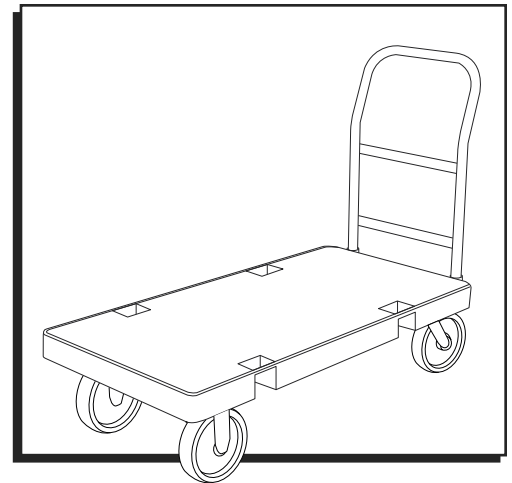

TOOLS NEEDED

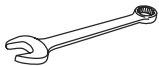

1/2" Wrench
9/16" Wrench



1/2" Socket Wrench
9/16" Socket Wrench

PARTS

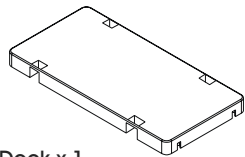

Deck x 1

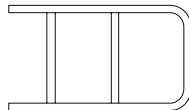

Handle x 1

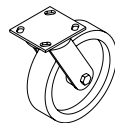

Swivel Caster x 2

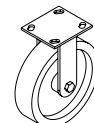

Rigid Caster x 2



Washer x 16



Socket Stiffeners with Welded Nut x 2



Long Screw x 16



Bolt x 2

ASSEMBLY

1. Place deck upside down on a smooth non-marring surface.
2. Fit socket stiffeners into groove in deck. Face the welded nuts toward the middle of the deck. (See Figure 1)

 **NOTE:** A nut is welded to each socket.

3. Place the swivel casters on the deck, at the socket end. (See Figure 1)
4. Place the rigid casters at the opposite end. (See Figure 1)
5. The top plate of each caster is centered over the socket stiffener tube and lined up with the four caster holes in the deck.
6. Secure casters to deck using washers, long screws and 9/16" socket wrench. (See Figure 1)

 **NOTE:** Four long screws and four washers are required per caster.

 **NOTE:** Do not fully tighten long screws.

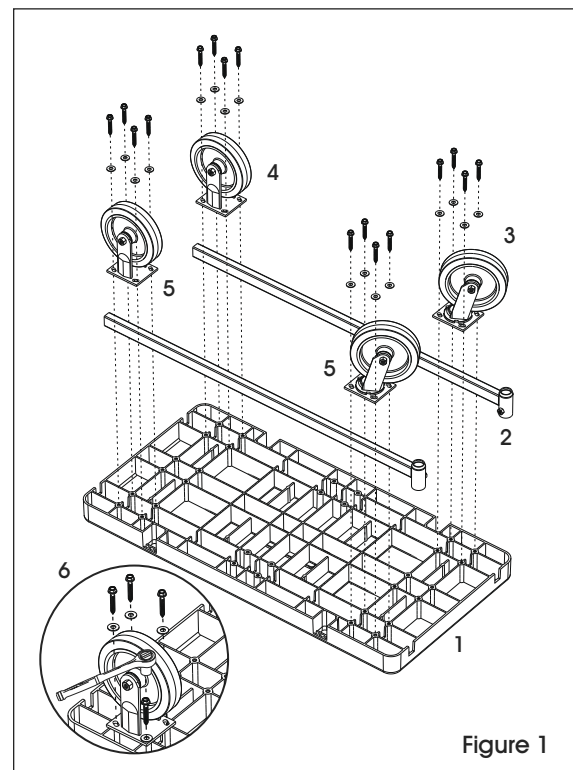
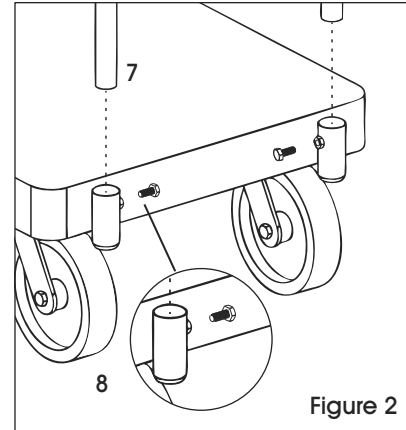

Figure 1

ASSEMBLY CONTINUED

7. Turn the deck over onto its casters and insert the handle into the sockets. (See Figure 2)
8. Thread the bolts into the nut welded to each socket. Tighten securely with 1/2" socket wrench. (See Figure 2)
9. Turn deck onto its side and fully tighten long screws. (See Figure 2)



ULINE

1-800-295-5510
uline.com



H-10923, H-10924
H-10925, H-10926

800-295-5510
uline.mx

CARRITOS CON PLATAFORMA DE PLÁSTICO

HERRAMIENTAS NECESARIAS



Llave de 1/2"
Llave de 9/16"

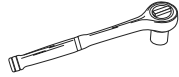

Llave de Dado de 1/2"
Llave de Dado de 9/16"

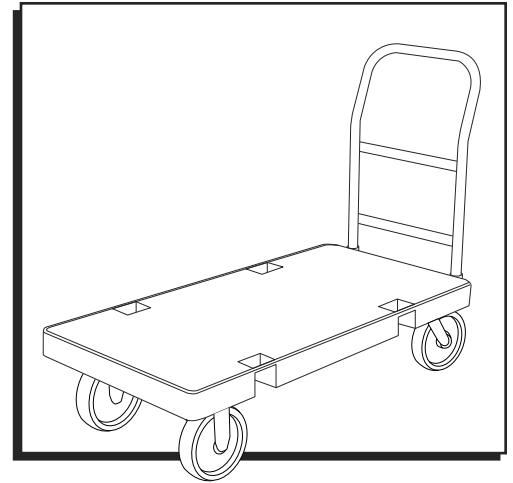

PARTES

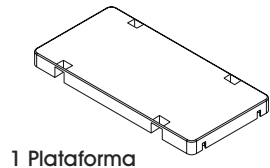

1 Plataforma

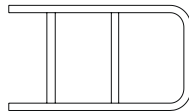

1 Asa



2 Ruedas Giratorias

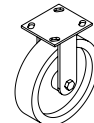

2 Ruedas Fijas



16 Rondanas



2 Refuerzos para Soporte con
Tuerca de Soldada

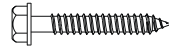

16 Tornillos Largos

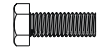

2 Pernos

ENSAMBLE

- Coloque la plataforma boca abajo sobre una superficie lisa y que no deja marcas.
 - Inserte los refuerzos para soporte en la plataforma. Coloque las tuercas soldadas apuntando hacia el centro de la plataforma. (Vea Diagrama 1)
- NOTA:** Una tuerca está soldada en cada soporte.
- Coloque las ruedas giratorias en la plataforma, en el extremo de los soportes. (Vea Diagrama 1)
 - Coloque las ruedas fijas en el extremo opuesto. (Vea Diagrama 1)
 - La placa superior de cada rueda se centra sobre el tubo de los refuerzos para soporte y se alinea con los cuatro orificios para ruedas de la plataforma.
 - Asegure las ruedas a la plataforma utilizando rondanas, tornillos largos y la llave de dado de 9/16". (Vea Diagrama 1)

NOTA: Se requieren cuatro tornillos largos y cuatro rondanas por rueda.

NOTA: No apriete los tornillos largos por completo.



Diagrama 1

CONTINUACIÓN DE ENSAMBLE

7. Voltee la plataforma para que descansa sobre las ruedas e inserte el asa en las soportes.
(Vea Diagrama 2)
8. Enrosque los pernos en la tuerca soldada en cada soporte. Apriete bien con una llave de dado de 1/2".
(Vea Diagrama 2)
9. Voltee la plataforma de lado y apriete por completo los tornillos largos. (Vea Diagrama 2)

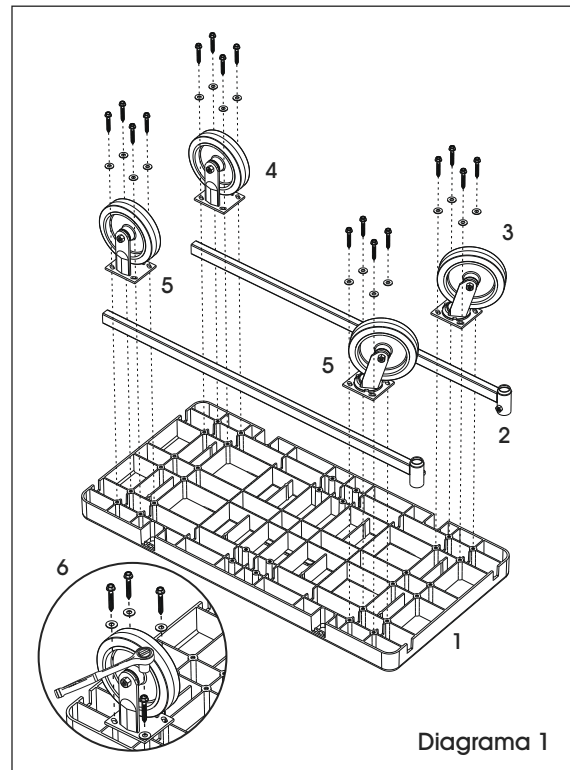
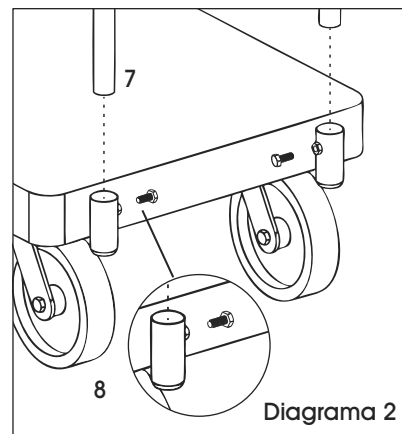

ULINE

800-295-5510
uline.mx

CHARIOTS À PLATEFORME EN PLASTIQUE

OUTILS REQUIS

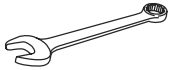

Clé de 1/2 po
Clé de 9/16 po

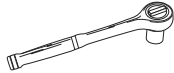

Clé à douilles de 1/2 po
Clé à douilles de 9/16 po

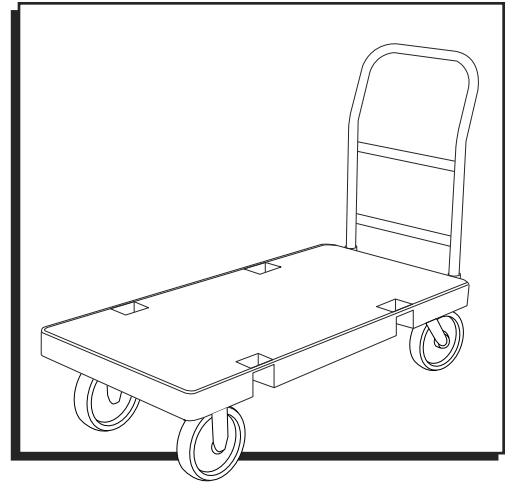

PIÈCES

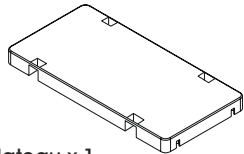

Plateau x 1

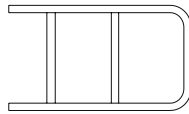

Poignée x 1



Roulette pivotante x 2

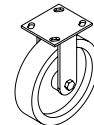

Roulette fixe x 2



Rondelle x 16

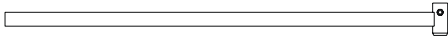

Support d'emboîture avec écrou soudé x 2



Vis longue x 16



Boulon x 2

MONTAGE

1. Déposez le plateau à l'envers sur une surface lisse non marquante.
2. Installez les supports d'emboîture dans les rainures du plateau. Orientez les écrous soudés vers le milieu du plateau. (Voir Figure 1)

 **REMARQUE : Un écrou est soudé à chaque emboîture.**

3. Placez les roulettes pivotantes du côté du plateau où se trouvent les emboîtures. (Voir Figure 1)
4. Placez les roulettes fixes à l'extrémité opposée. (Voir Figure 1)
5. La plaque supérieure de chaque roulette doit être centrée sur le support d'emboîture et alignée avec les quatre trous pour roulettes dans le plateau.
6. Fixez les roulettes au plateau à l'aide des rondelles, des longues vis et de la clé à douilles de 9/16 po. (Voir Figure 1)

 **REMARQUE : Quatre vis longues sont requises par roulette.**

 **REMARQUE : Ne serrez pas complètement les longues vis.**

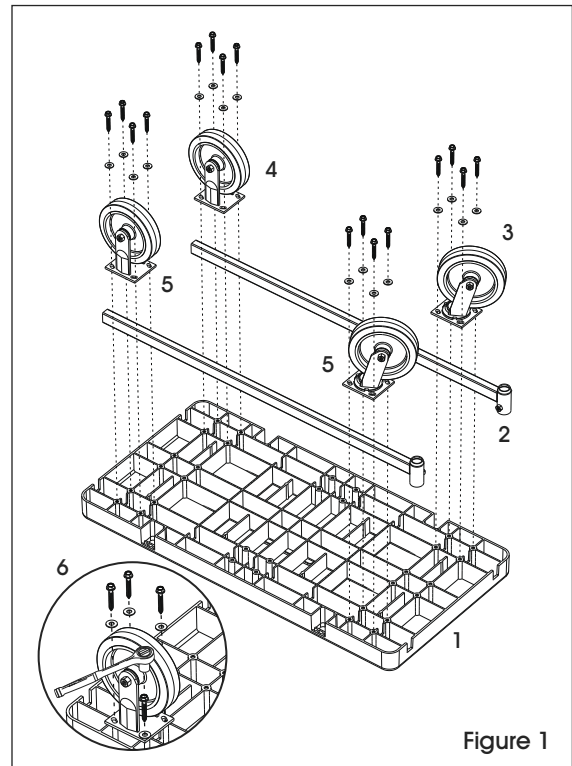

Figure 1

MONTAGE SUITE

7. Retournez le plateau sur ses roulettes et insérez la poignée dans les emboîtures. (Voir Figure 2)
8. Vissez ces boulons dans les écrous soudés à chaque emboîture. Serrez fermement à l'aide d'une clé à douilles de 1/2 po. (Voir Figure 2)
9. Retournez le plateau sur le côté et serrez fermement les longues vis. (Voir Figure 2)

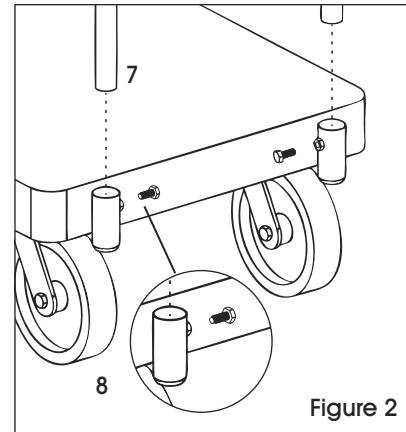

Figure 2

ULINE

1 800 295-5510
uline.ca