

# BMS7780 Series

## ASSEMBLY INSTRUCTIONS

### Tools Required

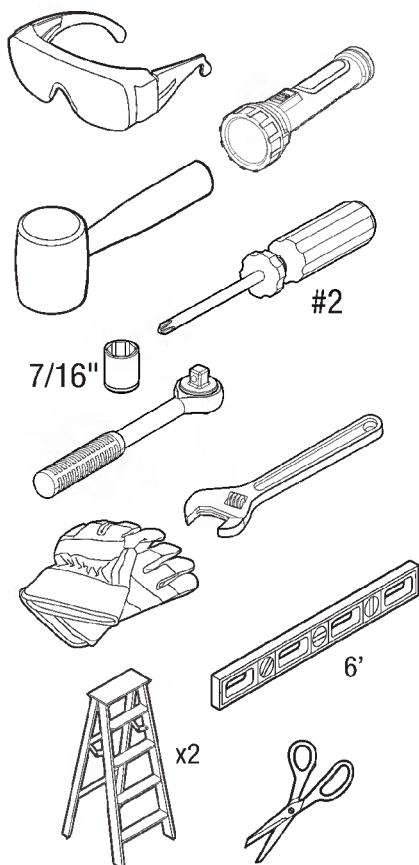

### INCLUDED IN KIT

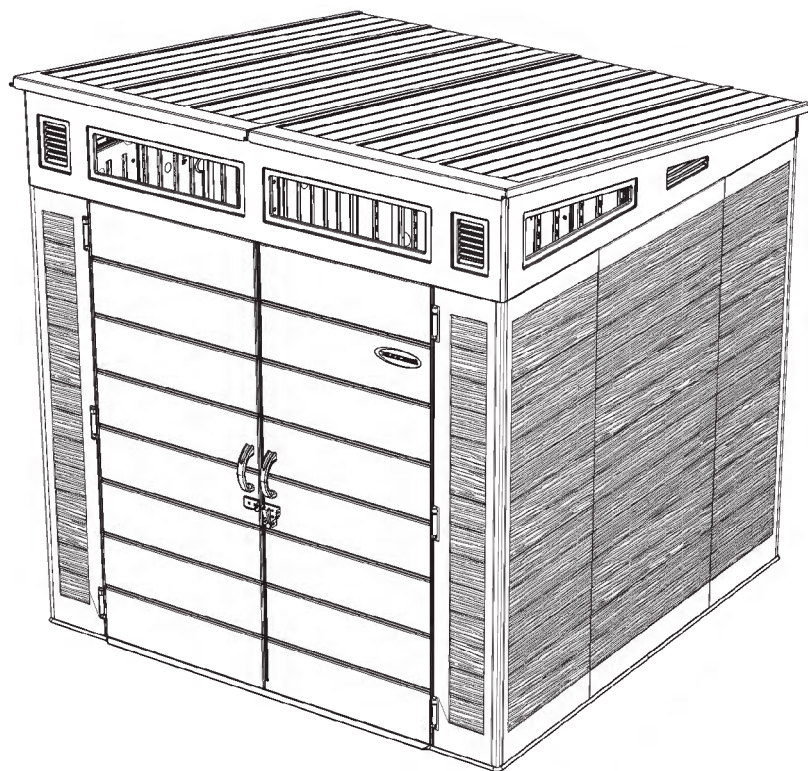
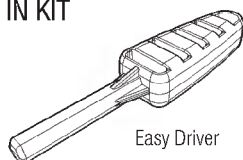

**SUNCAST®**

**Built for Everyday Life™**

# Thank you for purchasing this Suncast® product.

## Register within 90 days of purchase to activate Warranty!

Registration is not required for products with a warranty term of 90 days or less.

1. Verify warranty term of your product by visiting [www/suncast.com/warranty](http://www.suncast.com/warranty) (products with a warranty term of 90 days or less do not require registration)
2. Complete registration: fill out the form and upload a copy of your receipt by visiting <https://support.suncast.com> or scanning the QR code



## Have Questions?

For product questions, assembly assistance, replacement parts and more:



<https://support.suncast.com>



Suncast Corporation Customer Care  
701 N. Kirk Road, Batavia, IL 60510



1-800-846-2345  
1-630-381-6309

**ULINE** H-11339

1-800-295-5510



## Before you Begin...

- **Consult your local authorities for any permits required to construct shed.**

Prior to the construction of your shed, check with the local building code official to review any required permits or building limitations.

- **A level and sturdy foundation is required before shed construction can begin.**

Site preparation information is available later in this manual. A foundation that differs from the specifications within this manual could prevent proper assembly and may damage parts.

- **Read instructions thoroughly prior to assembly.**

This kit contains parts that can be damaged if assembled incorrectly or in the wrong sequence.

- **Please follow instructions.**

Suncast is not responsible for replacing parts lost or damaged due to incorrect assembly.



Indicates at least 1 additional adult is needed to complete this step.

### **IMPORTANT**

**IF FOUNDATION IS REQUIRED, COMPLETE SITE PREPARATION AND FOUNDATION CONSTRUCTION BEFORE UNPACKING ALL PARTS.**

**OPEN ALL BOXES FIRST AND NEATLY LAYOUT PARTS. SMALL PARTS MAY BE CONTAINED IN EACH BOX. PLEASE REFERENCE THE PARTS LIST WITHIN THIS MANUAL TO VERIFY ALL PARTS ARE PRESENT.**



## Caution

- Proper site preparation is required.
- Shed not intended for storage of flammable, caustic or corrosive materials.
- Shed not intended for habitation or for use by children.
- **DO NOT** stand, sit, or store items on the storage shed roof.
- **DO NOT** place near objects that are hot or can become hot.
- Heavy articles should not be leaned against the walls, as this may cause panel distortion and permanent damage.
- Suncast is not responsible for damage caused by weather or misuse.
- This kit contains parts with sharp edges. Please be careful when handling, use of work gloves is recommended.
- **DO NOT** place in areas near highly reflective surfaces (Note: Low-E windows are more reflective than standard windows and may affect the longevity of the product).
- Product is water resistant and now waterproof. Locate unit away from gutter and down spouts for optimal performance.



## Care & Maintenance

- At regular intervals, inspect your shed to make sure that assembly integrity has been maintained. **Repair or replace broken parts immediately.**
- Periodically check that the location you have chosen to set your shed is still level.
- Keep roof clean of snow and leaves.
- To maintain the look of your product, we recommend cleaning it at regular intervals with mild soap and water. **DO NOT** use bleach, ammonia, or other caustic cleaners, and **DO NOT** use stiff bristle brushes. Failure to perform cleaning at regular intervals could result in permanent staining of the plastic. This type of damage is not covered under warranty.



## Assembly Day Tips

- **DO NOT** attempt to assemble on a day with strong winds.
- Set aside appropriate amount of time to completely assemble shed. An incomplete shed assembly may pose a safety hazard.
- Make sure you have assistance nearby to lift and secure parts in place.
- **DO NOT** use a torque wrench or hand drill to tighten Easy bolts. Use provided Easy Bolt Driver ONLY.
- Suncoast provides extra hardware for small fasteners for customer convenience. In some cases, there will be extra small fasteners once the assembly is complete.

**Note:** *This product contains parts that are used in different orientations to construct the shed. Please take note of the orientation of the parts shown throughout this instruction manual. Failure to follow instructions could result in damage to parts. Suncoast is not responsible for replacing parts lost or damaged due to incorrect assembly.*

# Parts - Walls & Floor

## IMPORTANT

OPEN ALL BOXES FIRST AND NEATLY LAY OUT PARTS. SMALL PARTS MAY BE CONTAINED IN EACH BOX. PLEASE REFERENCE THE PARTS LIST WITHIN THIS MANUAL TO VERIFY ALL PARTS ARE PRESENT.

COMPLETE SITE PREPARATION AND FOUNDATION CONSTRUCTION BEFORE UNPACKING ALL PARTS.

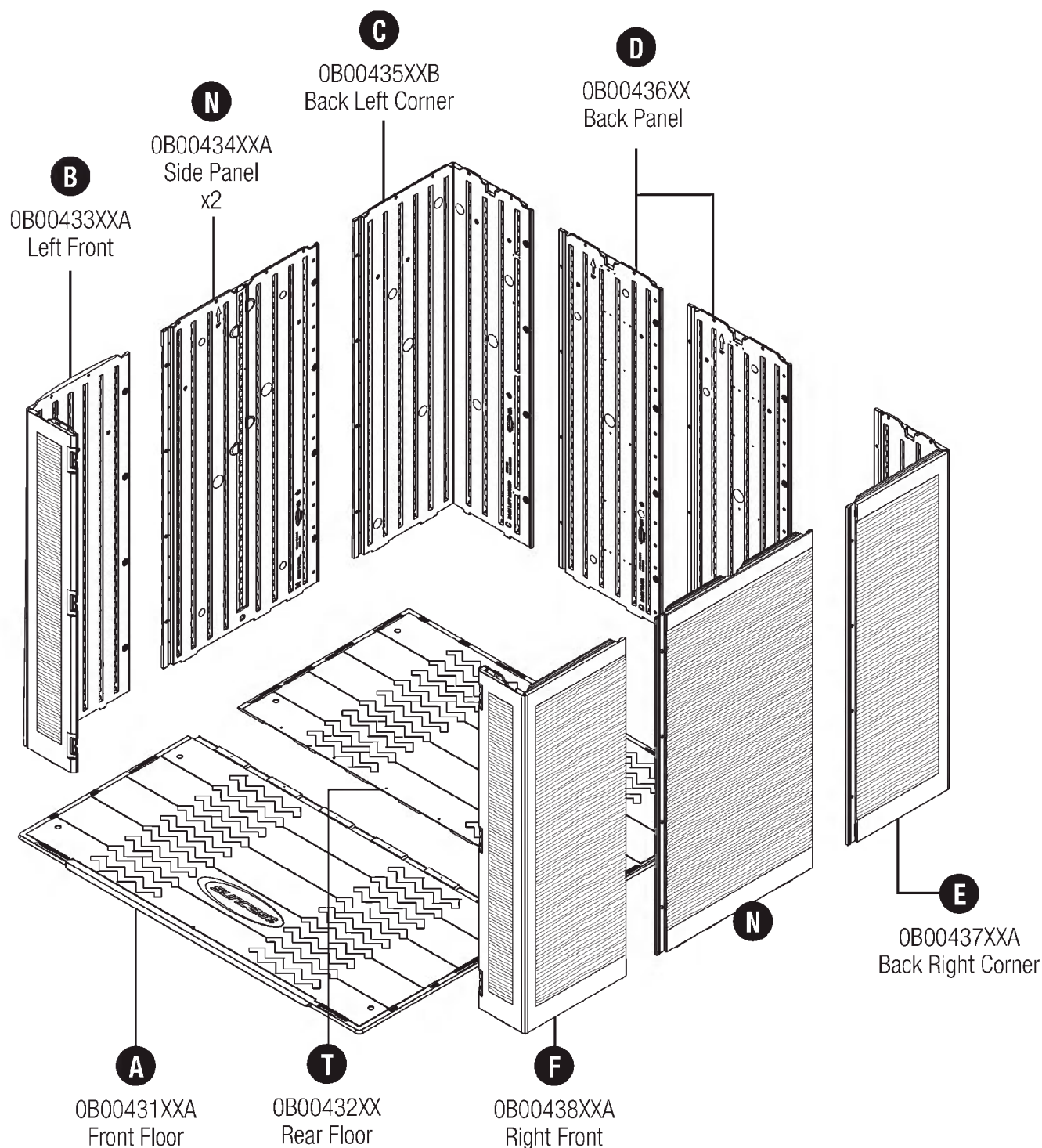

**ULINE** H-11339

1-800-295-5510

## Parts - Doors

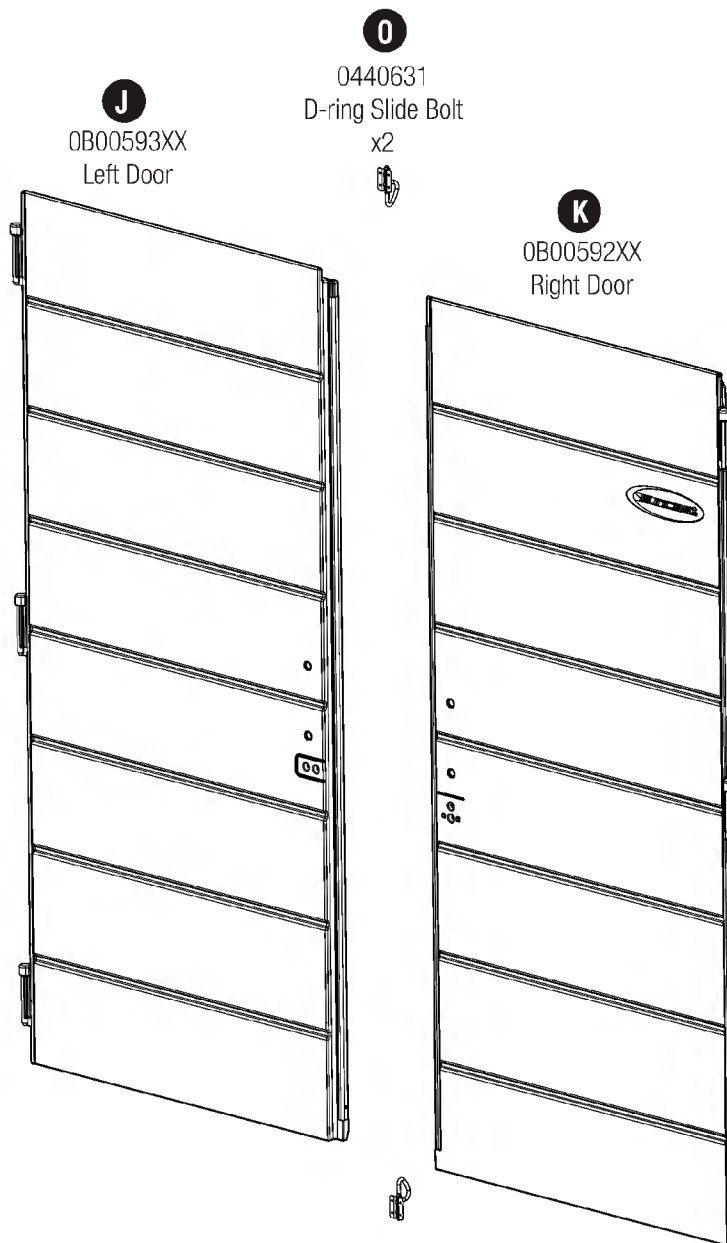

**ULINE** H-11339

1-800-295-5510



## Parts - Roof, Headers & Windows

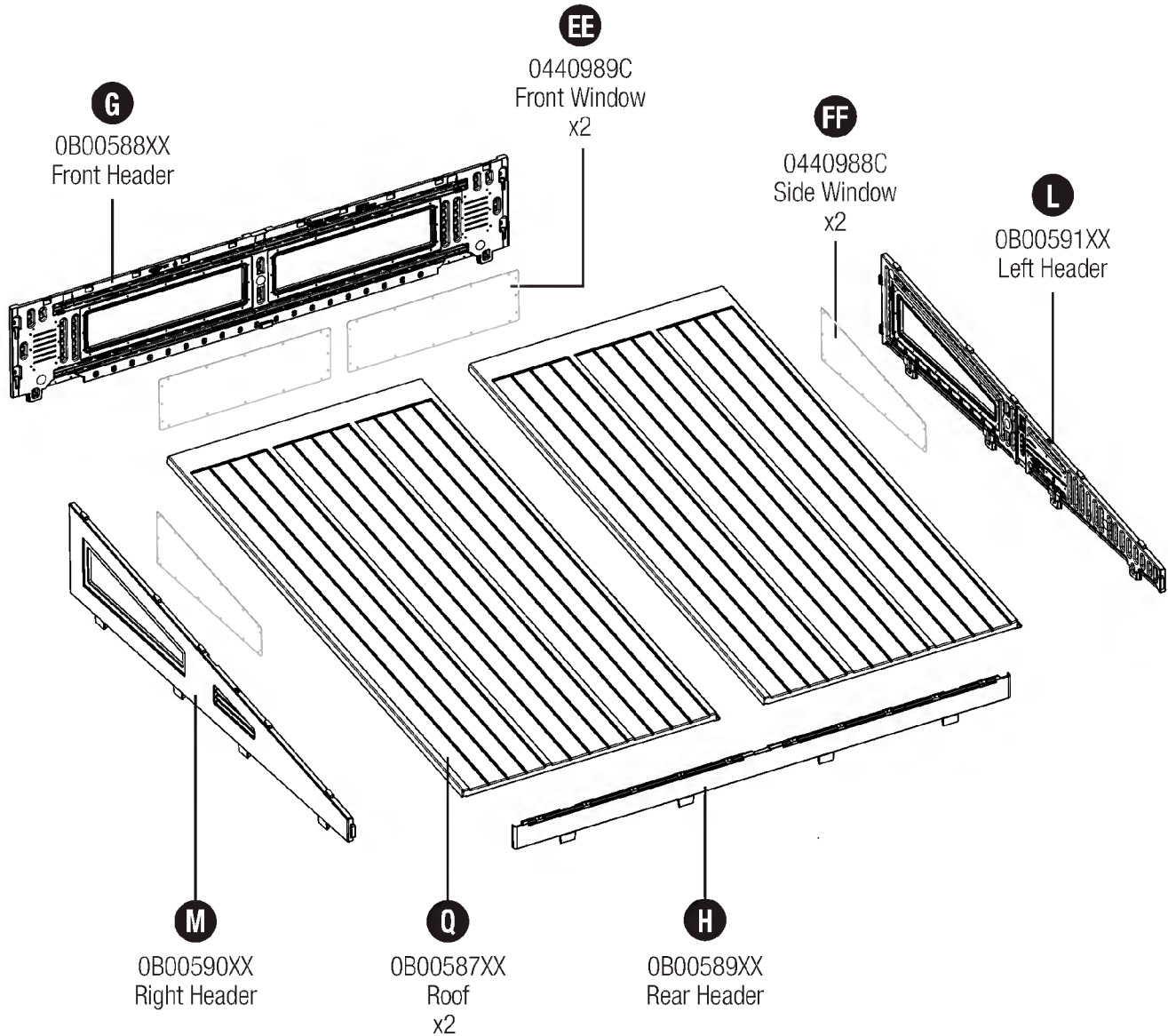

# Parts - Roof Steel

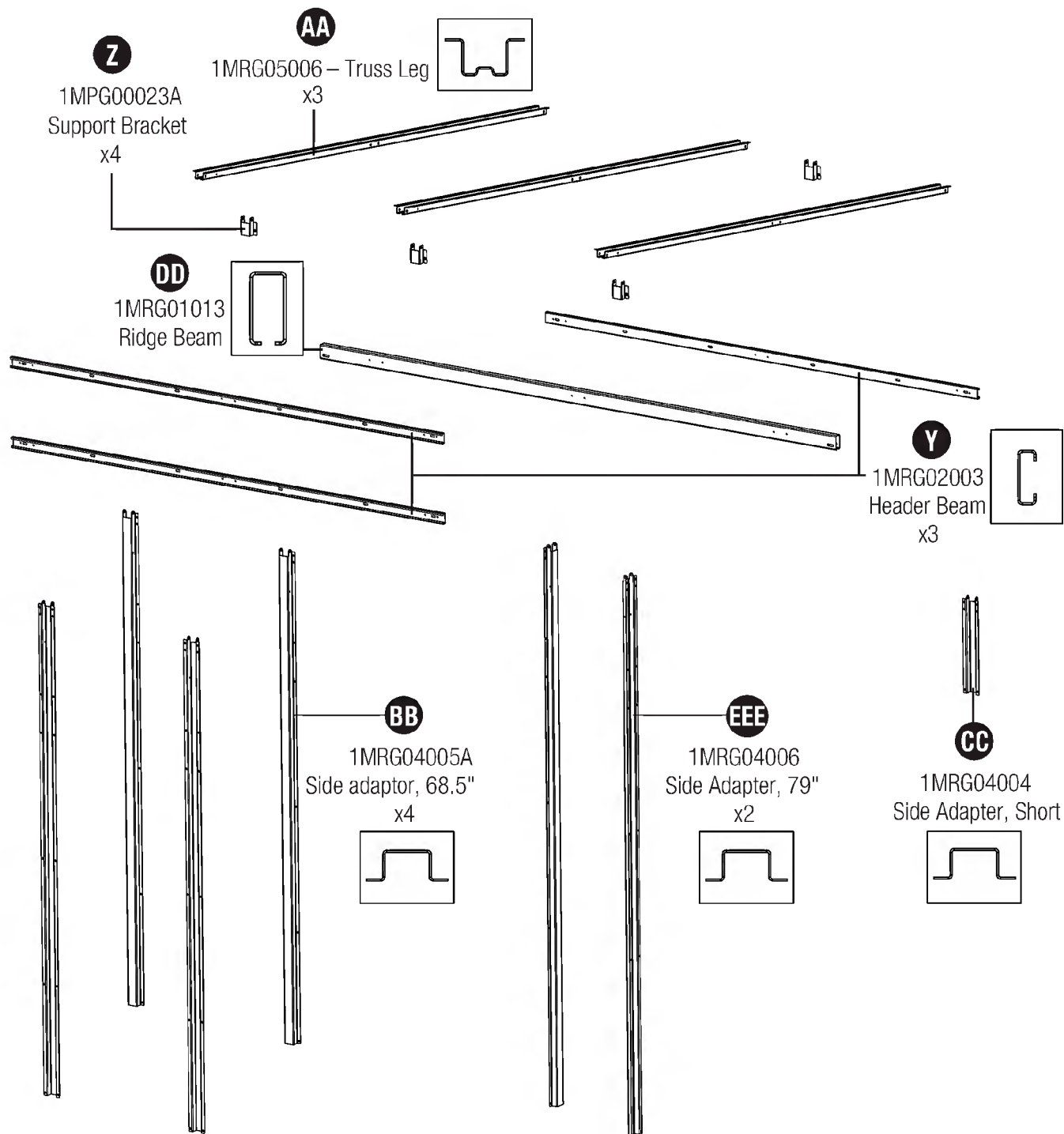



# Hardware

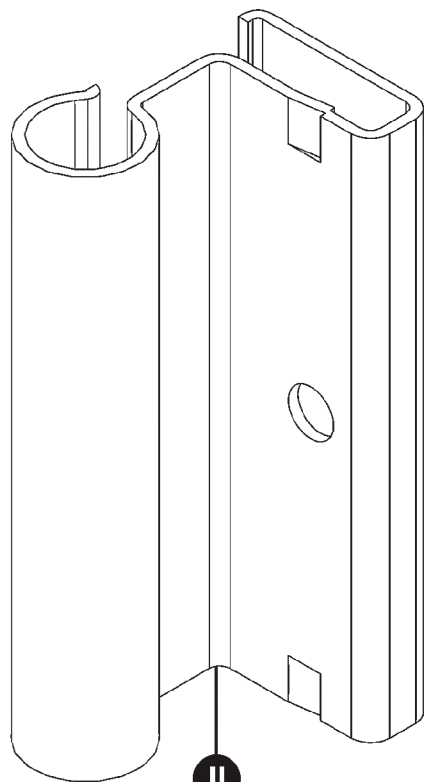

OMP000002 – Door Hinge  
x6

0480375 (x3) – Hardware Bag

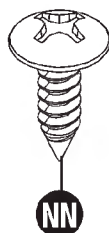

.625" Screw  
x315 (105 per bag)

Wall Adapter Cap

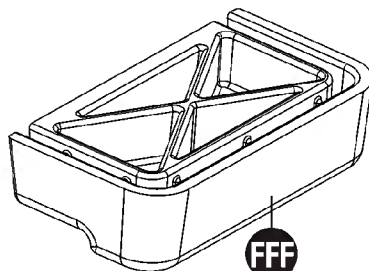

0480493A – Hardware Bag

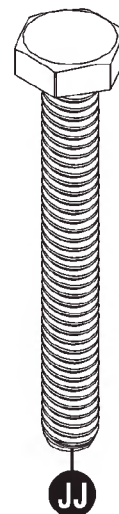

.25" x 2" Hex bolt  
x12

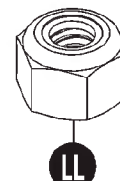

.25" Locking nut  
x12

0480337 – Hardware Bag

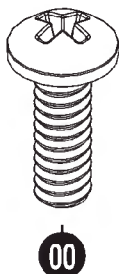

.25" x .75" Screw  
x6

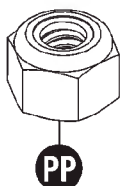

.25" Locking Nut  
x6

Hardware Bag

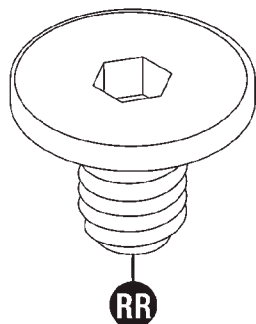

Easy Bolt  
x31

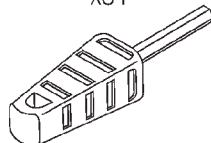

\*Easy Driver

0440990 – Window Gaskets

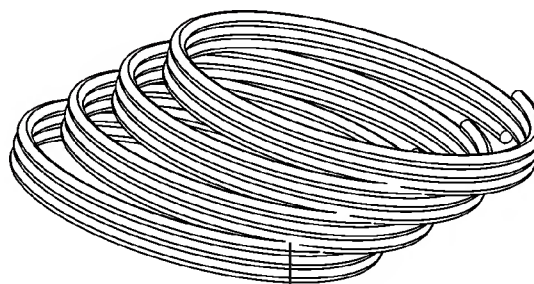

P  
x4

Hardware shown at actual size (\*unless otherwise noted). Extra hardware provided. Not all are used.

# Parts - Door Handle & Door Latch Kits

## 0463795A – Door Handle Kit

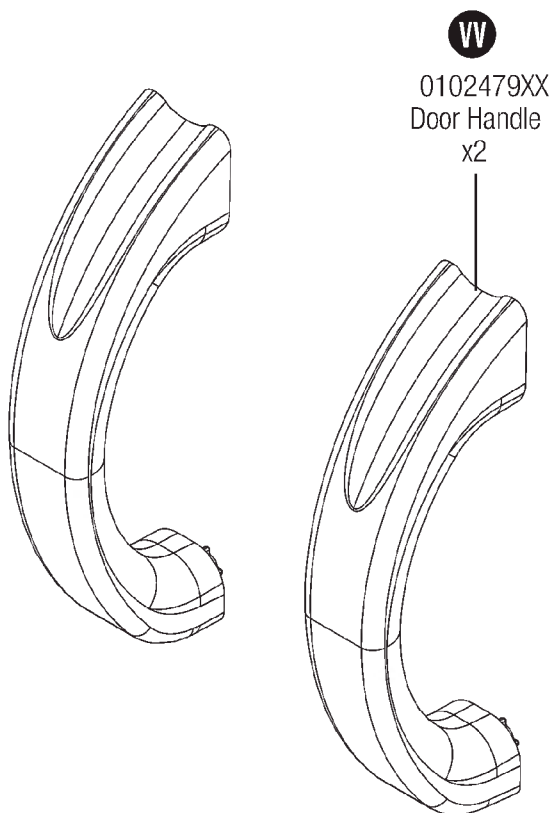

## 0480370 – Hardware bag

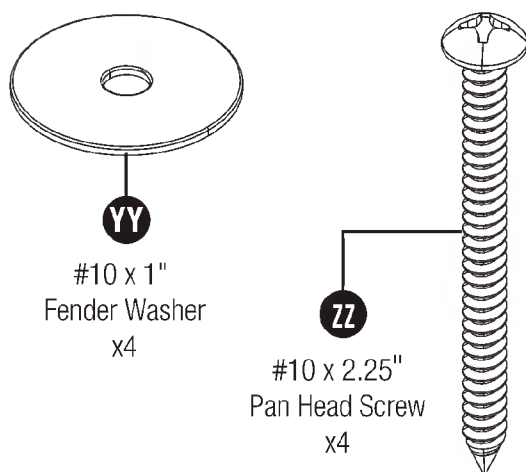

## 0463797 – Door Latch Kit

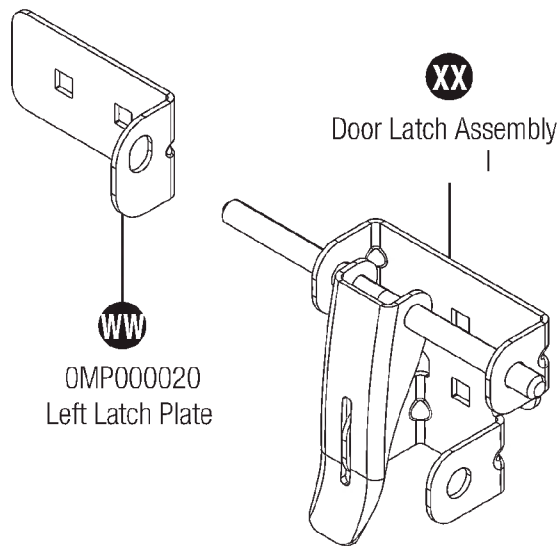

## 0480439A – Hardware bag

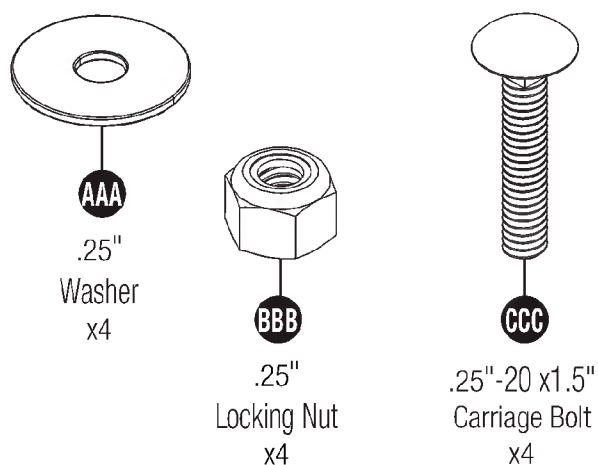

Hardware shown at actual size (\*unless otherwise noted). Extra hardware provided. Not all are used.

**ULINE** H-11339

1-800-295-5510

## Site Preparation and Platform Construction

Materials **NOT** supplied with Shed Kit

### Important:

- **Site preparation is required for this shed. Placing the shed on a properly constructed, square, flat and level foundation, as described below, is required. Without a properly constructed, square, flat and level foundation, settling will eventually occur, causing distortion and damage to the shed. Suncast is not responsible for replacing parts damaged or property lost due to incorrect foundation construction. Warranty requires a properly constructed foundation as described below.**
- **Complete the site preparation and foundation construction before unpacking parts and beginning assembly. For tips on site preparation, go to [www.suncast.com](http://www.suncast.com), consult retailer, or local codes.**

### Site Preparation

1. Consult your local authorities for building codes and covenants before beginning foundation or erecting shed.
2. Before any digging, check with local utilities to determine location of buried cables, pipes, etc.
3. Decide which type of foundation is most suitable for your installation. **The foundation surface must be square, flat and level.** Follow the below guidelines for foundation options:

#### Concrete Slab

- Construct a slab of at least 4" thickness.
- The use of reinforcement bar is recommended.

#### Wood Platform

- Use exterior grade wood.
- Set the platform on pier blocks or footing.

4. Complete the foundation preparations as follows:
  - A vapor barrier may be applied over the foundation to prevent excessive condensation in the shed. Follow local building codes for a proper vapor barrier.
  - The ground should slope away from the foundation area to provide drainage.

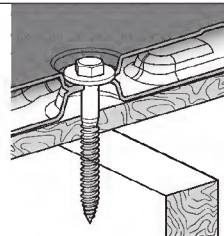

Anchor section example

### Anchoring the floor panels to foundation is required after assembly is complete.

- Shed floor panels include flattened areas where anchors or lag screws are to be secured. These flat areas must be drilled through prior to securing the floor panels to the foundation.

#### Concrete Slab

- Secure shed to concrete slab using 3/8" masonry anchors with 1" washers. Masonry anchors and 1" washers are available at most local hardware retailers. **8 masonry anchors are required for this model**

#### Wood Platform

- Secure shed to wood platform using 1/4" - 3/8" x 3" lag screws with 1" washers. Lag screws and 1" washers are available at most local hardware retailers. **8 lag screws are required for this model.**

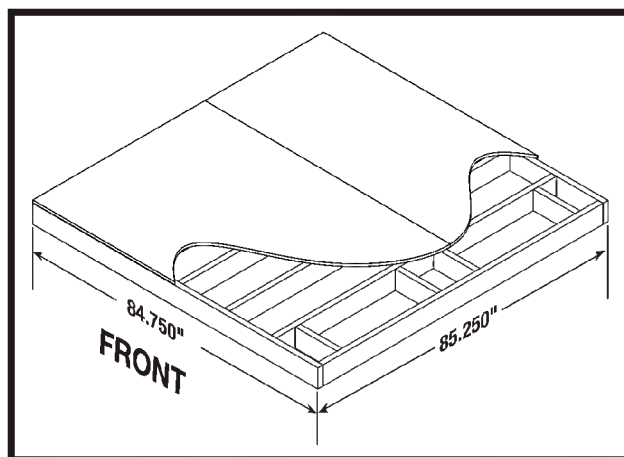
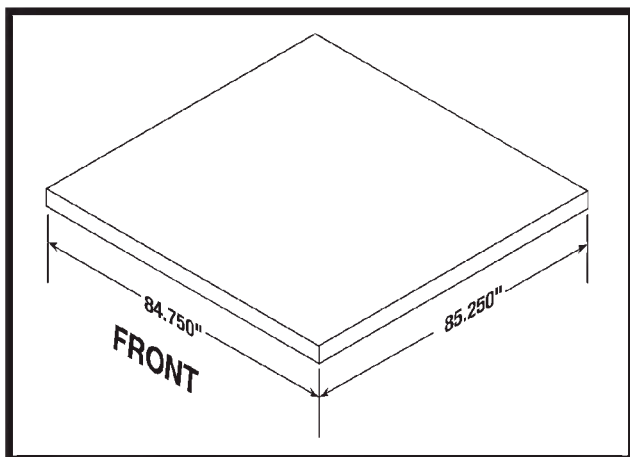

**Note:** Shed floor fastening locations are designed to align with the under-structure layout. Be sure the front of the base panels are oriented correctly on the platform to ensure lag bolts engage with the under-structure.

\* Dimensions allow for shed to fit within the nearest 1" on each side.

**ULINE** H-11339

1-800-295-5510

Site Preparation and Platform Construction

Materials **NOT** supplied with Shed Kit

Wood platform critical spacing

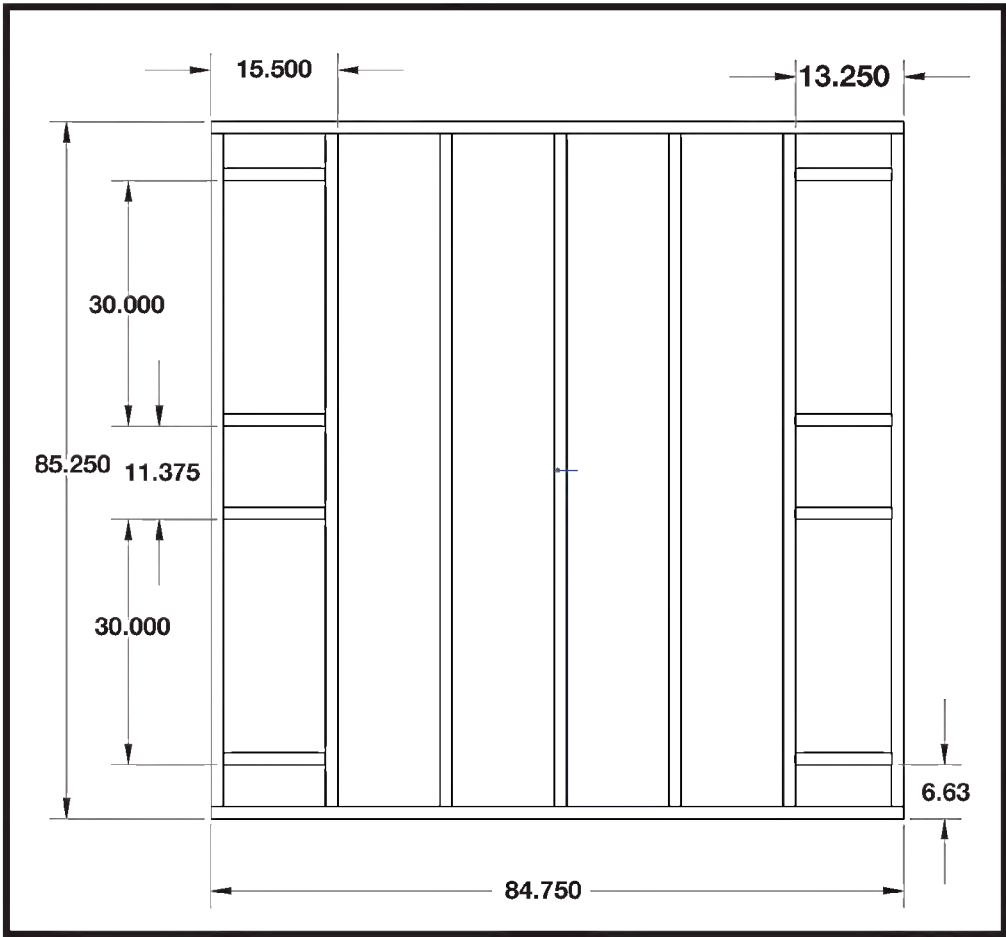

- Check all critical spacing measurements.

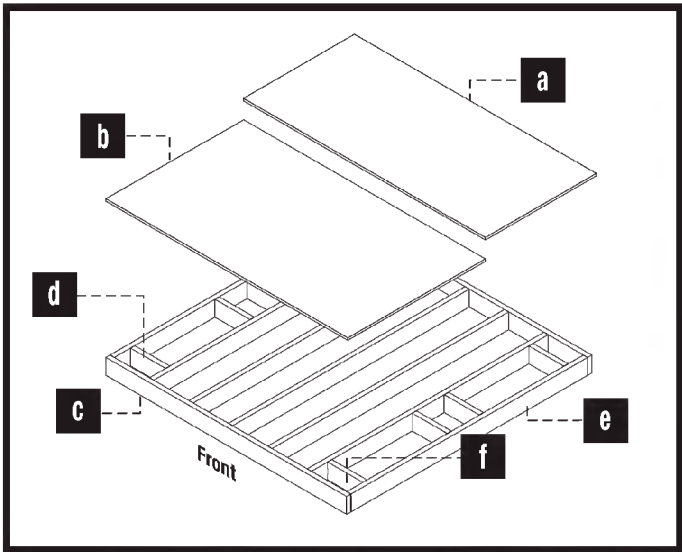

Wood platform materials list

Item	Qty	Size
a	1	37.25" x 84.75" x .75"
b	1	48" x 84.75" x .75"
c	2	2" x 6" x 84.75"
d	4	2" x 6" x 12.5"
e	7	2" x 6" x 82.25"
f	4	2" x 6" x 11.75"

- Please note-dimensional lumber is actually 1/2" smaller than noted sizes.

## Pre-Assembly

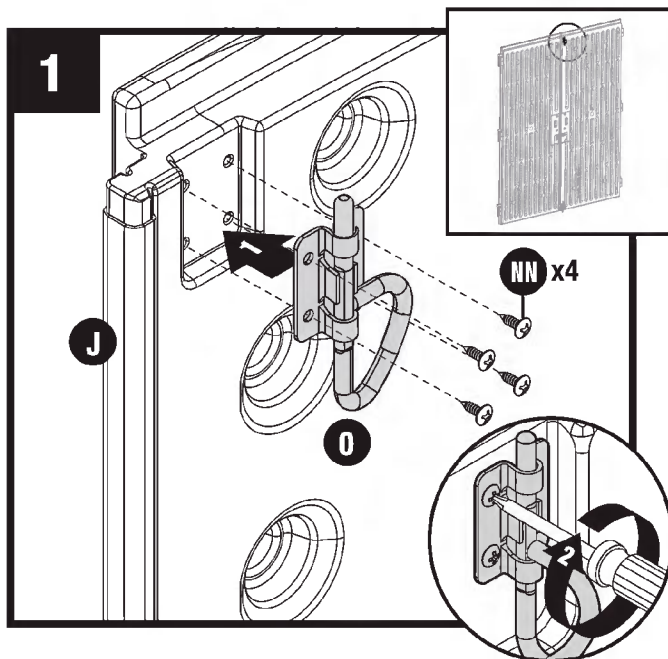

At top interior side of left door (J), attach D-ring slide bolt (O) with 4 screws (NN) through provided holes.

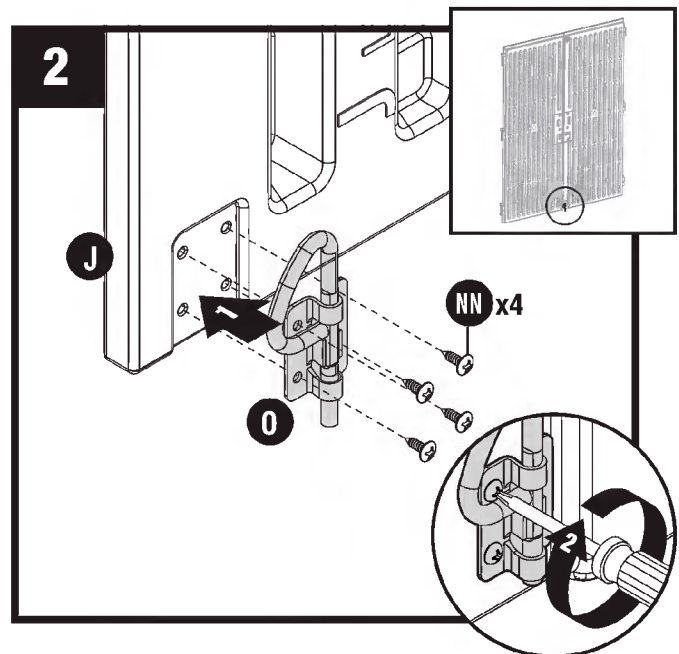

At bottom interior side of left door (J), attach D-ring slide bolt (O) with 4 screws (NN) through provided holes.

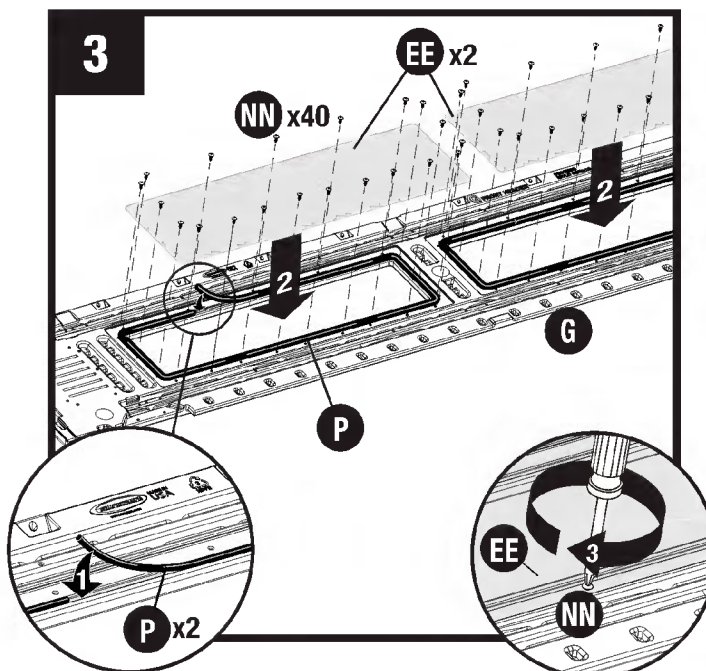

Place front header (G) on flat surface, facing down. Insert 1 gasket (P) into the groove around each window opening. Lay 1 window pane (EE) over each window opening. Secure window panes with 40 screws (NN).

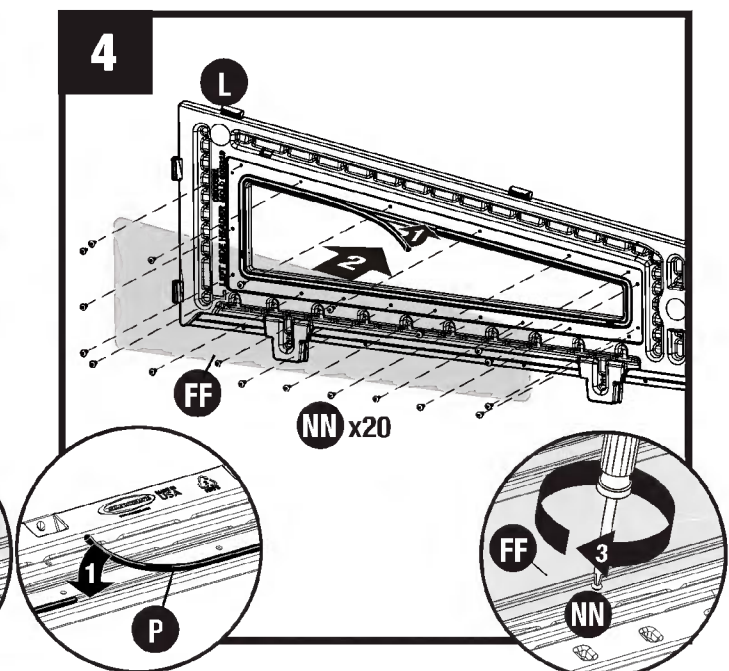

Place left side header (L) on flat surface facing down. Insert 1 gasket (P) into groove around window opening. Place side window pane (FF) over window opening. Secure window pane with 20 screws (NN). Repeat for right side header (M).

**ULINE** H-11339



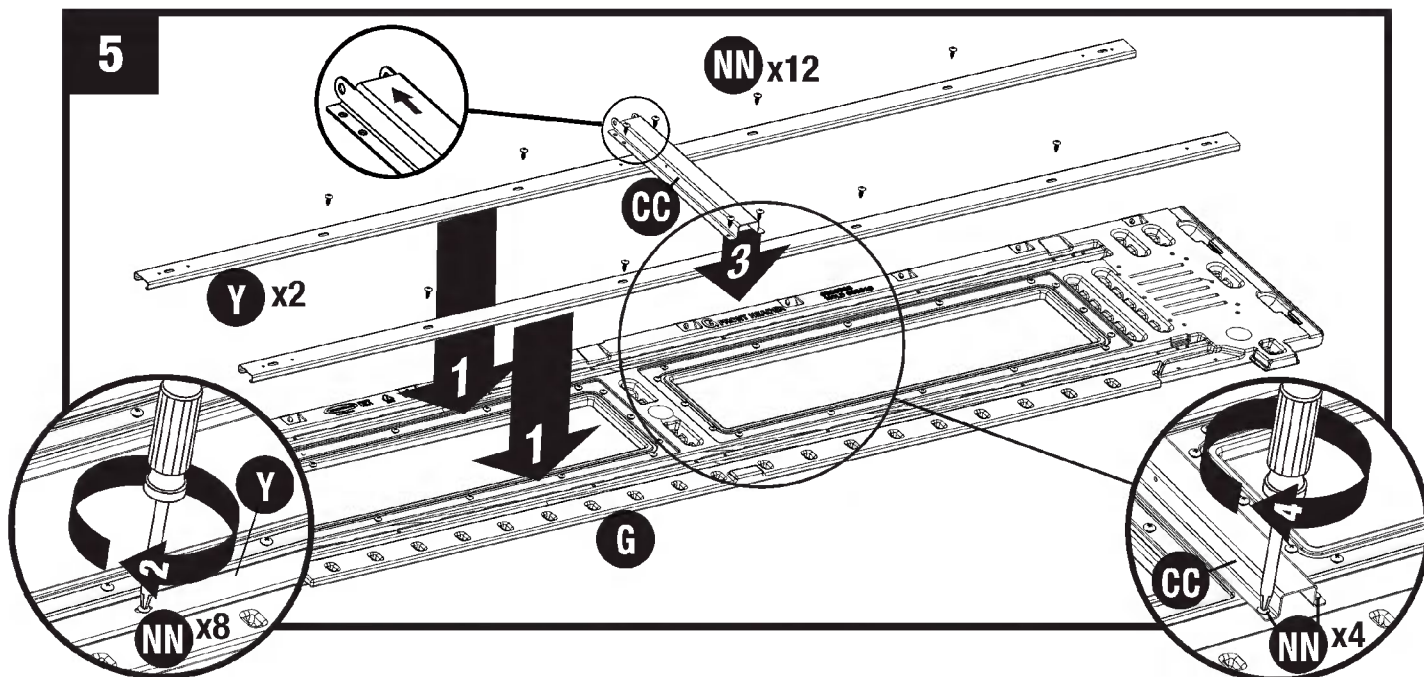

Place front header (G) face down on flat surface. Place 1 header beam (Y) in each channel above and below the window openings. Secure Beams (Y) with 8 screws (NN). Place short side adapter (CC) between windows with the flat bottom end facing down. Secure adapter (CC) with 4 screws (NN).

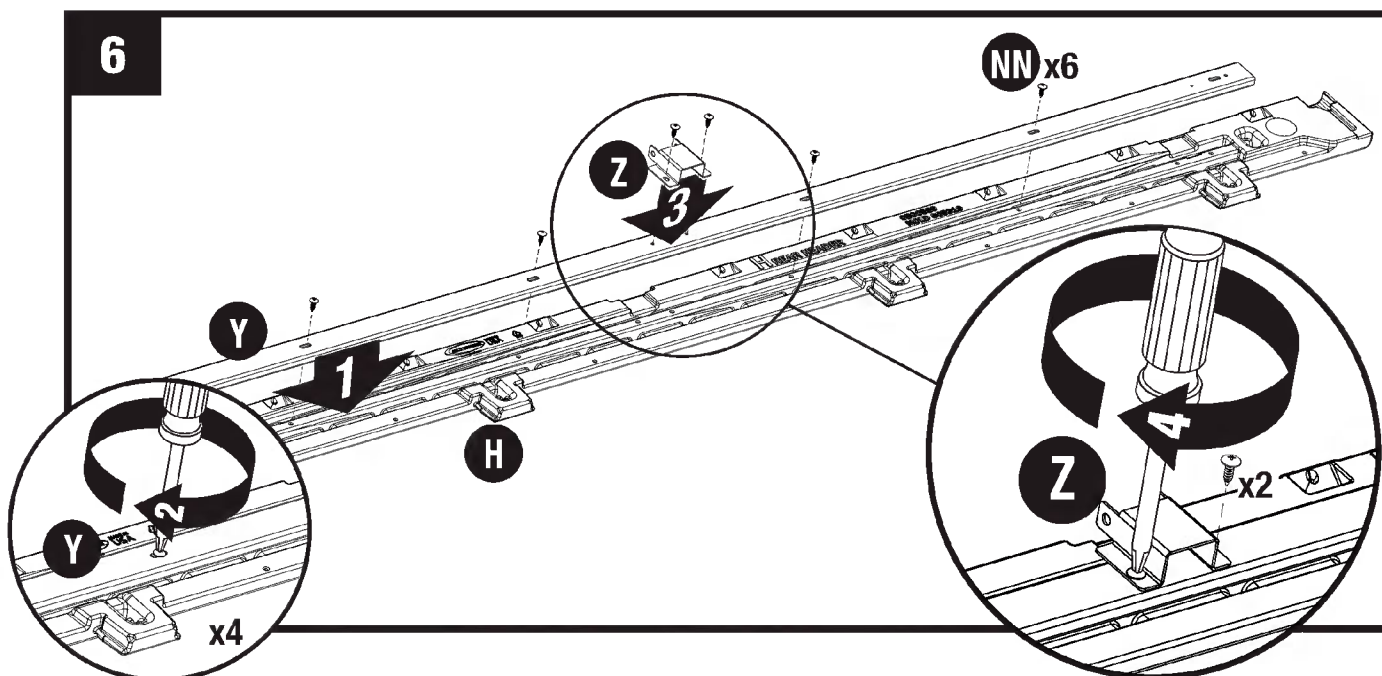

Place rear header (H) face down on flat surface. Place remaining header beam (Y) in channel on back of header. Secure beam (Y) with 4 screws (NN). Place support bracket (Z) at center of beam with the flat bottom end facing down. Secure bracket (Z) with 2 screws (NN).

# Assembly

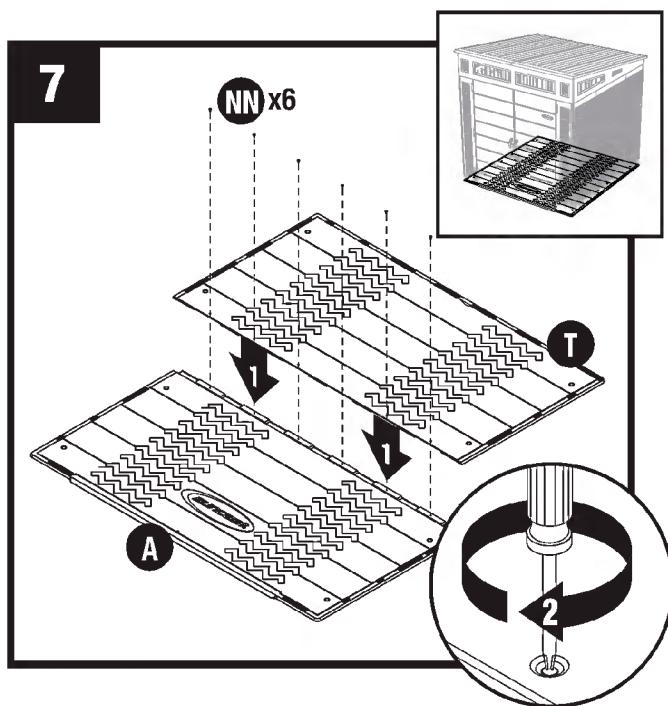

Push front floor (A) and rear floor (T) together and secure with 6 screws (NN).

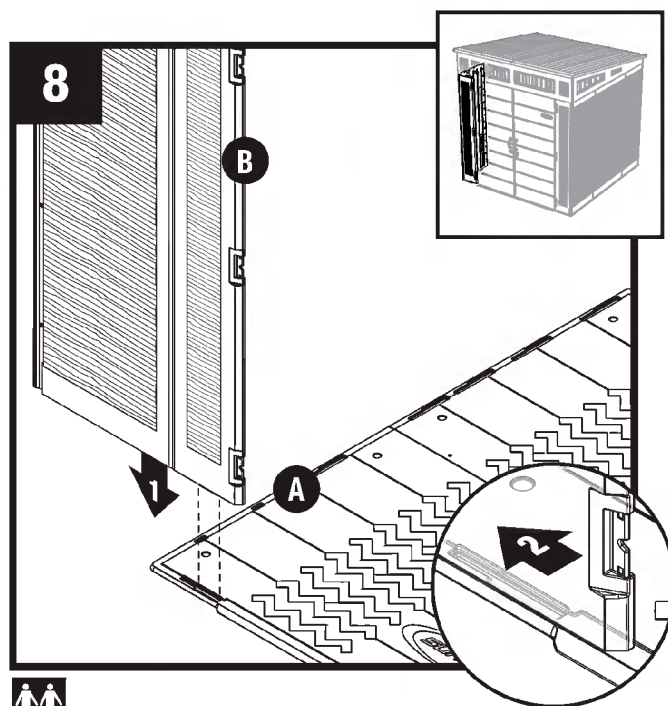

Align tab on bottom right side of left front corner (B) with slot on front floor (A). Lower panel into slot and lock in place by sliding panel toward outside of floor.



**Note:** Use a rubber mallet to “push” left front corner (B) into locked position.

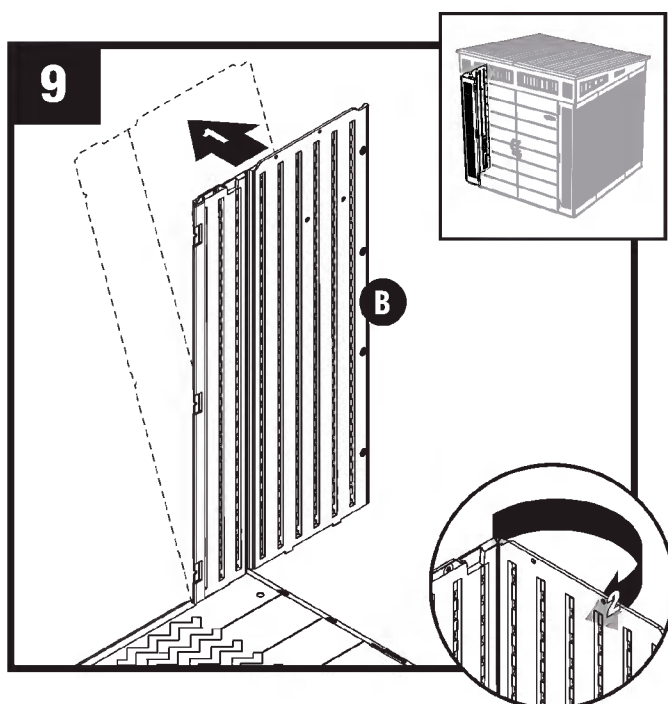

Tip left front corner (B) outward slightly and bend corner hinge.

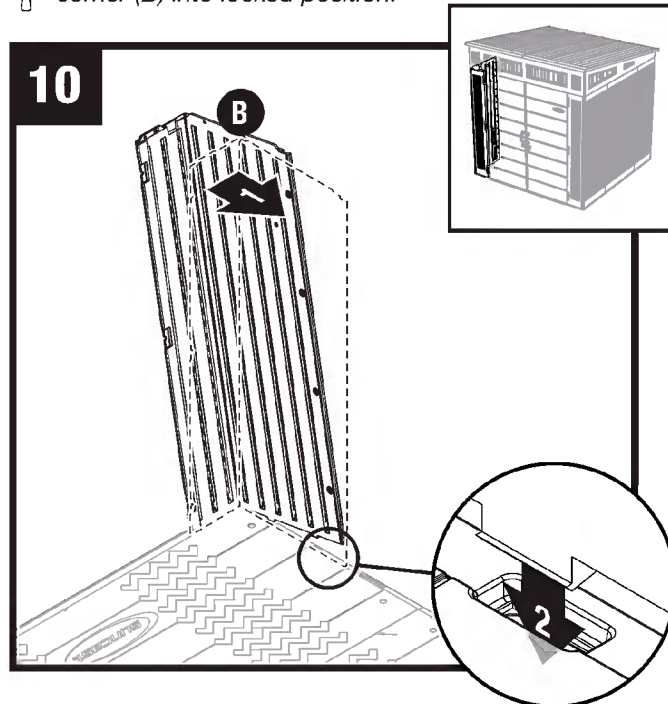

Tip left front corner (B) back to vertical position and align lower tabs on right side with slots in floor.

**Note:** You will hear a snap when tab is fully engaged.

**ULINE** H-11339



# 11

Before proceeding, make sure corner is square (top view) where it meets the floor and that panel is flush (side view) with floor.

If not, repeat Steps 9-10 until square and flush.

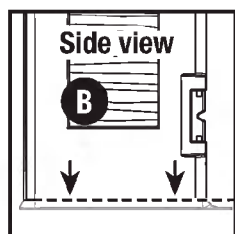
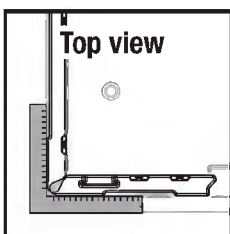

# 12

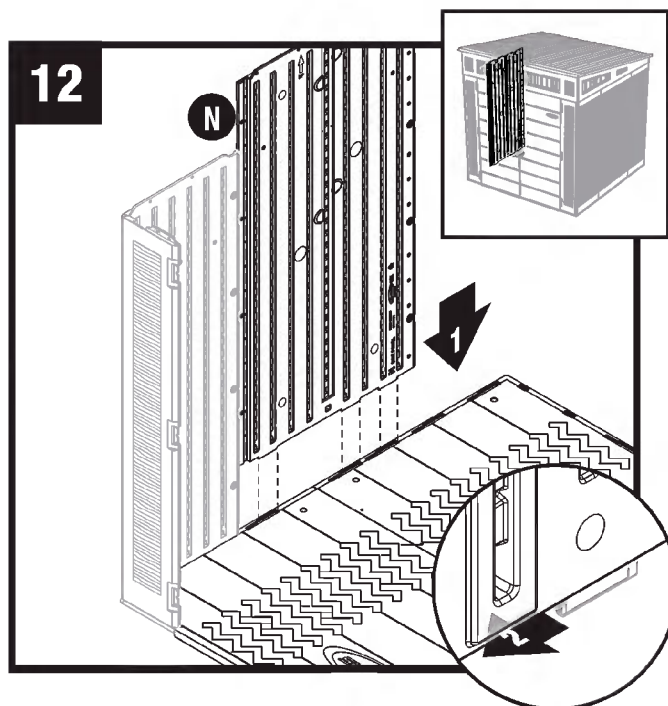

Align tabs on bottom of side panel (N) with slots along front and rear floors. Lower panel into slots and lock in place by sliding panel toward front corner.

**Note:** Use a rubber mallet to “push” side panel (N) into locked position.

# 13

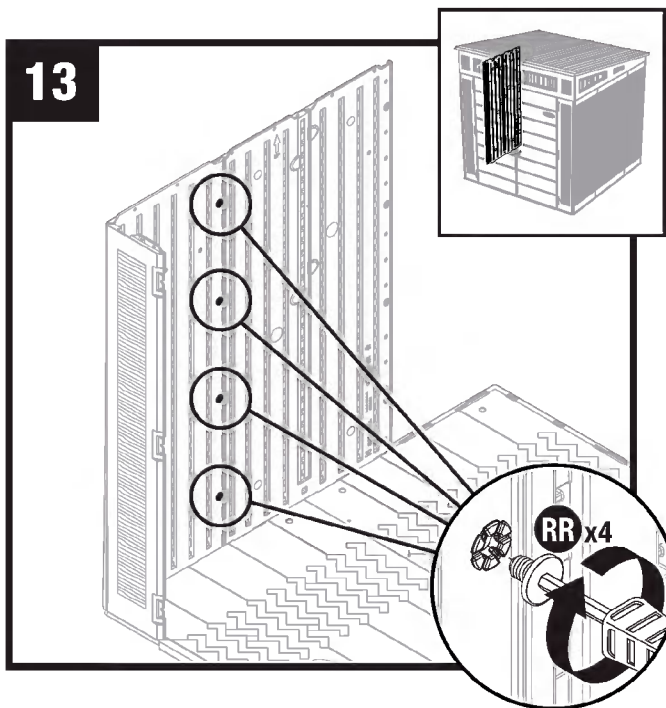

Secure side panel with 4 easy bolts (RR), working from floor to roof.

14

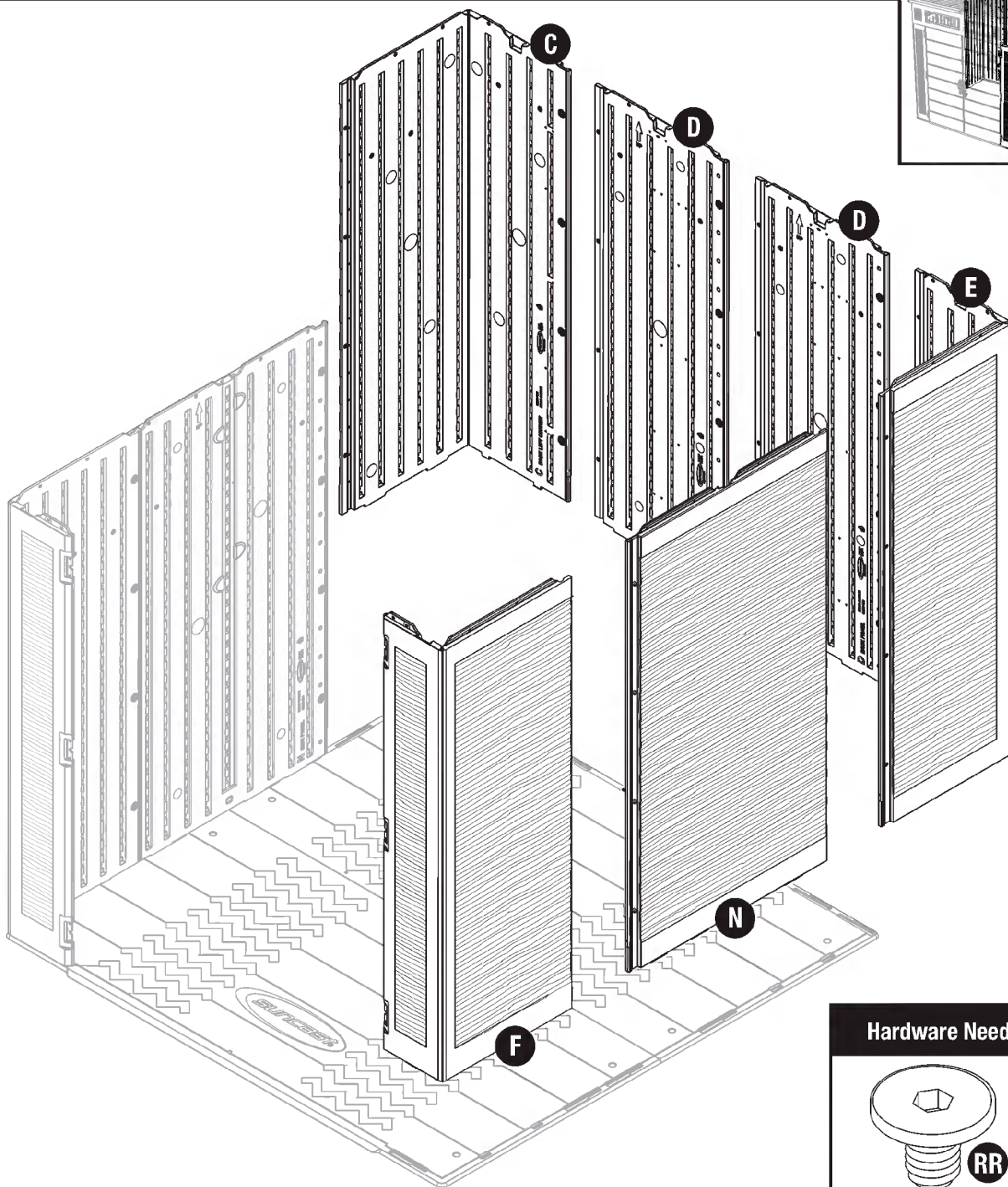

Hardware Needed



Repeat steps 8-13 for remaining panels.

**ULINE** H-11339

1-800-295-5510

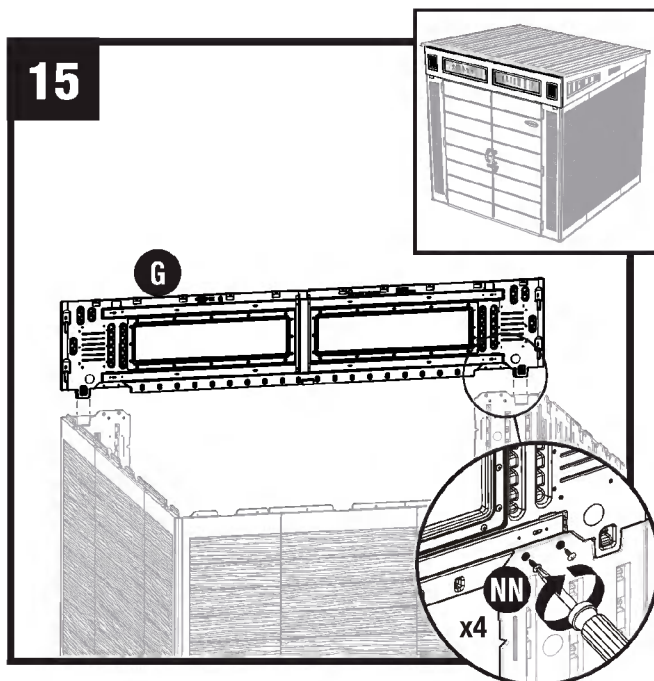

Place front header (G) over door opening and fit two protruding support tabs into pockets in front corners. Secure front header with 4 screws (NN).

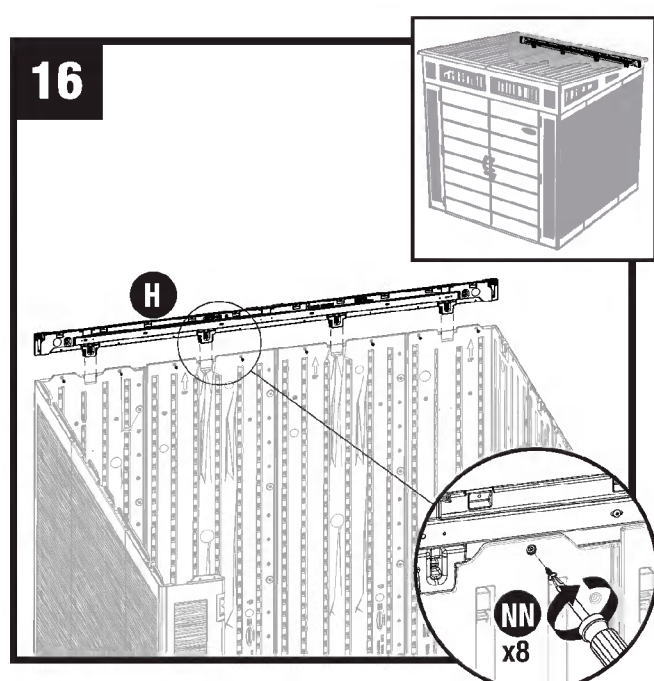

Place rear header (H) over back wall and fit the four protruding tabs into pockets provided in wall. Secure rear header with 8 screws (NN).

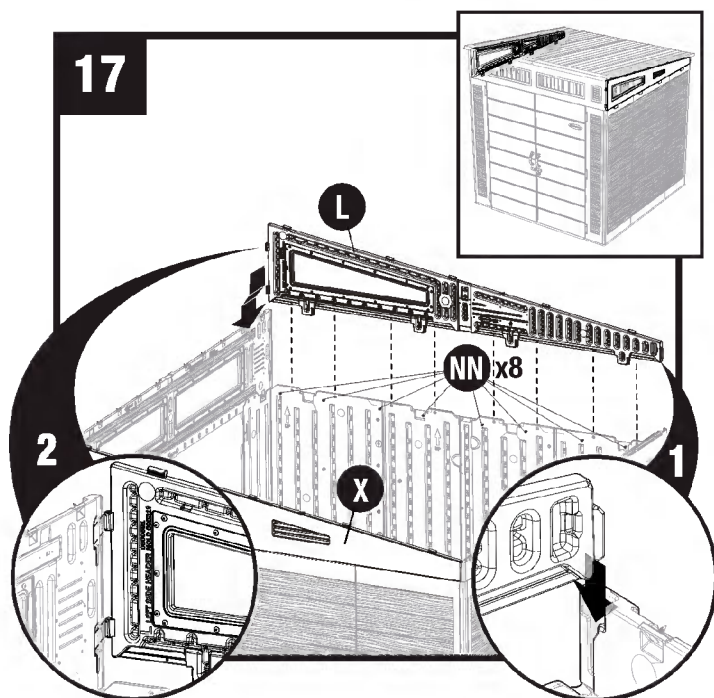

**TIP:** Have a second person hold wall from inside

Place left side header (L) over left side walls.

Insert the protrusion at the rear corner into the slot in the rear header and press down on the side header to secure in position. Insert the two protrusions at the front of the side header into the slots provided on the end of the front header and press down into slots. Fasten the side header with 8 screws (NN).

Repeat for right side header (M).



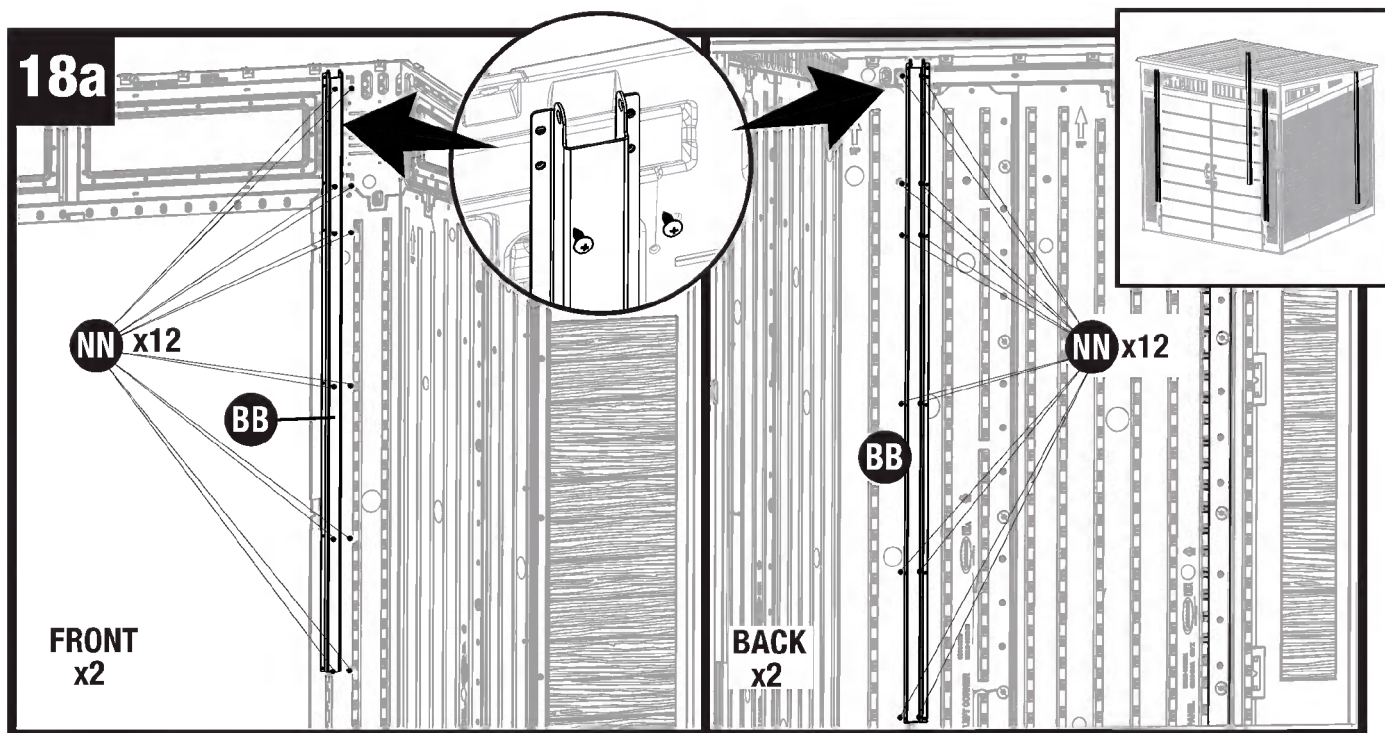

Place one side adapter (BB) in position on right side of interior door opening. Secure with 12 screws (NN). Place 1 side adapter (BB) in position on back corner. Secure with 12 screws (NN).

**Note:** Critical Orientation of bracket is shown and used in next steps. Repeat steps with the remaining 2 side adapters (BB) on left side of the shed.

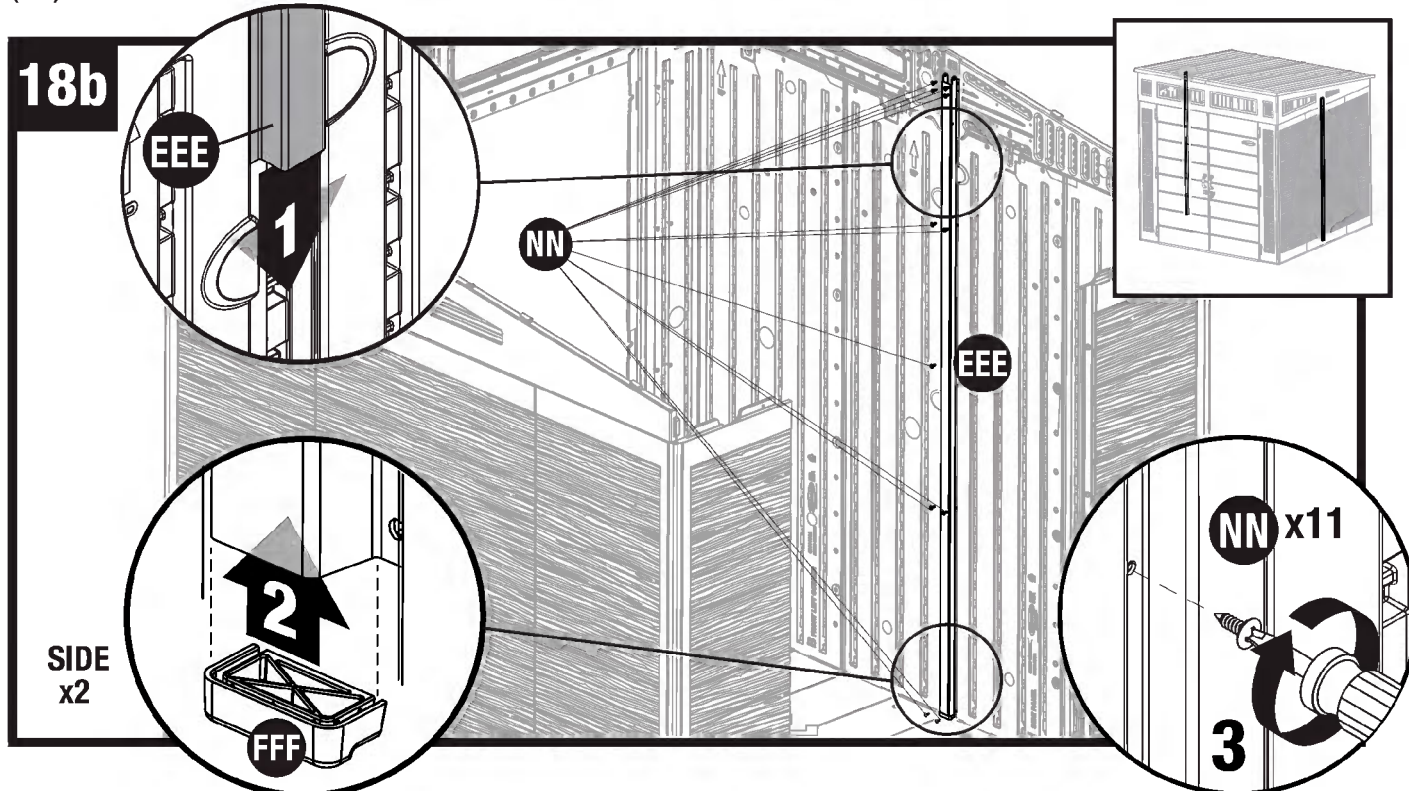

Attach 1 side adapter (EEE) to right side wall by sliding it in place from above. Raise side adapter slightly to press 1 adapter cap (FFF) to the bottom of the side adapter. The capped side adapter should rest on the floor. Secure with 11 screws (NN). Repeat steps with the remaining side adapter (EEE) and cap (FFF) on left side of the shed.

19

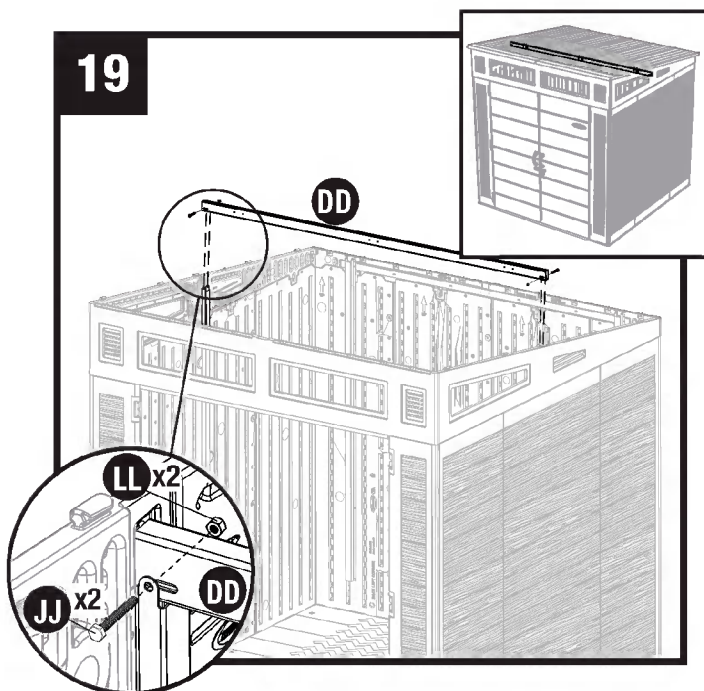

Place ridge beam (DD) into top of the two wall mounted side adapters. Secure with 1 bolt (JJ) and nut (LL) at each end of the ridge beam.

20

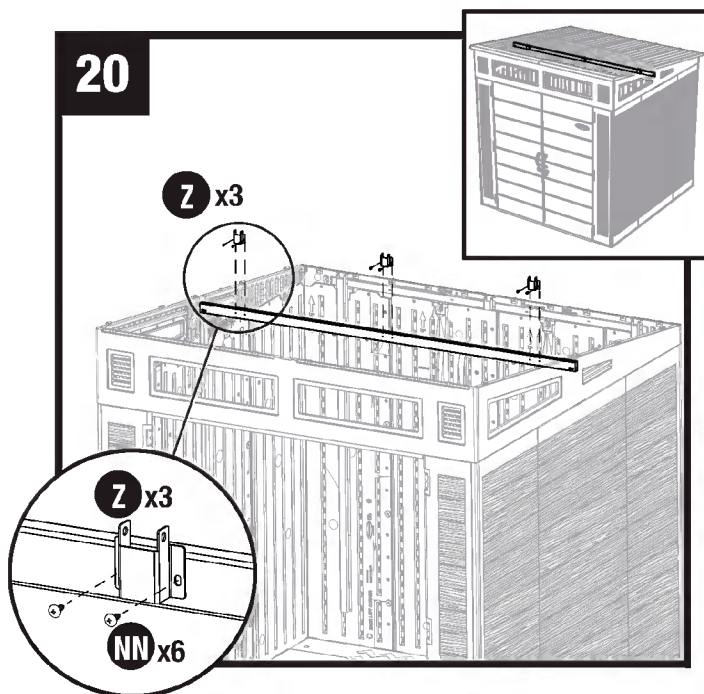

Attach 3 support brackets (Z) to the front of the ridge beam (DD) using 2 screws (NN) each.

# 21

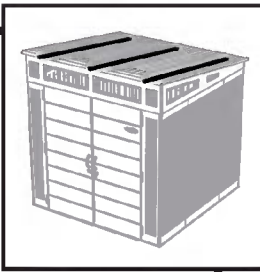

Place 1 truss leg (AA) over the side adapters and support bracket on the back wall, ridge beam, and the front header. Secure into the three brackets with 1 bolt (JJ) and nut (LL) each.

Repeat for the remaining 2 truss legs (AA).

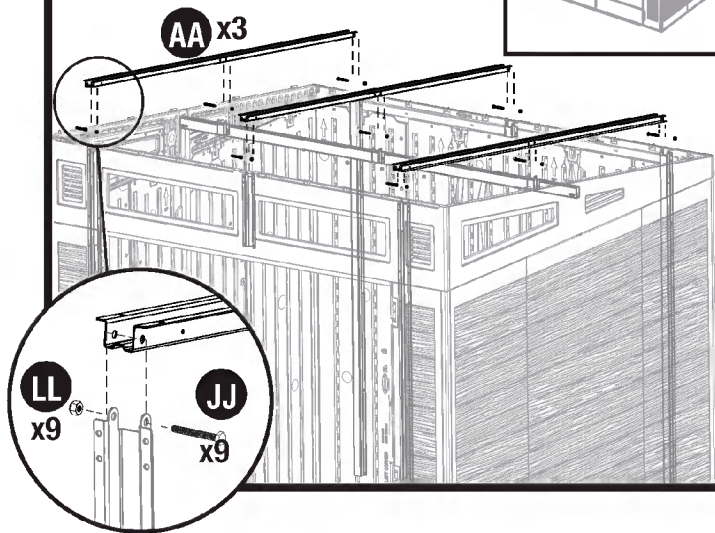

# 22

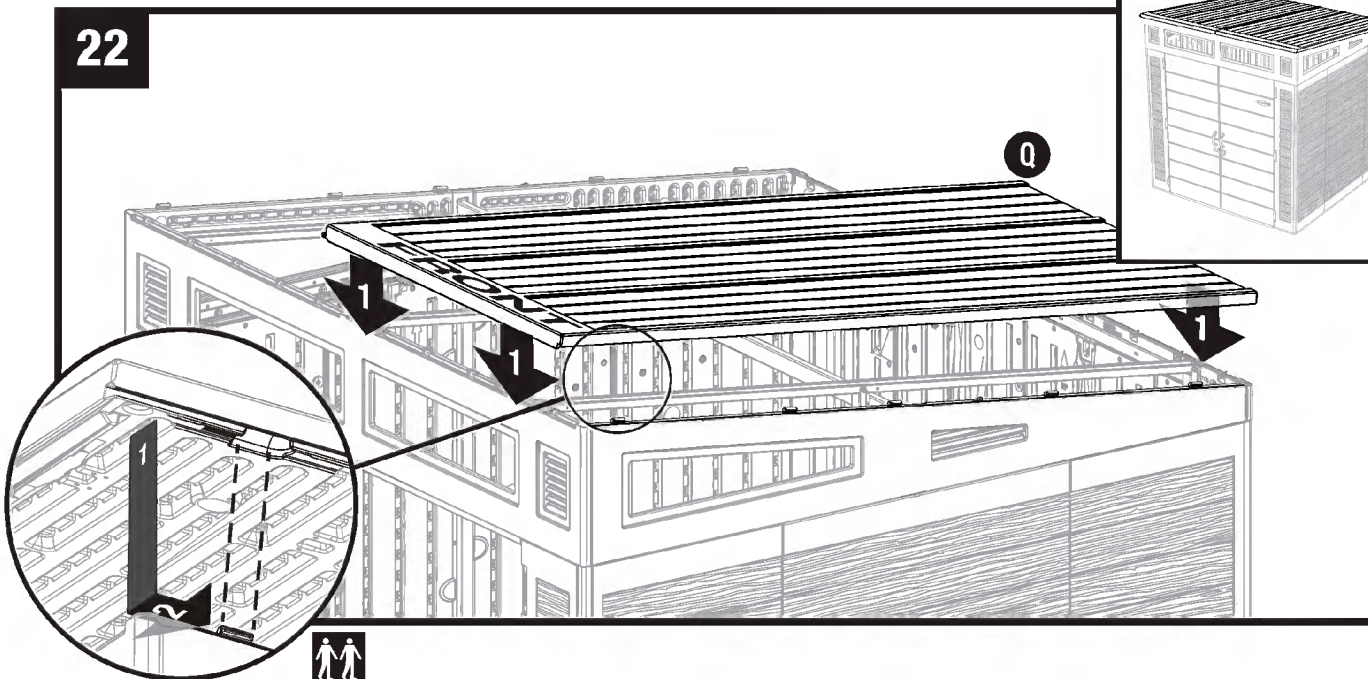

Line up 1 roof panel (Q) with the right side header so the tabs on the header align with the five slots in the roof panel. Once the roof is engaged, slide the roof toward the back wall to fully engage.

**Note:** The wide band on the roof faces front.

**ULINE** H-11339

1-800-295-5510



**23**

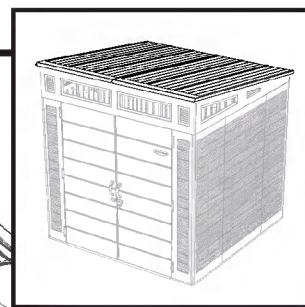
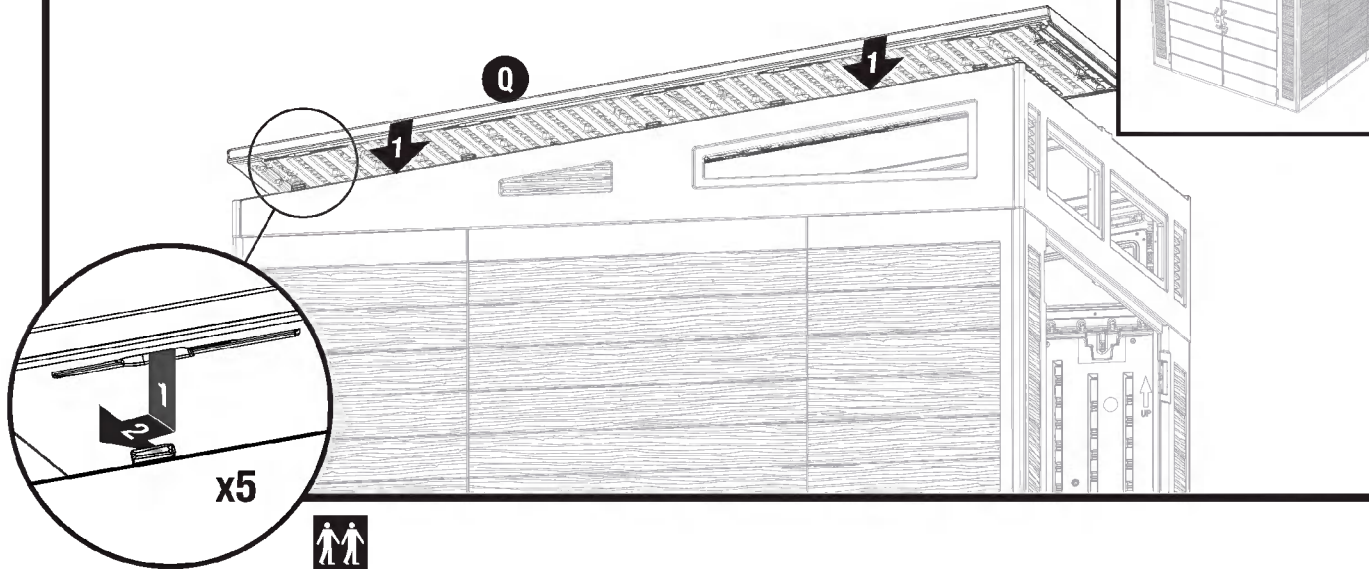

Repeat step 22 to install remaining roof (Q) on the left side of the shed.

**24**

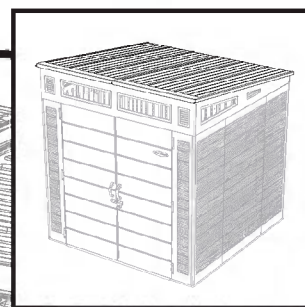
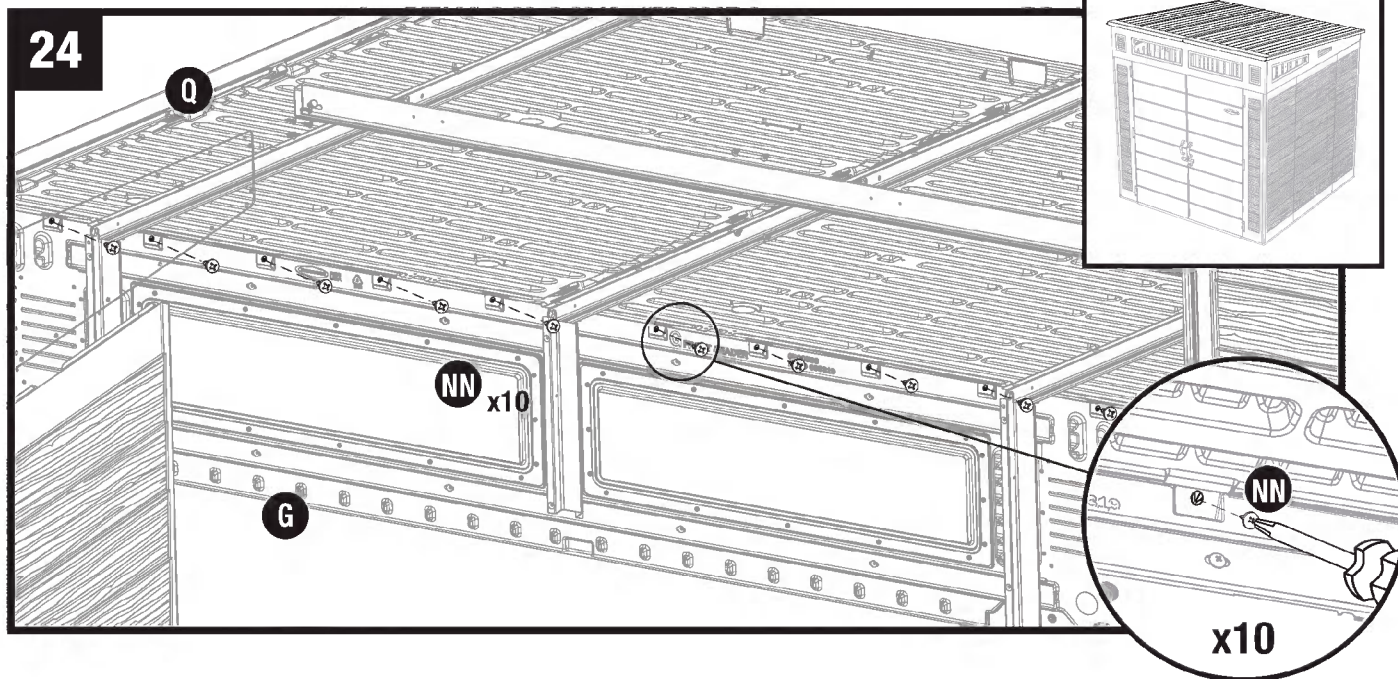

Secure roof panels (Q) to the top of the front header (G) using 10 screws (NN).



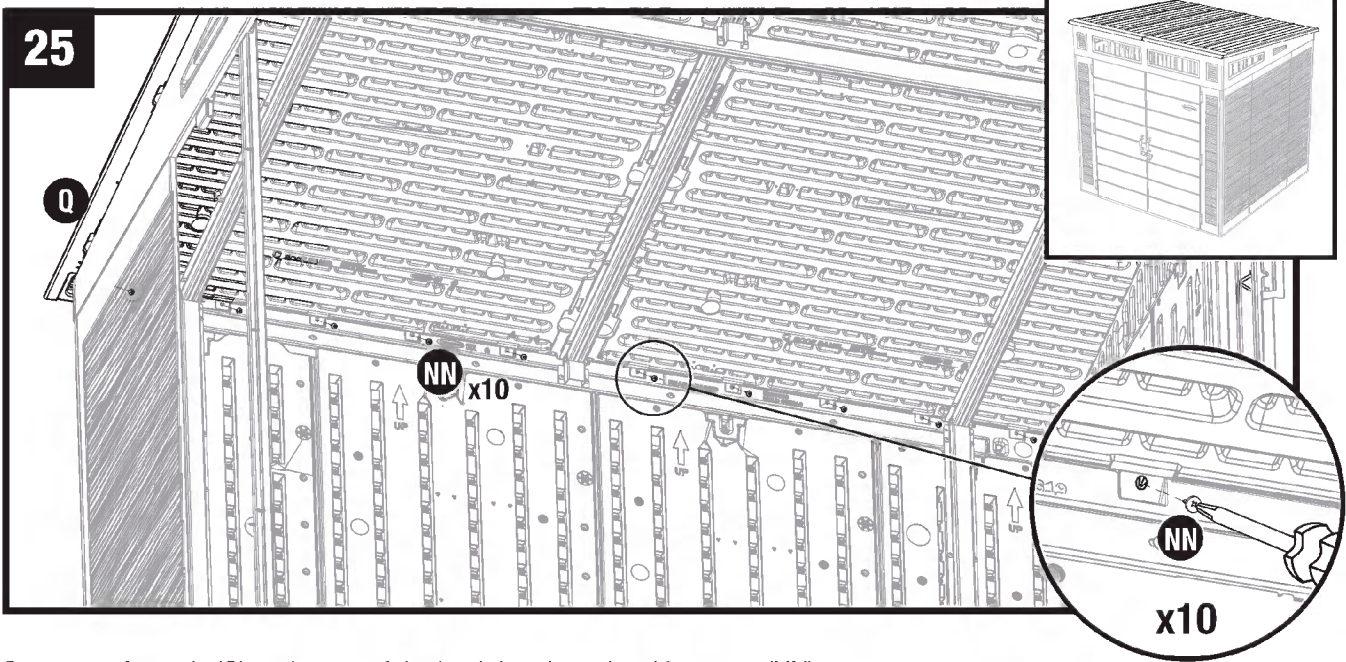

Secure roof panels (Q) to the top of the back header using 10 screws (NN).

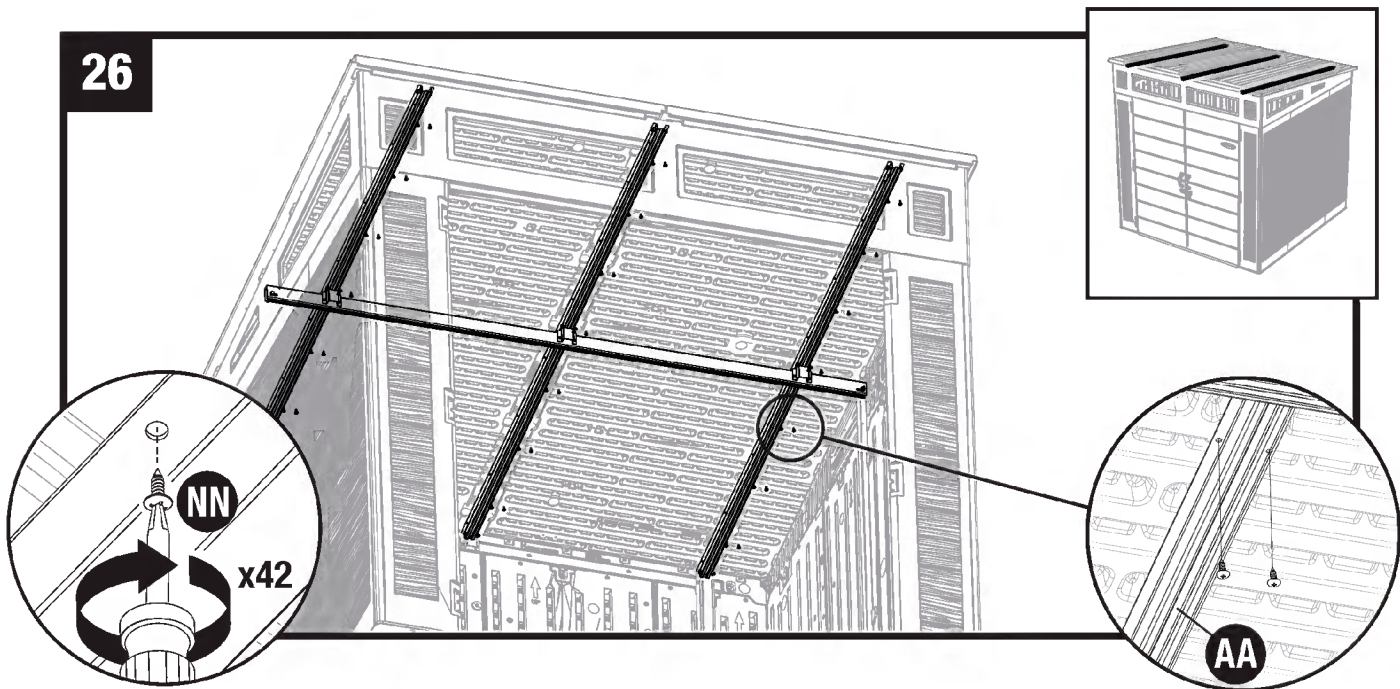

Secure truss legs (AA) to roof with 16 screws (NN) each.

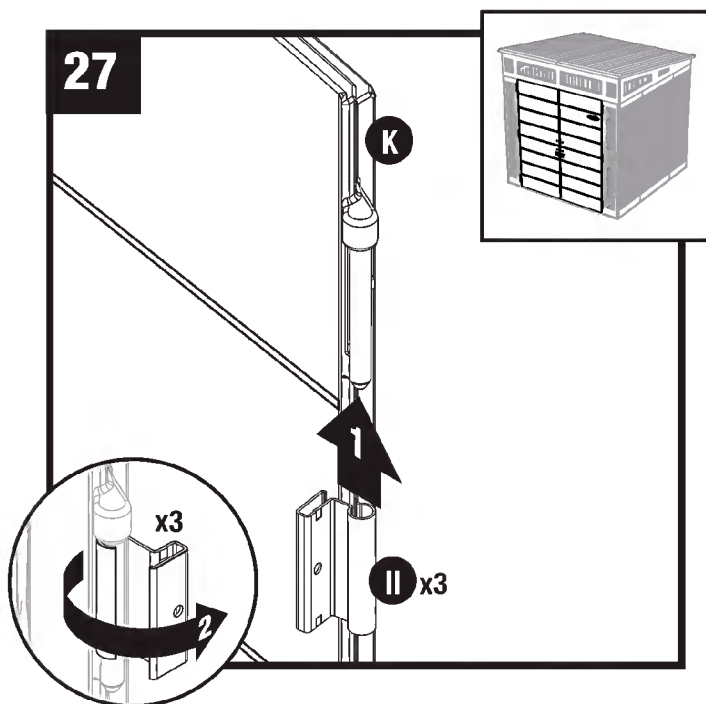

Stand right door (K) upright as shown. Slide 1 door hinge (II) onto each hinge mount. Rotate hinges to outside of door.

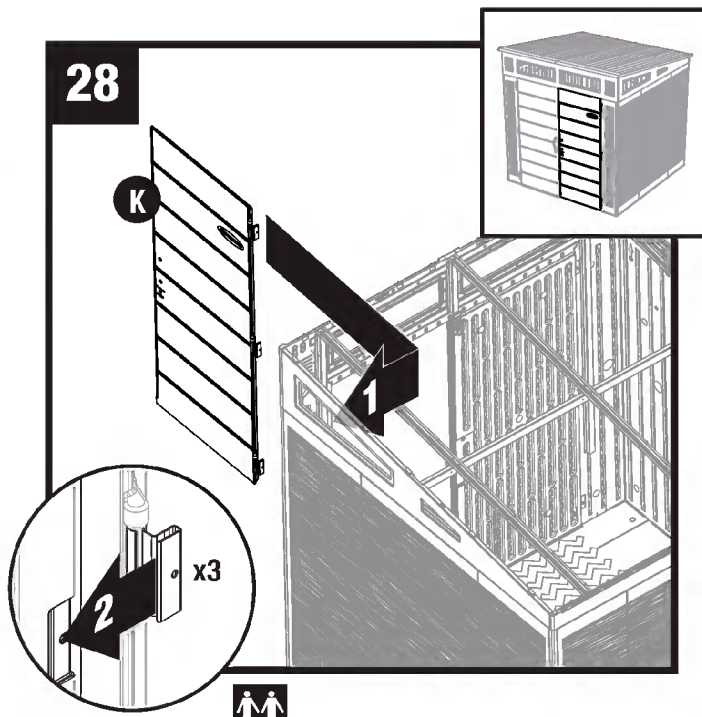

With door hinges orientated as shown, slide 1 hinge over each hinge receptacle on inside of right front panel.



**Note:** Use a rubber mallet if necessary.

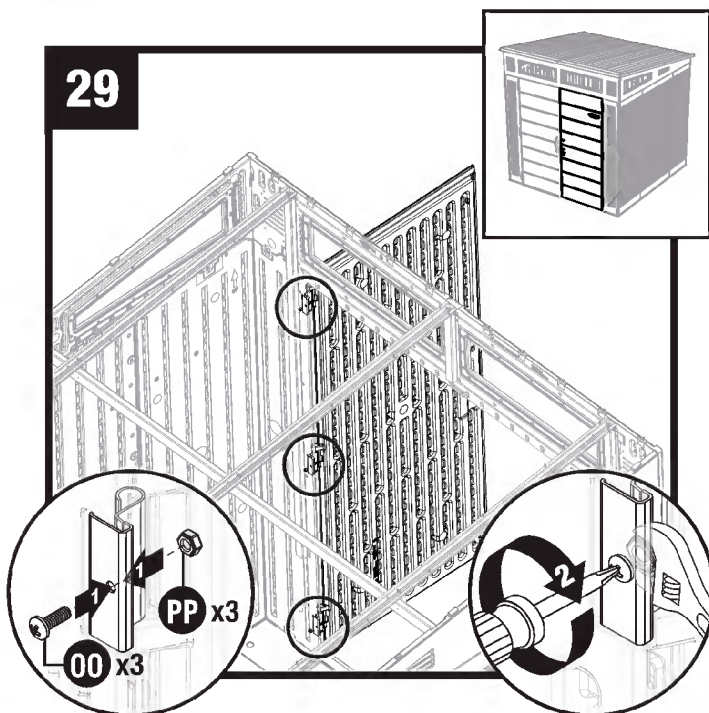

Secure each metal hinge plate with 1 screw (OO) and locking nut (PP).

Repeat steps 27-28 for left door (J).

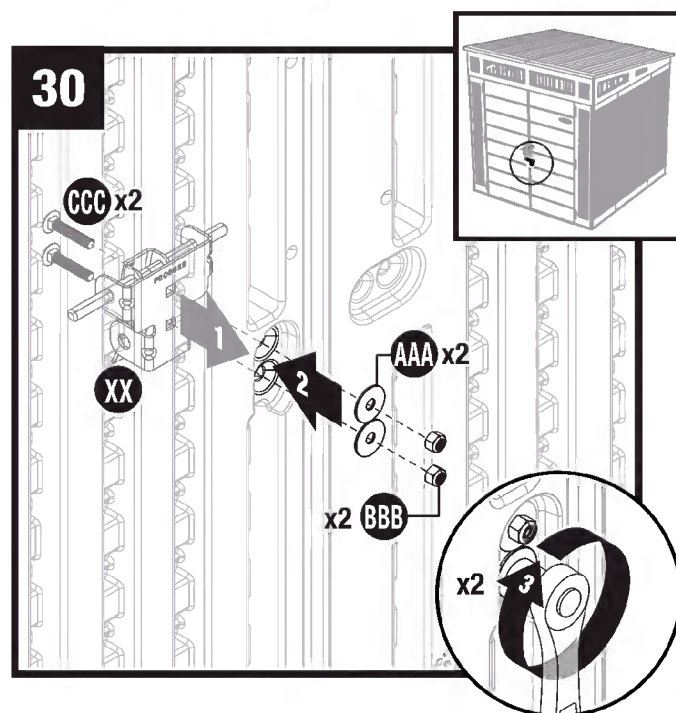

Insert 2 screws (CCC) into right latch plate (XX) and through right door. While holding plate in place, secure screws with 2 washers (AAA) and locking nuts (BBB).



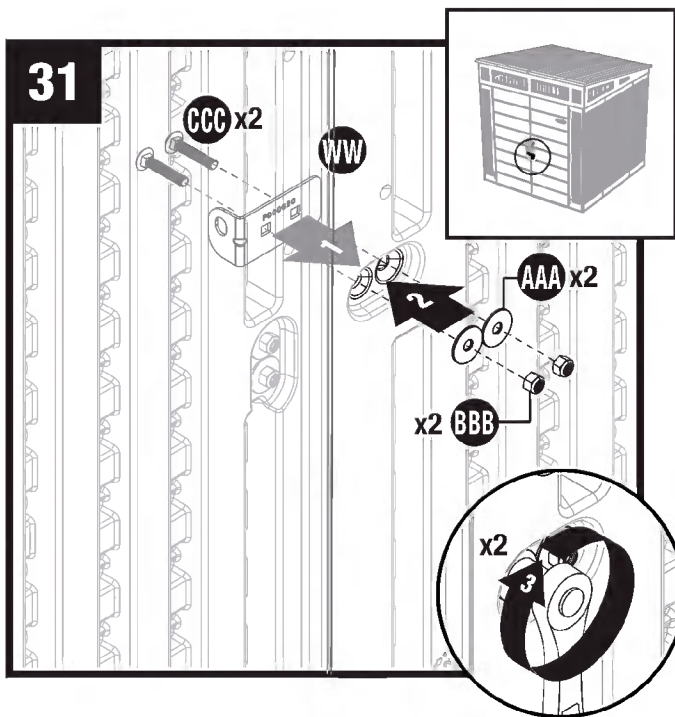

Insert 2 screws (CCC) into left latch plate (WW) and through left door. While holding plate in place, secure each screw with 2 washers (AAA) and locking nuts (BBB).

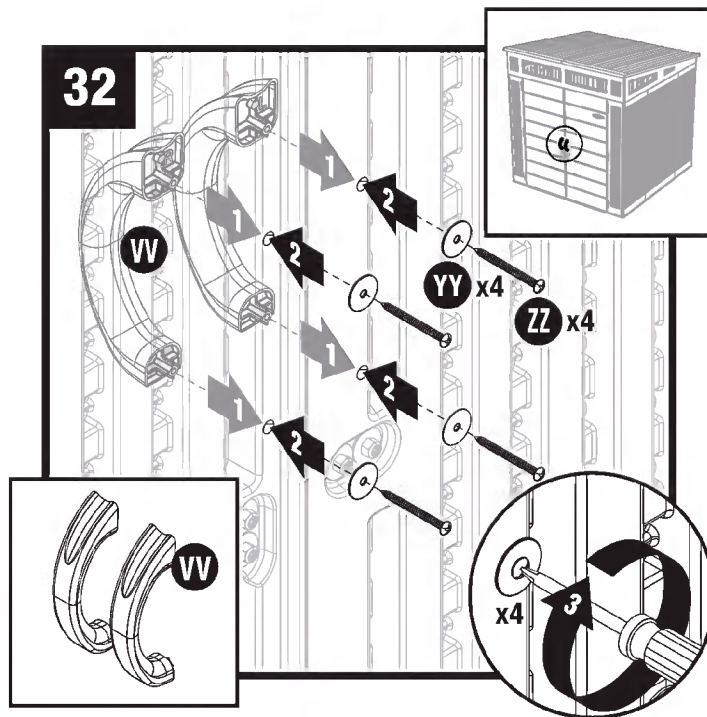

From the outside of doors, insert door handle (VV) stems into holes of left and right doors. On inside of doors, place washers (YY) on each door handle stem, and secure each with 1 screw (ZZ).

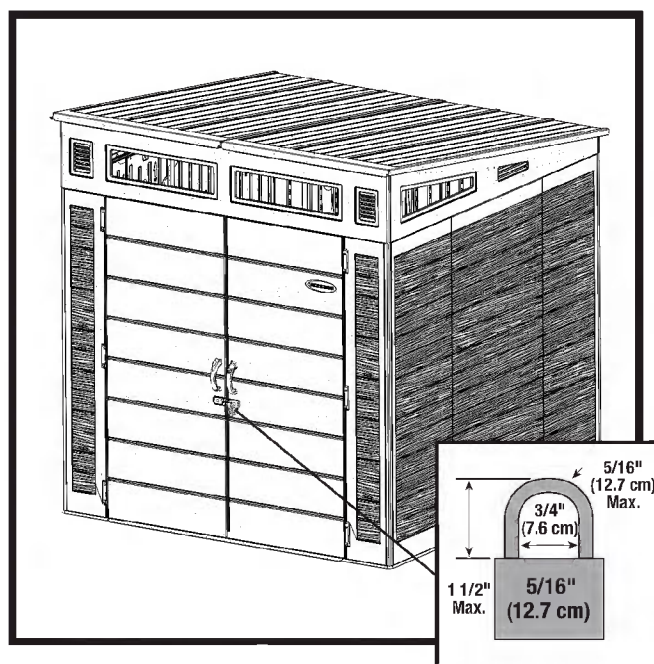

Attach a 5/16" lock (not provided) to door latch, to properly secure shed.

**Note:** To maintain warranty coverage, the product should be locked at all times when not in use.