



H-12811, H-12812
H-12813, H-12814

1-800-295-5510
uline.com

ACCENTRA® DOOR LOCKSET

MEDIUM DUTY

TOOLS NEEDED

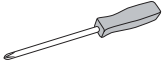

#2 Phillips
Screwdriver



Pin Wrench
(included)

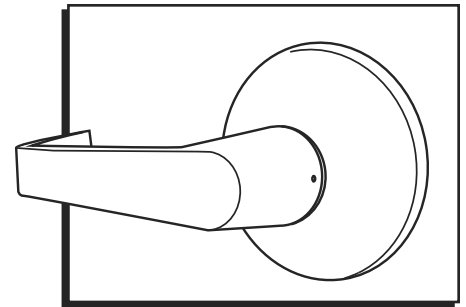

PARTS

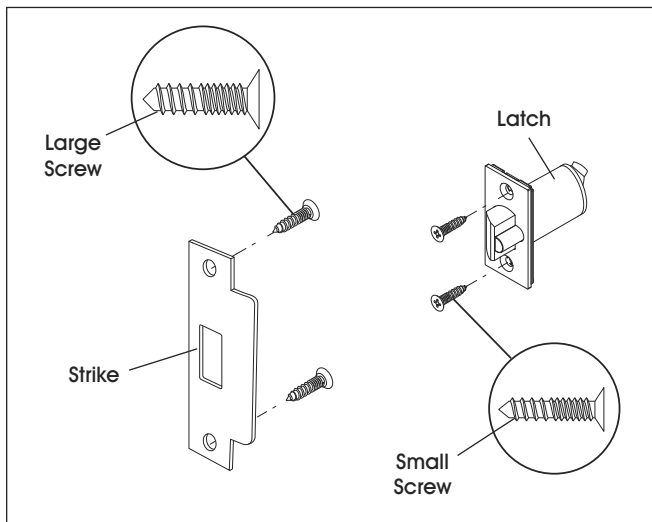
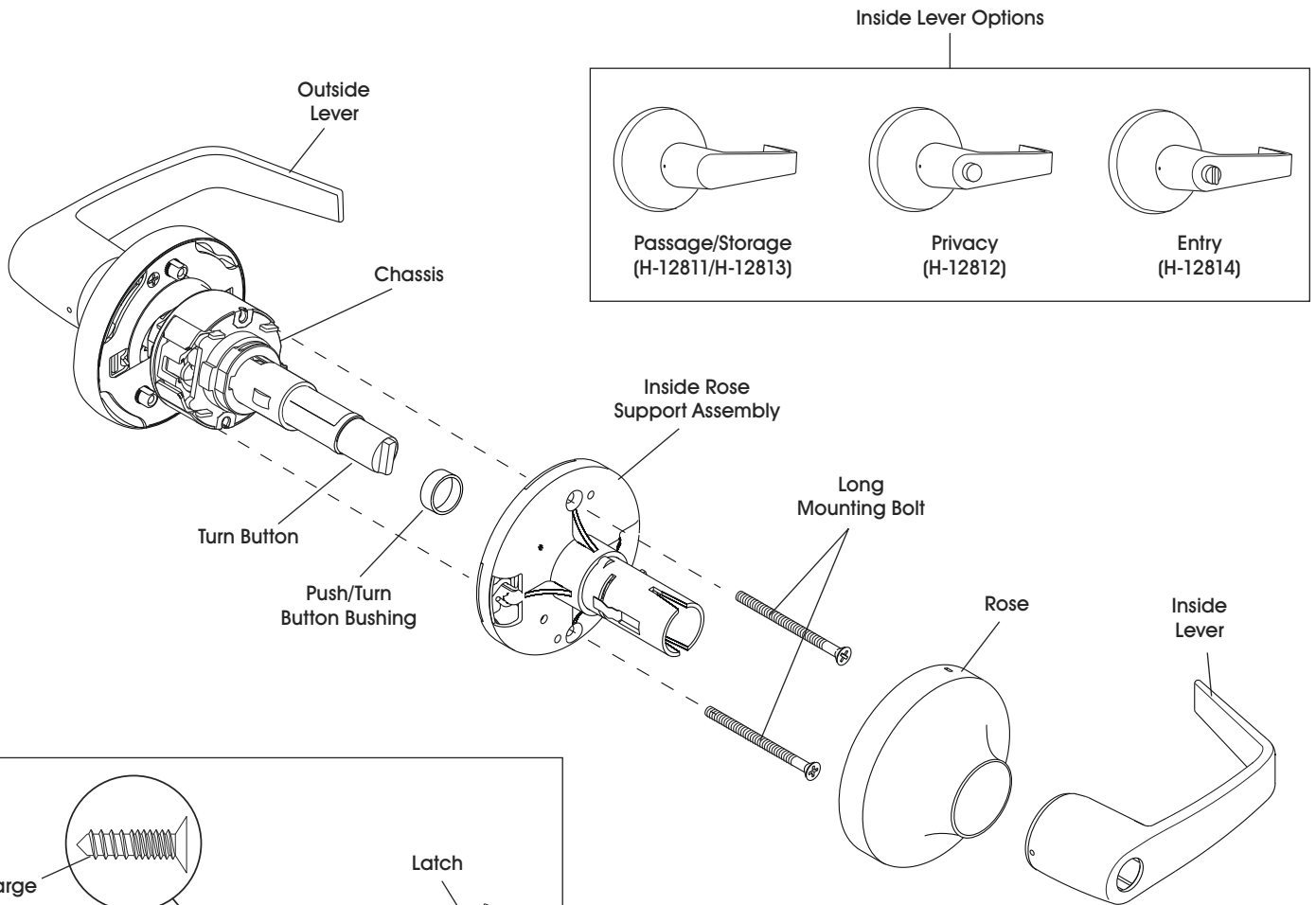

NOTE: Instructions show installation with Uline model # H-12814 entry lever.

INSTALLATION

LATCH INSTALLATION

 **NOTE:** For door preparation, use the template included in the package with the lock.

1. Install latch. The bevel must face toward the door stop. (See Figures 1-2)

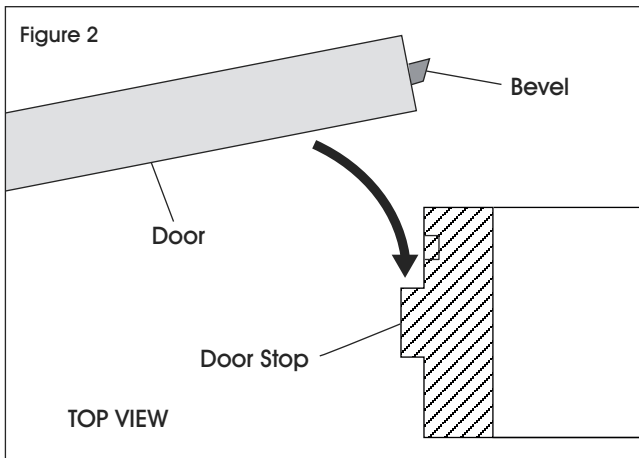
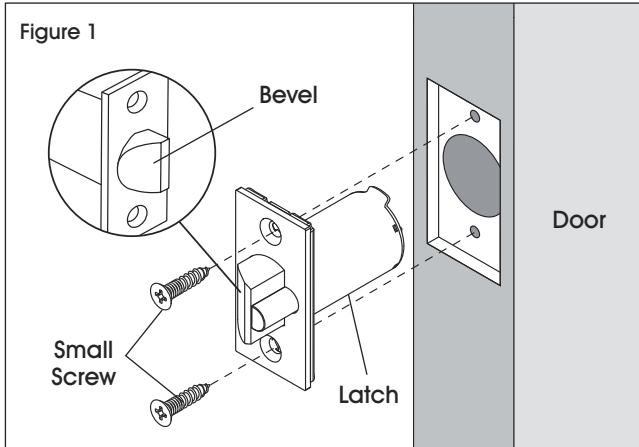

2. Adjust for door thickness as necessary.
 - For 1¾" thick doors: Slide adjustment plate onto inner notch on chassis. See step 3 on page 3.
-  **NOTE:** Lockset comes preset for 1¾" doors.
- For 2" thick doors: Slide adjustment plate onto outer notch on chassis. See step 3 on page 3.

DOOR THICKNESS ADJUSTMENT

1. Using #2 Phillips screwdriver, unscrew screws and lift to separate chassis from outside lever assembly. (See Figures 3-4)

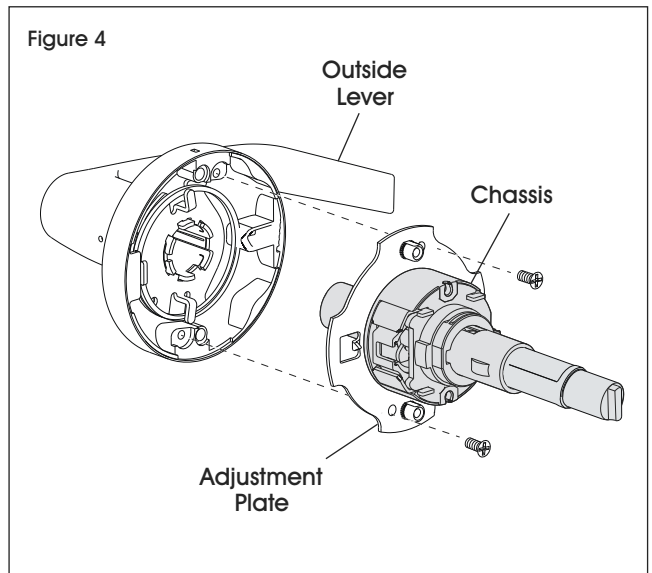
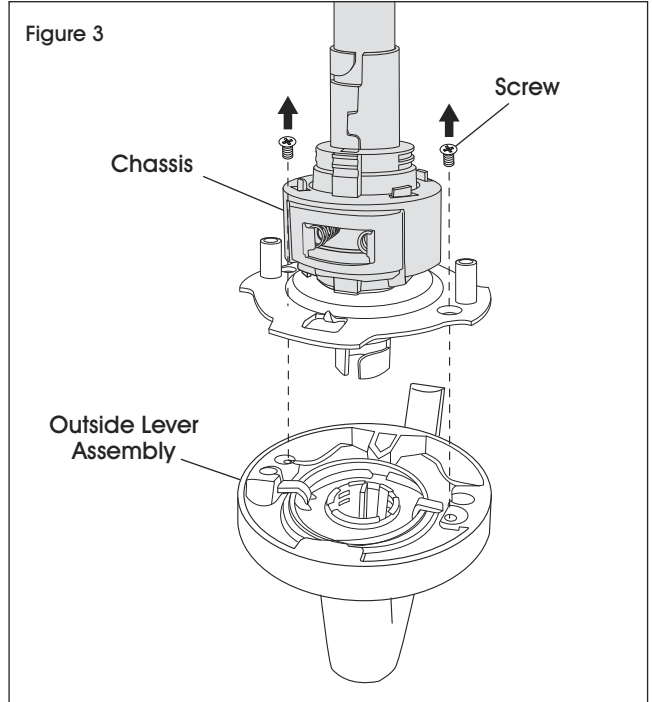

INSTALLATION CONTINUED

- Slide adjustment plate to remove from chassis. (See Figures 5-6)

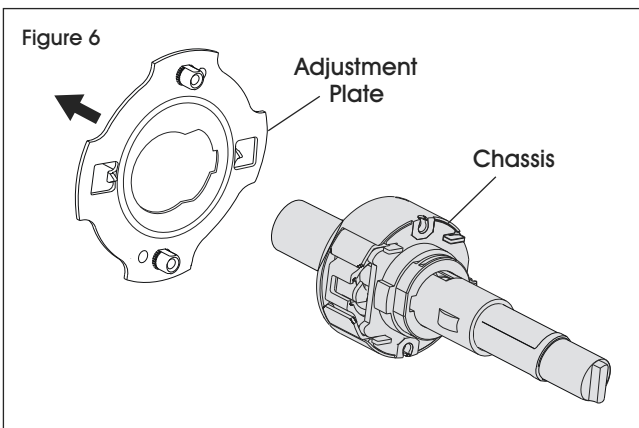
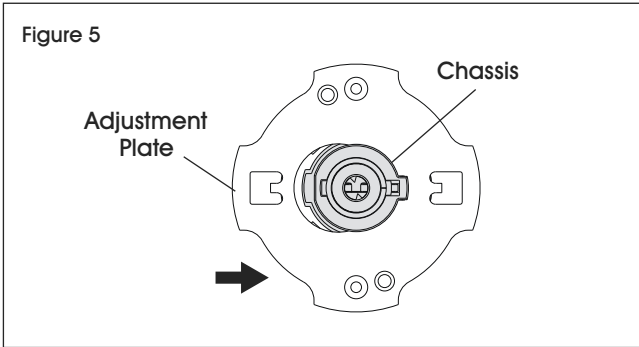

- Slide adjustment plate to notch for proper door thickness. (See Figure 7)

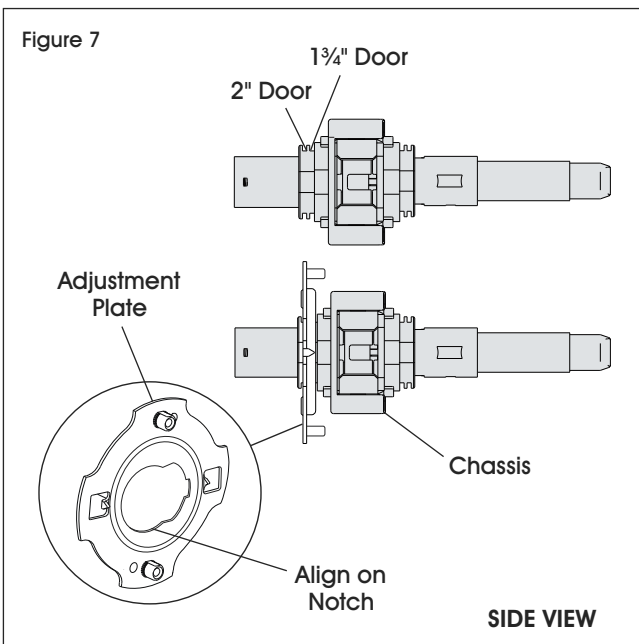

- Reattach the chassis to the outside lever assembly using previously removed screws. Tighten with #2 Phillips screwdriver until snug. (See Figure 8)

 **NOTE:** Do not use a drill to tighten.

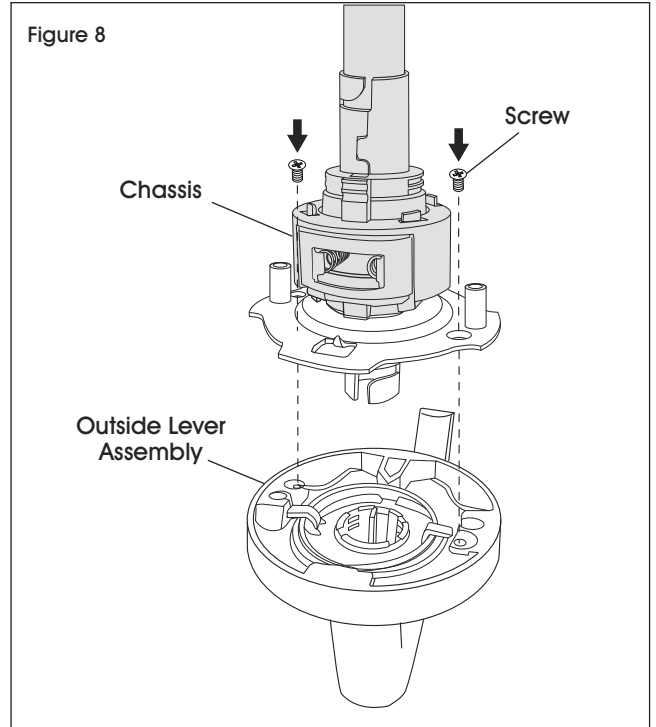

HANDLE INSTALLATION

- Install chassis/outside lever assembly. (See Figure 9)

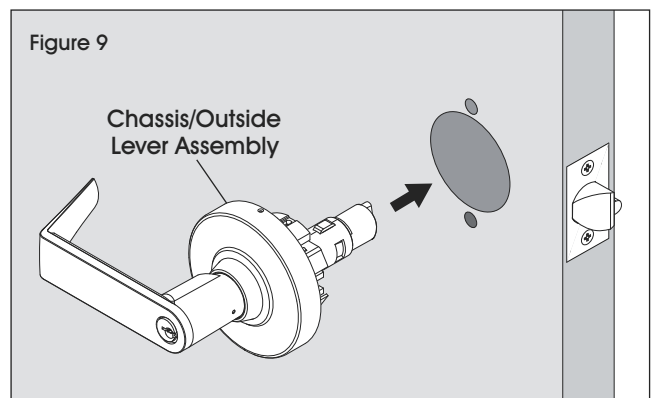

INSTALLATION CONTINUED

2. Ensure door latch prong fits into the slide and the tabs on the latch body fit between chassis slide and slide clip. (See Figure 10)



IMPORTANT! Push latch to center of slide.
(See Figure 10)

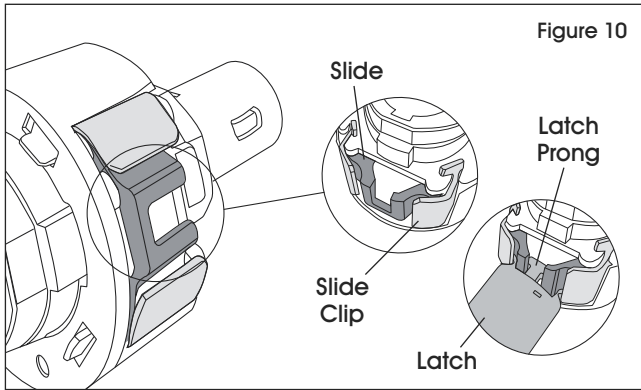

3. Slide push/turn button bushing and inside rose support onto chassis. (See Figure 11)



NOTE: For models with thumb turn buttons or push buttons, install the plastic support bushing if included with the lockset.

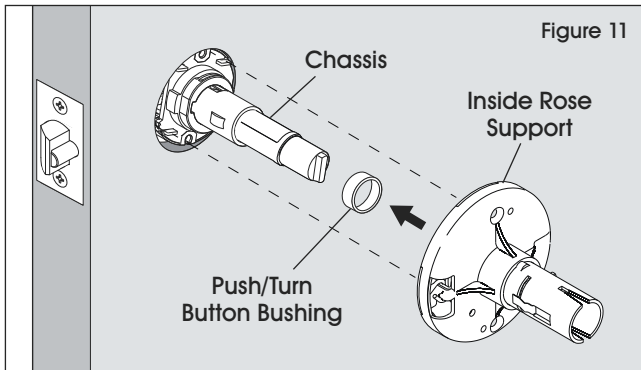

4. Align holes and use Phillips screwdriver to secure with long mounting bolts. (See Figure 12)

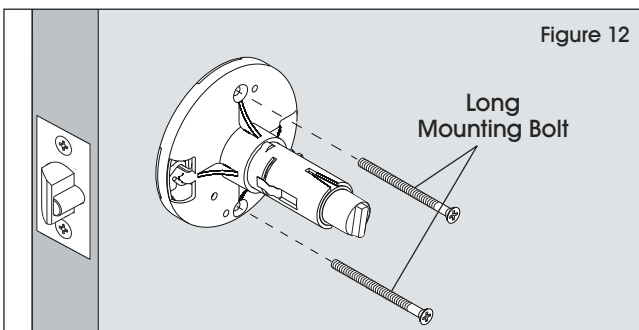

5. Install inside rose. Align dimple with groove on inside of rose and rotate rose clockwise until it stops. (See Figures 13-14)

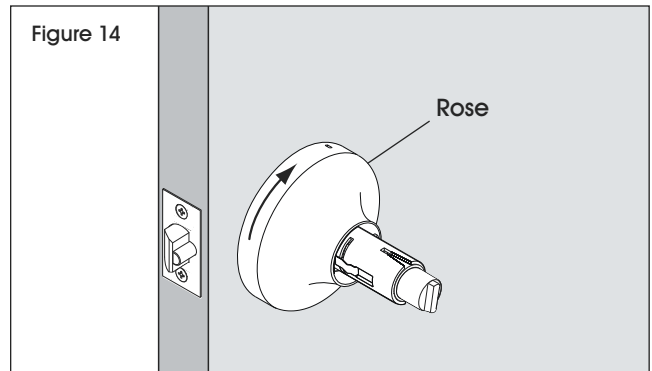
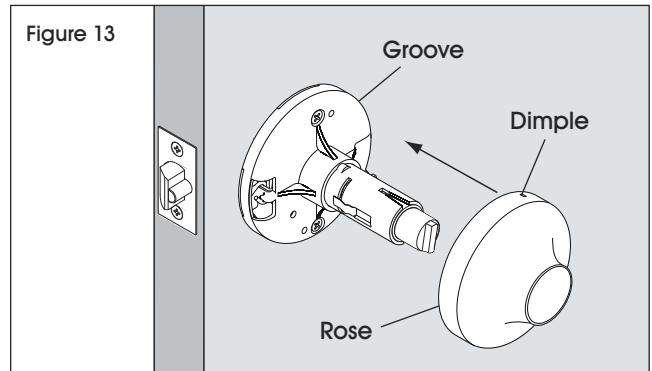

6. Install inside lever. Firmly push on lever until lever catch engages. (See Figure 15)



NOTE: Instructions show installation with Uline model # H-12814 entry lever.

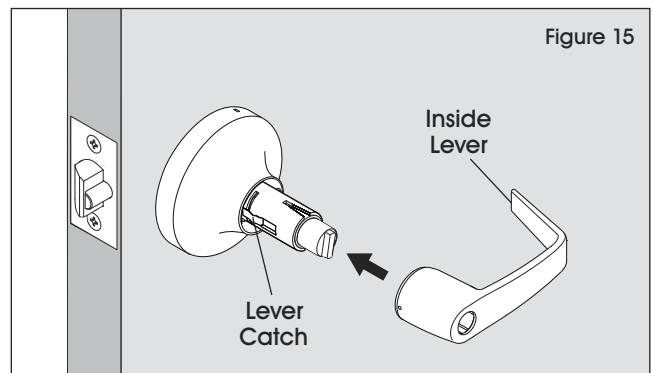

INSTALLATION CONTINUED

7. Install strike on door frame using two large screws provided. (See Figure 16)

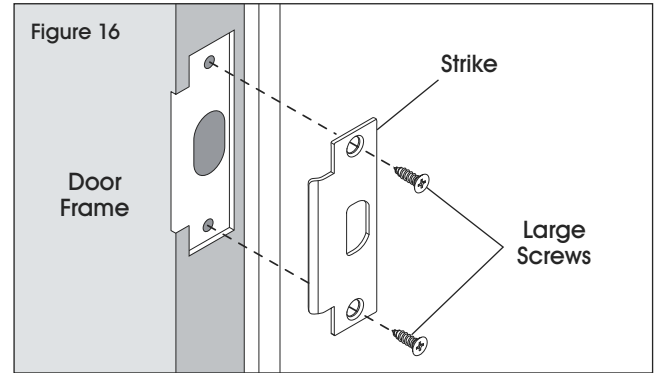

ULINE

1-800-295-5510
uline.com