

# ULINE H-3449 LOCKOUT/TAGOUT KIT – VALVE

1-800-295-5510  
uline.com

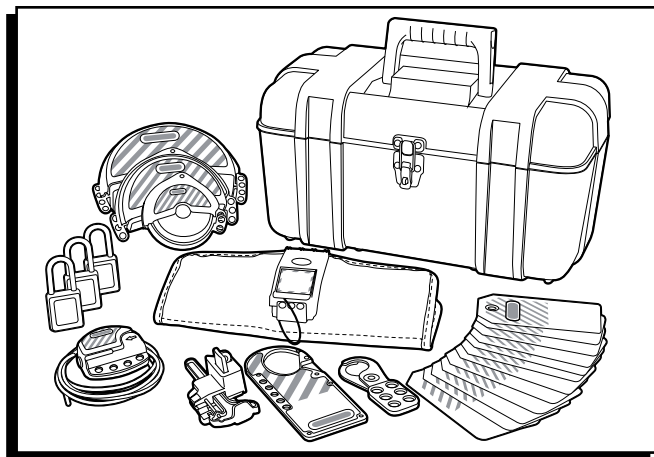

## COMPONENTS

- 3 Keyed-Alike Padlocks
- 1 Snap-On Hasp
- 1 Hasp
- 12 Tags
- 1 Adjustable Cable Lockout
- 3 Gate Valve Covers
- 1 Ball Valve Lockout – Handle-On
- 1 Ball Valve Lockout – Handle-Off

## ADJUSTABLE CABLE LOCKOUT ASSEMBLY

1. With the cable lockout in between the two devices, thread the cable through the first device and pull it toward you. (See Figure 1)

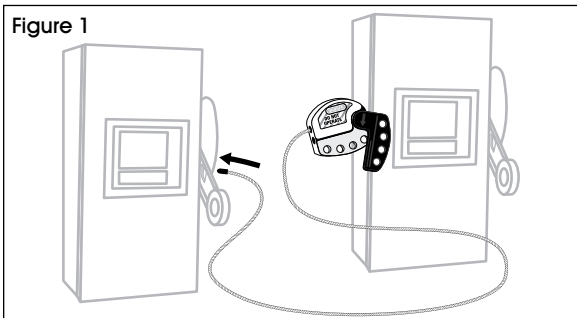

2. Bring the end of the cable over to the second device. (See Figure 2)

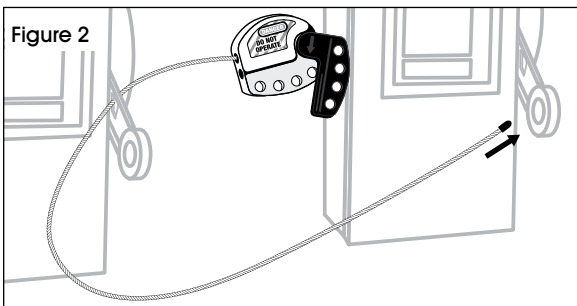

3. Thread the cable away from you through the second device. (See Figure 3)

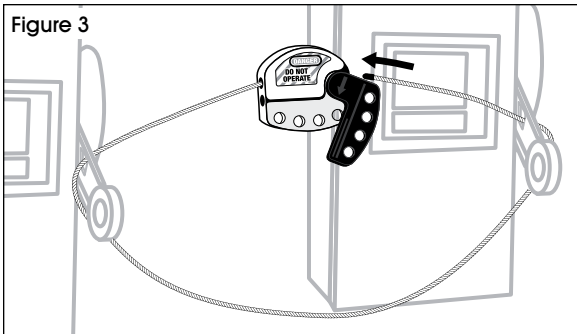

4. Insert the end of the cable into the lockout device. (See Figure 4)

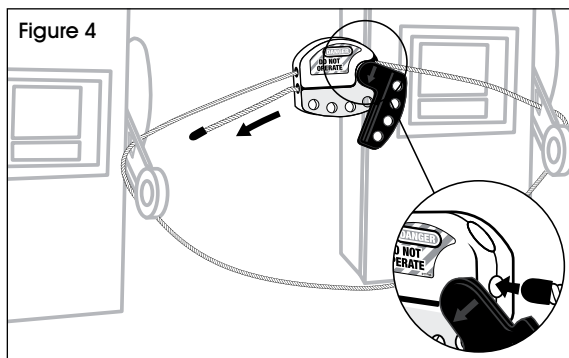

5. Close lockout handle and pull the cable through until it is taut. Insert the padlock and secure. (See Figure 5)

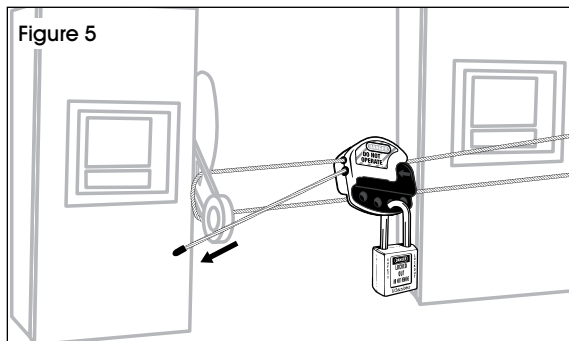

# GATE VALVE LOCKOUT ASSEMBLY

1. Select the properly sized lockout for the specific valve handle to be locked out.

ULINE PART NO.	DESCRIPTION	HANDLE DIAMETER
H-3429	Mini	1-3"
H-3430	Small	2-5"
H-3431	Medium	4-6½"
H-3432	Large	6-10"



**NOTE:** Cover should be loose enough when applied that it does not bind to the valve handle.

2. Rotate the lockout cover to completely surround the valve handle. (See Figure 6)

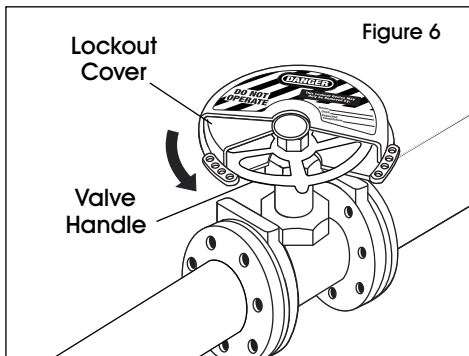

3. Secure with safety lockout padlock(s) by inserting shackle(s) through the overlapping locking eyelets. (See Figure 7)

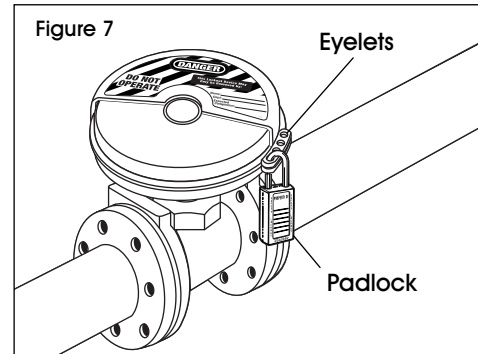

4. To secure a valve handle that has a rising stem, cut out the circular center section of the lockout cover. (See Figure 8)

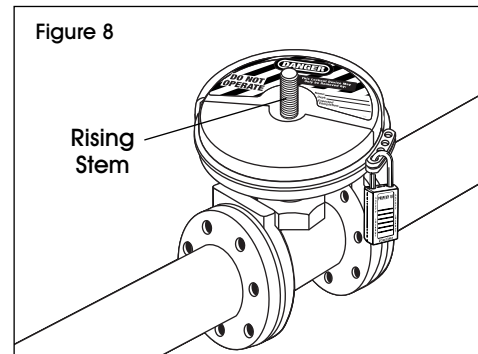

# HANDLE-OFF BALL VALVE LOCKOUT ASSEMBLY

## SETUP

1. Close valve and remove handle. (See Figures 9-10)

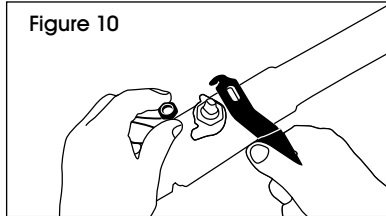
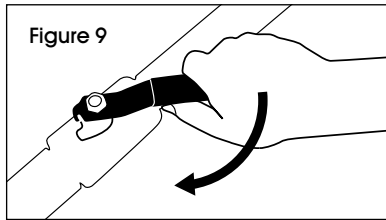

2. Place handle in zippered pouch. (See Figure 11)

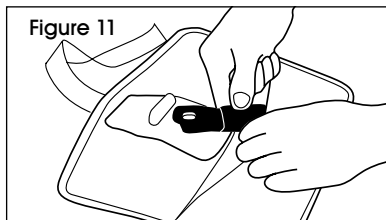

## INSTALLATION

1. Apply lockout on valve. Wrap strap around valve and thread strap through locking mechanism. (See Figure 12)

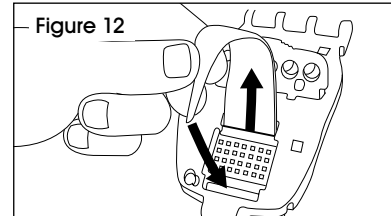

2. Thread zipper tie through both zipper tabs and place end in pocket in locking mechanism. (See Figure 13)

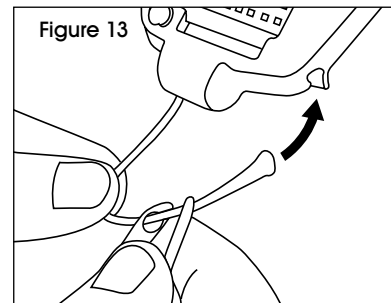

3. Close locking mechanism and apply padlock. (See Figure 14)

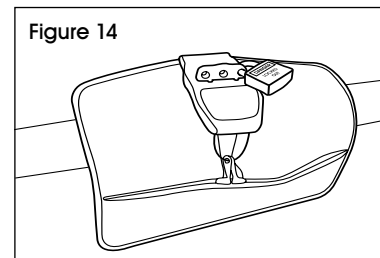

# HANDLE-ON BALL VALVE LOCKOUT OPERATION



**NOTE:** Can be applied to 1/4" to 4" valves.



**NOTE:** Works on insulated pipes and in close quarters.

1. Turn the valve on and position the valve lockout so the red aluminum body is at the top and the flat side is facing you. (See Figure 15)

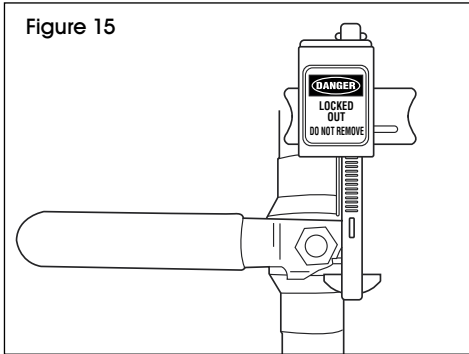

2. Slide the pin down through the space between the operating handle and valve body. (See Figures 16-17)

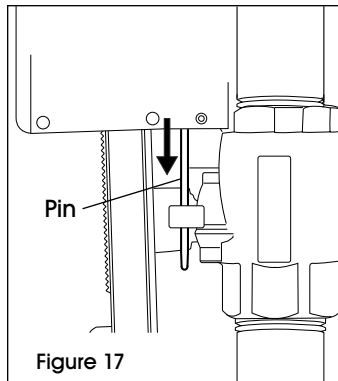
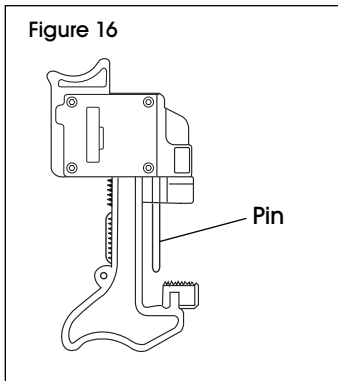

3. Slide the gray clamp until it is secure around the valve. (See Figures 18-19)

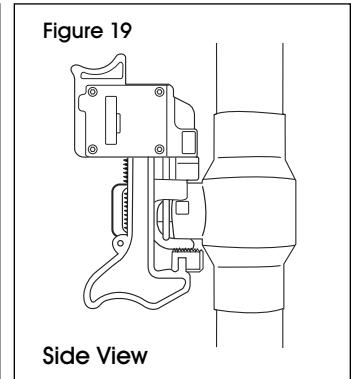
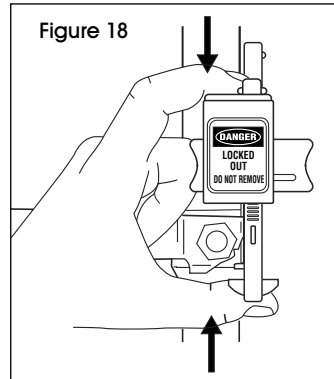

4. Push the gray sliding bar to the left to expose the eyelet for the padlock. (See Figure 20)

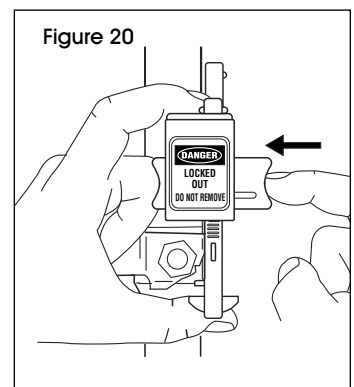

5. Insert the padlock and lock. (See Figure 21)

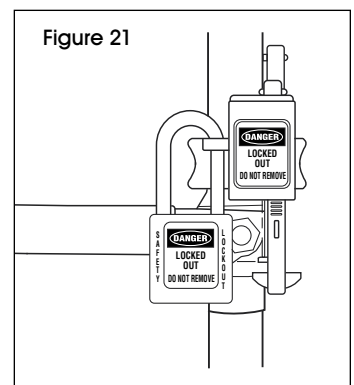

**ULINE**

1-800-295-5510

uline.com

**KIT DE BLOQUEO/ETIQUETADO – VÁLVULA****COMPONENTES**

- 3 Candados con Llave Única
- 1 Pestillo a Presión
- 1 Pestillo
- 12 Etiquetas Colgantes
- 1 Bloqueador Ajustable de Cables
- 3 Cubiertas para Válvulas de Compuerta
- 1 Bloqueador para Válvula de Bola – Con Asa
- 1 Bloqueador para Válvula de Bola – Sin Asa

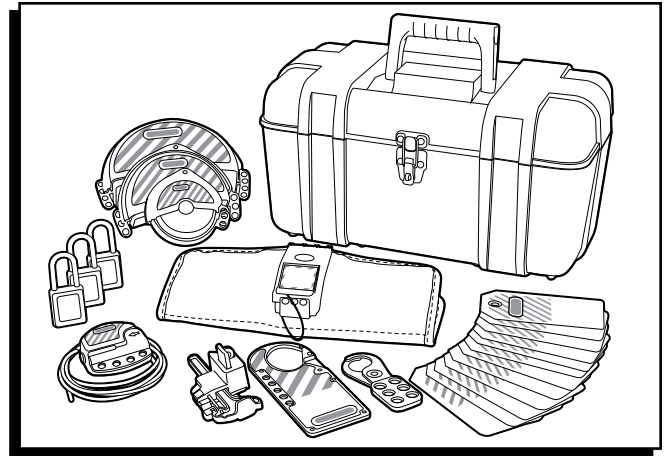
**ENSAMBLE DEL BLOQUEADOR AJUSTABLE DE CABLES**

1. Con el bloqueador de cables colocado entre los dos dispositivos, inserte el cable a través del primer dispositivo y jale hacia usted. (Vea Diagrama 1)

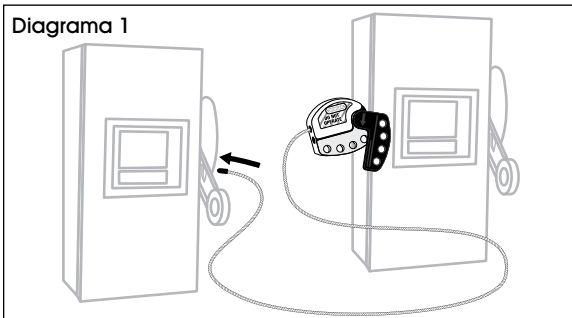

2. Lleve el extremo del cable hasta el segundo dispositivo. (Vea Diagrama 2)

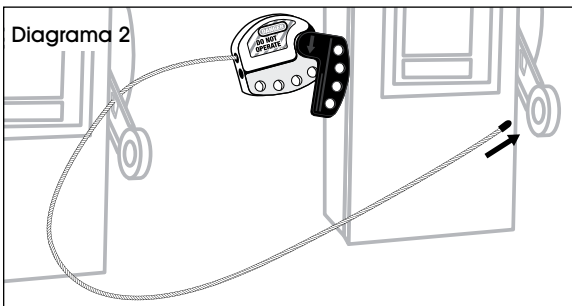

3. Inserte el cable en dirección opuesta a usted a través del segundo dispositivo. (Vea Diagrama 3)

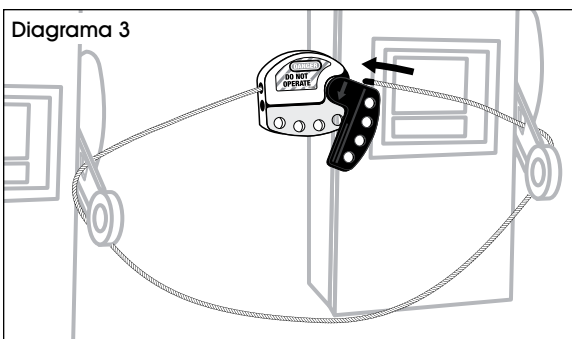

4. Inserte el extremo del cable en el dispositivo bloqueador. (Vea Diagrama 4)

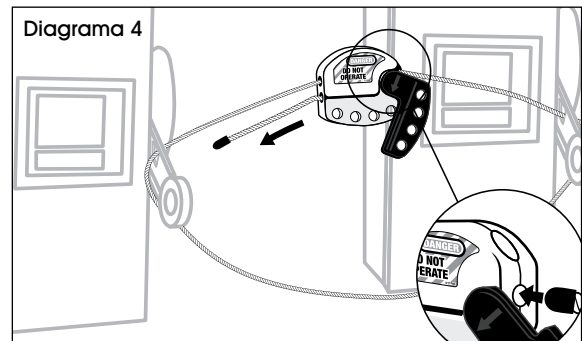

5. Cierre el asa del bloqueador y jale el cable hasta que quede tenso. Inserte el candado y ciérrelo. (Vea Diagrama 5)

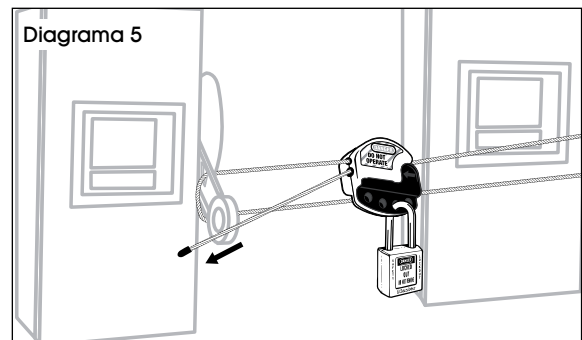

# ENSAMBLE DEL BLOQUEADOR PARA VÁLVULA DE COMPUERTA

1. Seleccione el bloqueador del tamaño adecuado para el asa de la válvula que desea bloquear.

NO. DE PARTE DE ULINE	DESCRIPCIÓN	DIÁMETRO DEL ASA
H-3429	Mini	2.5-7.6 cm (1-3")
H-3430	Pequeño	5-12.7 cm (2-5")
H-3431	Mediano	10.2-16.5 cm (4-6½")
H-3432	Grande	15.2-25.4 cm (6-10")

 **NOTA:** La cubierta debería quedar lo suficientemente suelta al colocarla de forma que no quede unida al asa de la válvula.

2. Gire la cubierta del bloqueador para que rodee completamente el asa de la válvula. (Vea Diagrama 6)

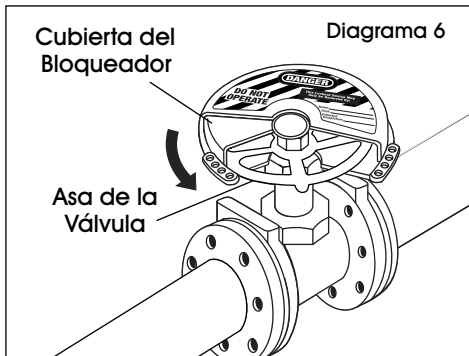

3. Asegure el/los candado(s) de bloqueo de seguridad insertando el/los eslabón(es) a través de los ojales de bloqueo superpuestos. (Vea Diagrama 7)

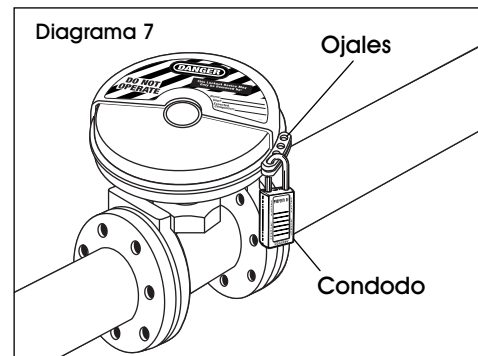

4. Para asegurar un asa de válvula con un vástago alzado, recorte la sección central circular de la cubierta del bloqueador. (Vea Diagrama 8)

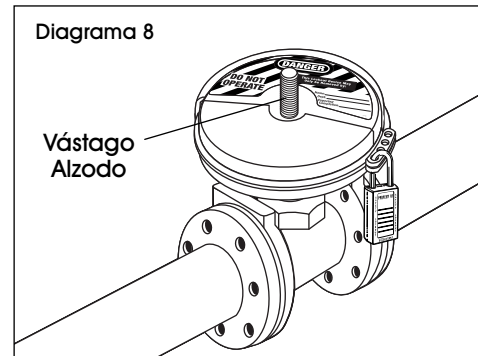

# ENSAMBLE DEL BLOQUEADOR PARA VÁLVULA DE BOLA CON ASA DESACTIVADA

## CONFIGURACIÓN

1. Cierre la válvula y quite el asa (Vea Diagramas 9-10)

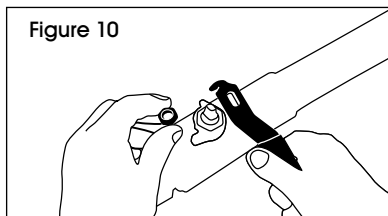
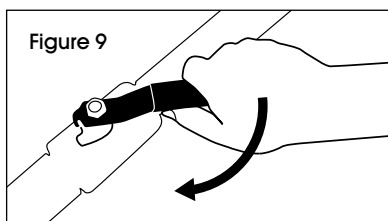

2. Coloque el asa en una bolsa con cierre. (Vea Diagrama 11)

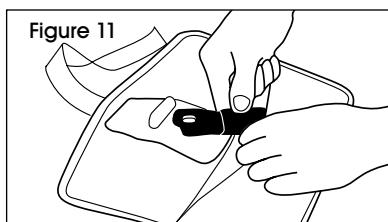

## INSTALACIÓN

1. Enrolle el la correa alrededor de la válvula e inserte la correa a través del mecanismo de bloqueo. (Vea Diagrama 12)

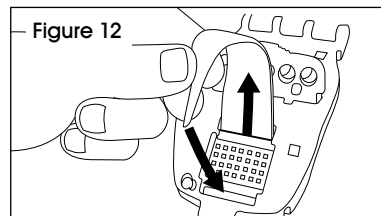

2. Inserte el fleje dentado a través de ambas lengüetas dentadas y coloque el extremo del bolsillo en el mecanismo de bloqueo. (Vea Diagrama 13)

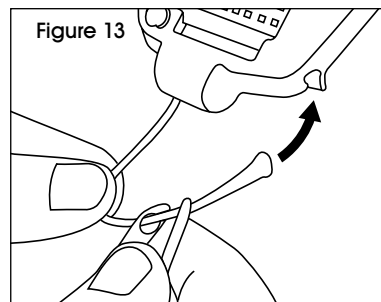

3. Close the locking mechanism and apply padlock. (See Figure 14)

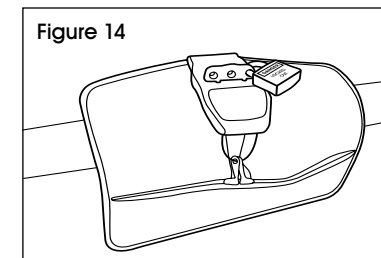

# FUNCIONAMIENTO DEL BLOQUEADOR PARA VÁLVULA DE BOLA CON ASA ACTIVADA

 **NOTA:** Se puede colocar en válvulas de 1/4" a 4".

 **NOTA:** Funciona en tuberías aisladas y en entornos cerrados.

1. Encienda la válvula y coloque el bloqueador para válvula de forma que el cuerpo de aluminio rojo quede hacia arriba y que el lado plano esté mirando hacia usted. (Vea Diagrama 15)

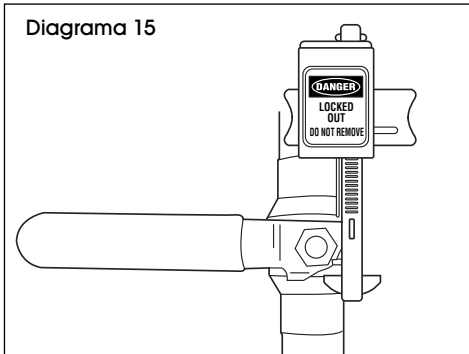

2. Deslice el pasador hacia abajo a través del espacio entre el asa de operación y el cuerpo de la válvula. (Vea Diagramas 16 y 17)

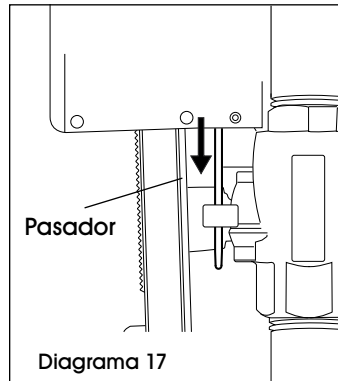
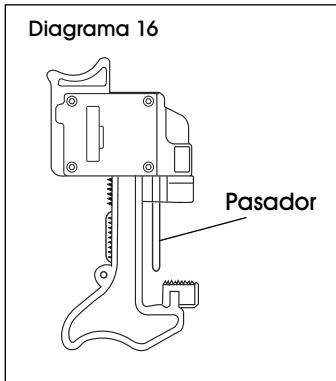

3. Deslice la abrazadera gris hasta que quede fija alrededor de la válvula. (Vea Diagramas 18 y 19)

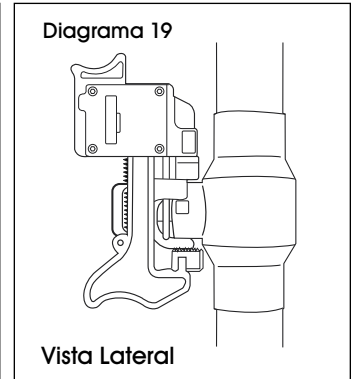
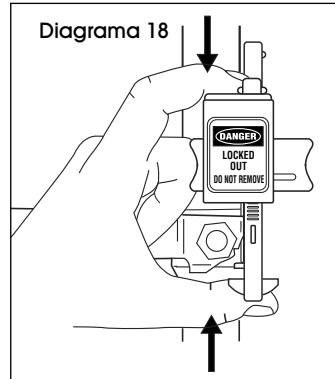

4. Empuje la barra deslizante gris hacia la izquierda para dejar a la vista el ojal para el candado. (Vea Diagrama 20)

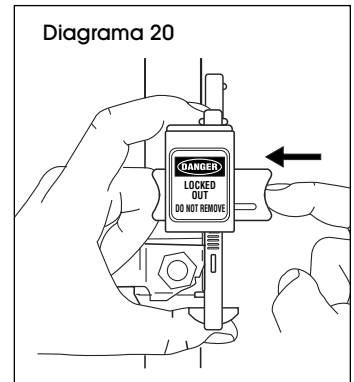

5. Inserte el candado y ciérralo. (Vea Diagrama 21)

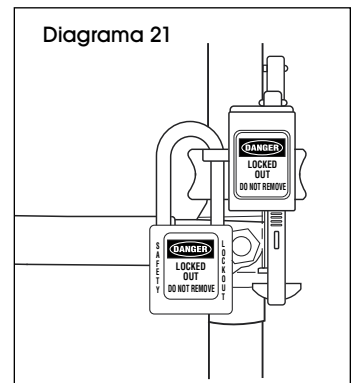

**ULINE**

800-295-5510

uline.mx



**TROUSSE DE  
CADENASSAGE ET  
D'ÉTIQUETAGE – VANNE****COMPOSANTS**

- 3 cadenas à clés identiques
- 1 morillon encliquetable
- 1 morillon
- 12 étiquettes
- 1 cadenasage à câble réglable
- 3 couvercles de robinet-vanne
- 1 cadenasage pour robinet à bille avec poignée
- 1 cadenasage pour robinet à bille sans poignée

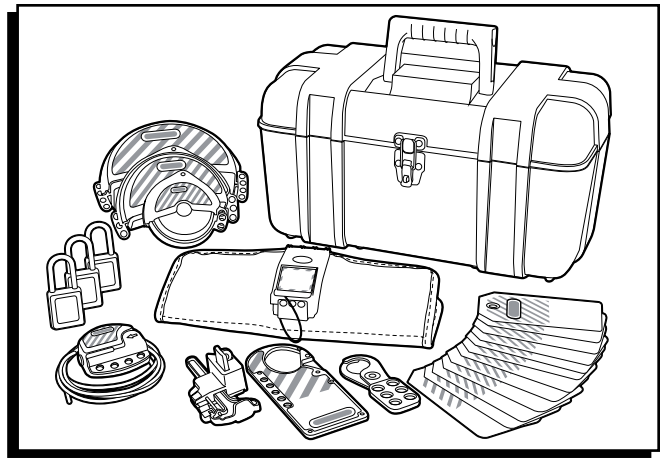
**ASSEMBLAGE DU CÂBLE DE CADENASSAGE RÉGLABLE**

1. Avec le câble de cadenasage entre les deux appareils, faites passer le câble à travers le premier appareil et tirez-le vers vous. (Voir Figure 1)

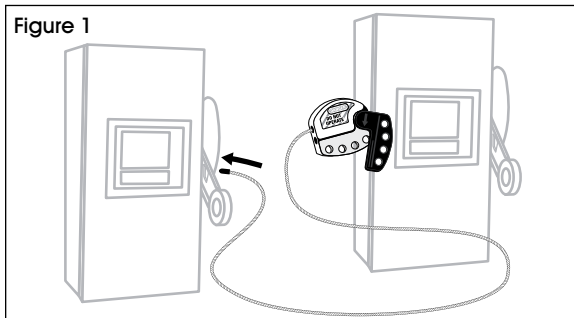

2. Faites passer l'extrémité du câble vers le deuxième appareil. (Voir Figure 2)

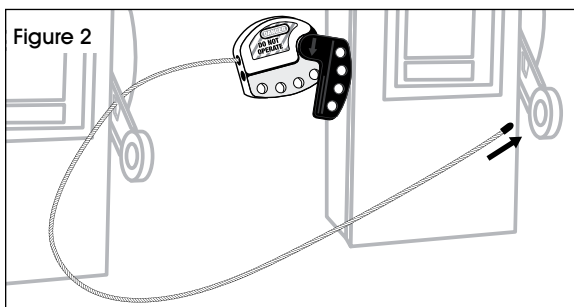

3. Enfillez le câble à travers le côté extérieur du deuxième appareil. (Voir Figure 3)

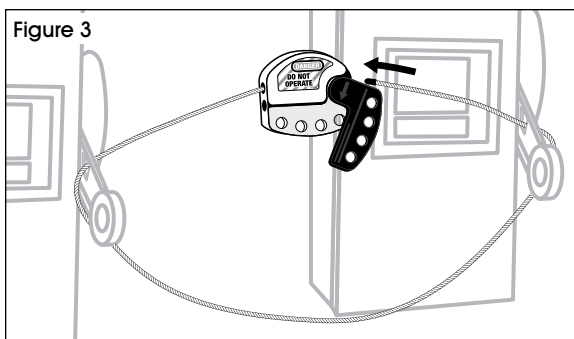

4. Insérez l'extrémité du câble dans le dispositif de cadenasage. (Voir Figure 4)

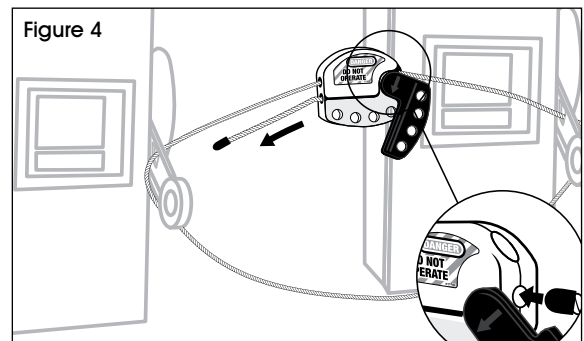

5. Fermez la poignée de cadenasage et tirez le câble jusqu'à ce qu'il soit tendu. Insérez le cadenas et fixez-le. (Voir Figure 5)

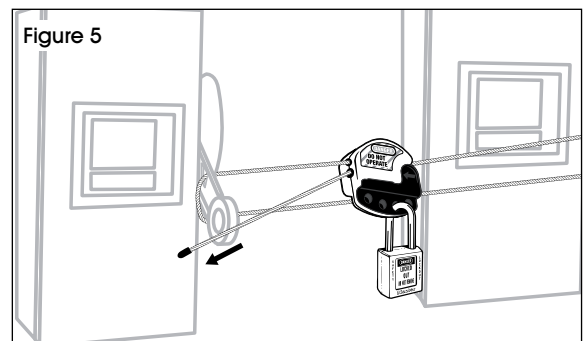

# PROCÉDURE DE CADENASSAGE DU ROBINET-VANNE

1. Sélectionnez la taille de couvercle appropriée pour la poignée du robinet à cadenasser.

RÉF. ULINE	DESCRIPTION	DIAMÈTRE DE LA POIGNÉE
H-3429	Mini	2,5 à 7,6 cm (1 à 3 po)
H-3430	Petit	5 à 12,7 cm (2 à 5 po)
H-3431	Moyen	10,2 à 16,5 cm (4 à 6 ½ po)
H-3432	Grand	15,2 à 25,4 cm (6 à 10 po)

 **REMARQUE :** Le couvercle doit être suffisamment lâche lorsqu'il est installé pour qu'il ne se coince pas sur la poignée de robinet.

2. Tournez le couvercle de cadenasage de façon à ce qu'il enveloppe la poignée du robinet. (Voir Figure 6)

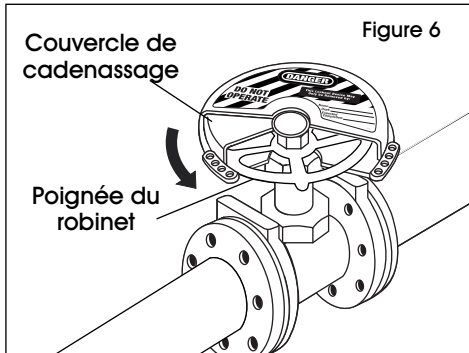

3. Fixez à l'aide d'un ou de plusieurs cadenas de sécurité en insérant l'arceau à travers les œillets de cadenasage qui se chevauchent. (Voir Figure 7)

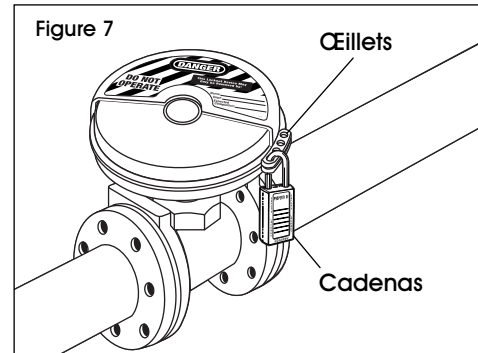

4. Pour le fixer à une poignée de robinet munie d'une tige montante, découpez la partie centrale circulaire du couvercle de cadenasage. (Voir Figure 8)

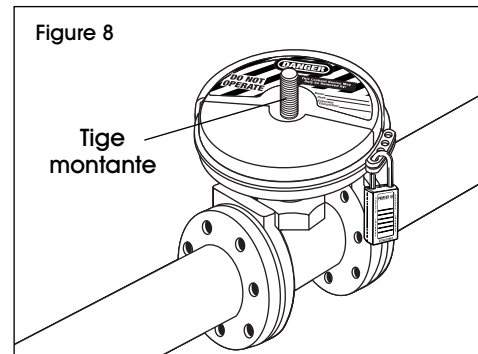

# ASSEMBLAGE DU CADENAS POUR ROBINET À BILLE SANS POIGNÉE

## PRÉPARATION

1. Fermez la vanne et retirez la poignée.  
(Voir Figures 9-10)

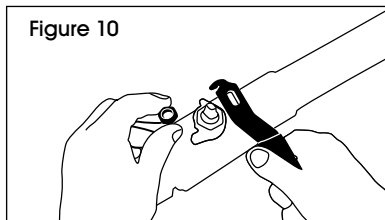
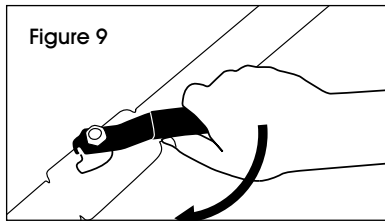

2. Placez la poignée dans la pochette avec fermeture à glissière.  
(Voir Figure 11)

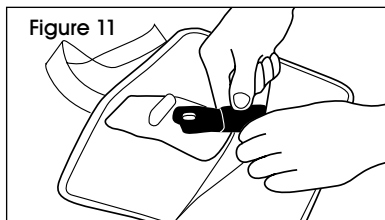

## INSTALLATION

1. Enroulez la courroie autour de la vanne et enfitez la courroie à travers le mécanisme de verrouillage.  
(Voir Figure 12)

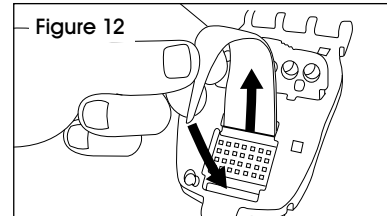

2. Enfilez l'attache à travers les trous des deux curseurs de fermeture à glissière et placez l'extrémité dans la fente du mécanisme de verrouillage.  
(Voir Figure 13)

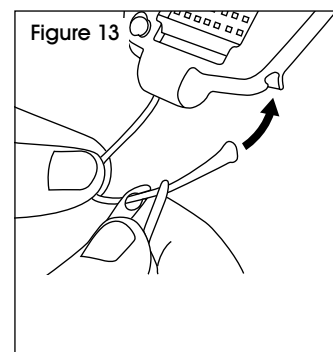

3. Close the locking mechanism and apply padlock.  
(See Figure 14)

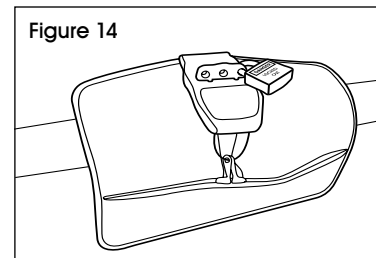

# CADENASSAGE DU ROBINET À BILLE AVEC POIGNÉE

 **REMARQUE :** Peut être utilisé avec les robinets de 0,6 à 10,2 cm (1/4 po à 4 po).

 **REMARQUE :** Convient aux tuyaux isolés et aux espaces restreints.

1. Ouvrez le robinet et placez le cadenassage de façon à ce que le corps en aluminium rouge soit en haut et que le côté plat soit orienté vers vous. (Voir Figure 1)

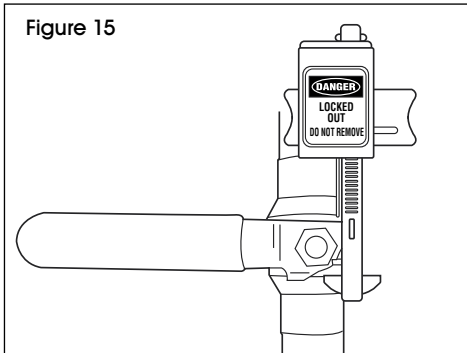

2. Faites glisser la tige vers le bas à travers l'espace entre la poignée d'actionnement et le corps du robinet. (Voir Figures 2 et 3)

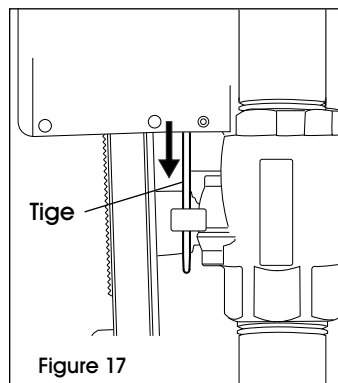
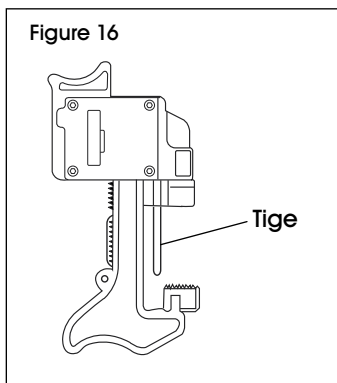

3. Faites glisser le serre-joint gris jusqu'à ce qu'il soit fixé autour du robinet. (Voir Figures 4 et 5)

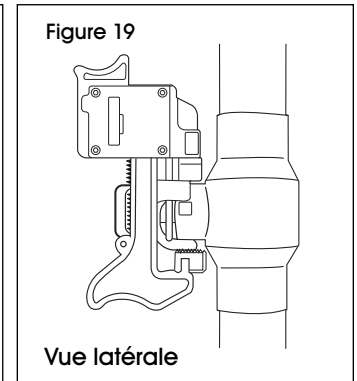
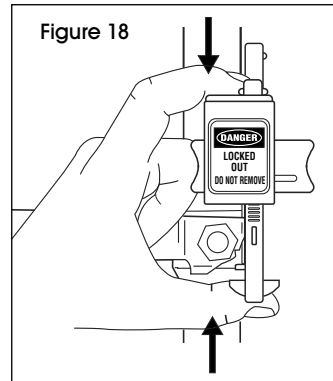

4. Poussez la barre coulissante grise vers la gauche pour exposer l'œillet afin d'y insérer le cadenas. (Voir Figure 6)

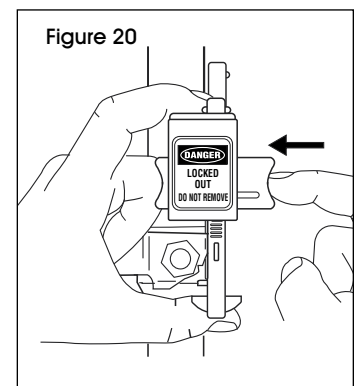

5. Insérez le cadenas et verrouillez. (Voir Figure 7)

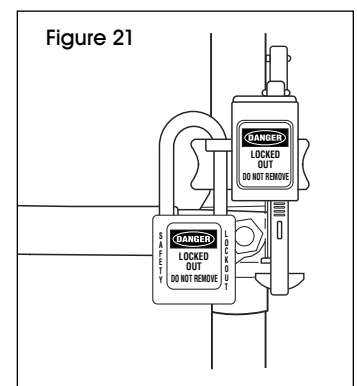

**ULINE**

1 800 295-5510  
uline.ca