

ULINE H-5858 TORK® XPRESSNAP® COUNTER NAPKIN DISPENSER

1-800-295-5510
uline.com

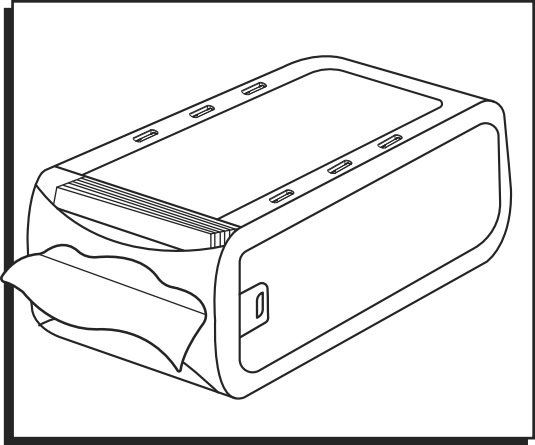

LOADING

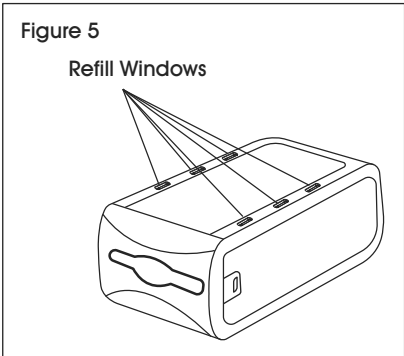
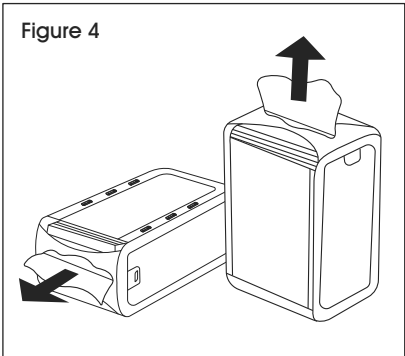
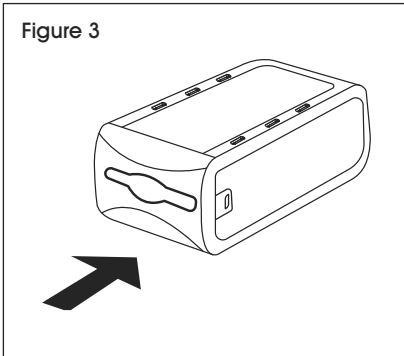
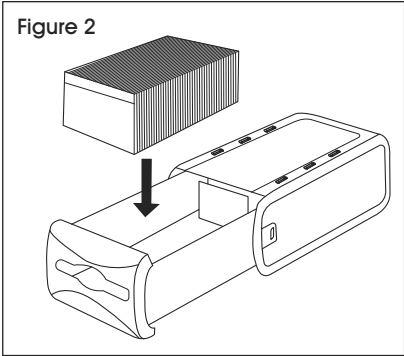
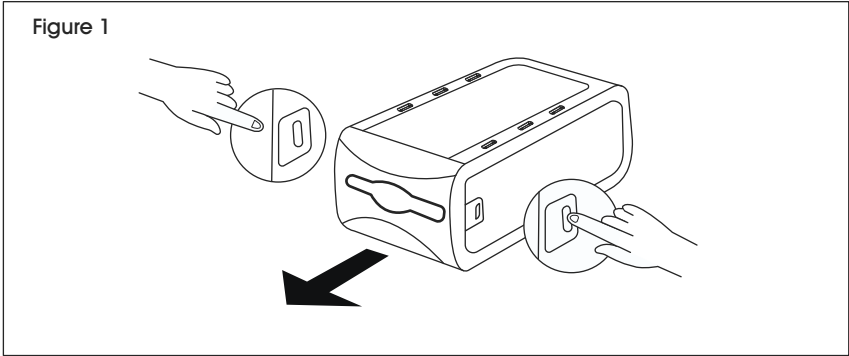

 **NOTE:** Use dispenser with Tork® Xpressnap® napkins only. Universal napkins will not dispense effectively from the dispenser.

3. Close door and begin dispensing. (See Figures 3-4)

 **NOTE:** Napkin refill windows can be found on the top panel of the dispenser. (See Figure 5)

1. To open dispenser, press the tabs on each side of dispenser and pull open. (See Figure 1)
2. Load napkins into dispenser. (See Figure 2) Start the first napkin through the dispensing section. Dispenser holds up to 500 napkins at a time. Do not overfill.

AD-A-GLANCE® FEATURE

1. To use the AD-a-Glance® feature, open dispenser. (See Figure 6)

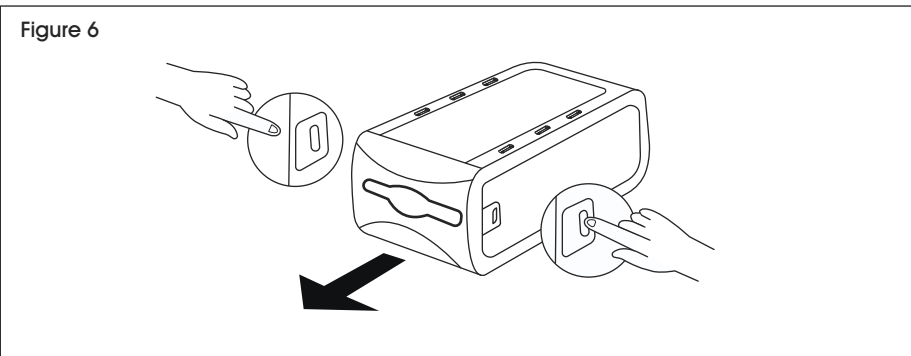

2. Pull out cards in top and bottom of dispenser. (See Figure 7)
3. Use the templates at adaglance.torkusa.com to design your own artwork. AD-a-Glance® insert size is 5.25 x 9".
4. Insert customized artwork into dispenser and close door. (See Figure 8)

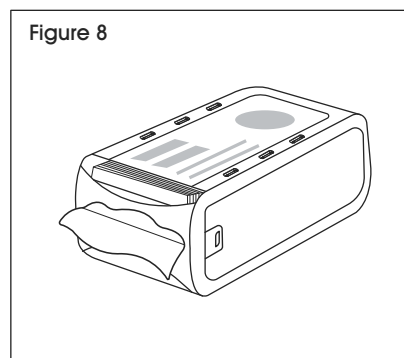
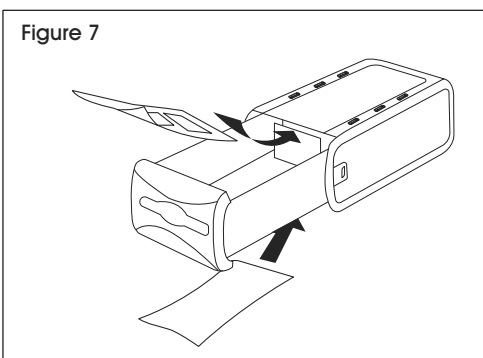

CLEANING

Wipe with cloth using soap and water. If necessary, use mild cleaners. Do not use abrasives. Dispenser is not dishwasher safe.

ULINE

1-800-295-5510
uline.com

ULINE H-5858

TORK® XPRESSNAP®
SERVILLETERO DE
MOSTRADOR

800-295-5510
uline.mx

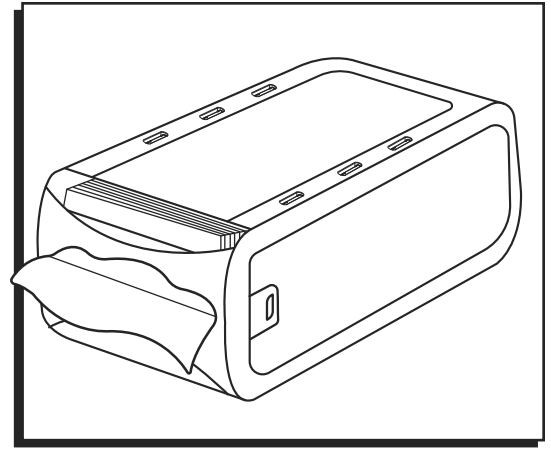

CARGA

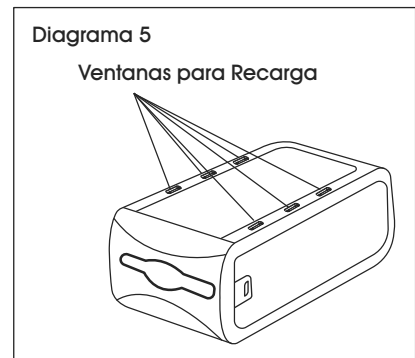
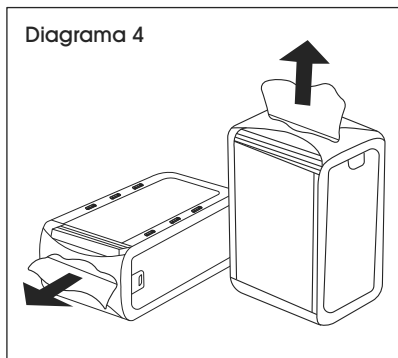
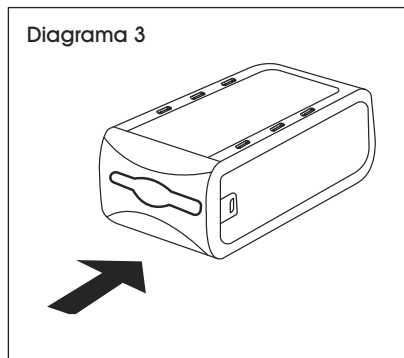
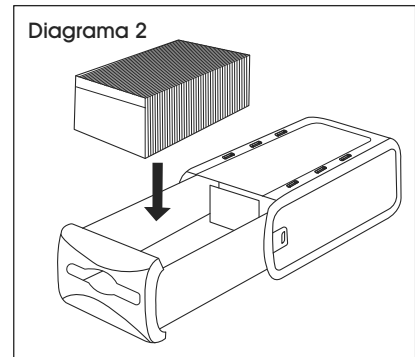
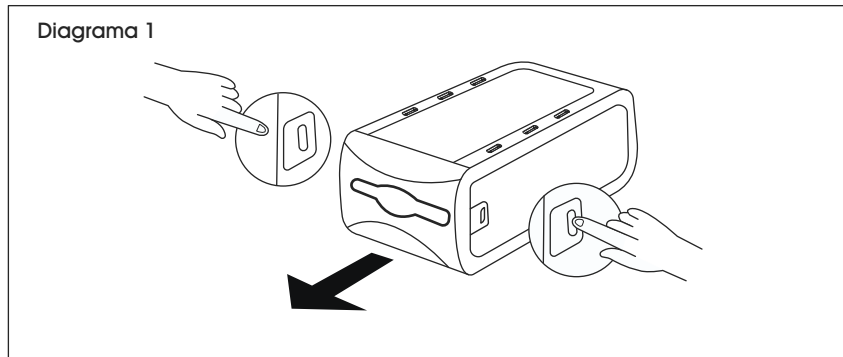

NOTA: Utilice el despachador solo con servilletas Tork® Xpressnap®. Las servilletas universales **NO** se despacharán adecuadamente.

1. Para abrir el servilletero, presione las pestañas a cada lado del despachador y jale para abrir. (Vea Diagrama 1)
2. Cargue las servilletas dentro del despachador. (Vea Diagrama 2). Saque la primer servilleta a través de la sección para despachar. El despachador sostiene hasta 500 servilletas a la vez. No lo sobrecargue.

3. Cierre la puerta y comience a despacharlas. (Vea Diagramas 3-4)



NOTA: Las ventanas para recargar las servilletas se encuentran en la parte superior del despachador. (Vea Diagrama 5)

FUNCIÓN AD-A-GLANCE®

1. Para utilizar la función AD-a- Glance® abra el despachador. (Vea Diagrama 6)

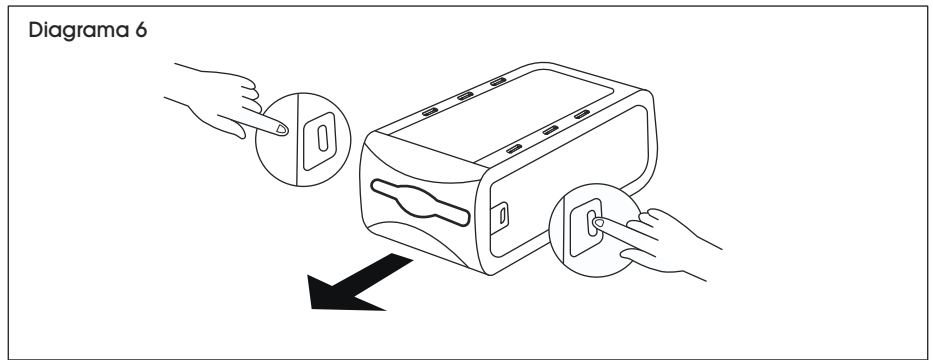

2. Saque la lámina de la parte superior. (Vea Diagrama 7)
3. Utilice las plantillas de adaglance.torkusa.com para diseñar su propio arte. El tamaño del inserto de AD-a- Glance® es de 13.30 x 23 cm (5.25 x 9").
4. Inserte el arte personalizado en el despachador y cierre la puerta. (Vea Diagrama 8)

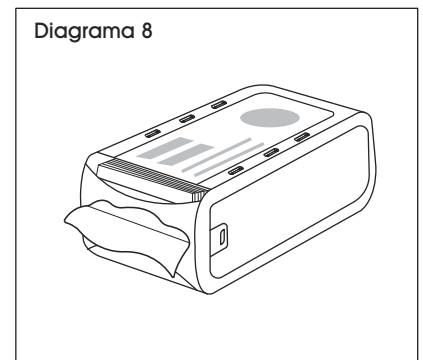
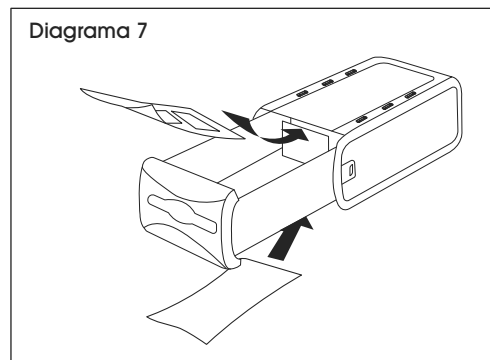

LIMPIEZA

Limpie con trapo utilizando agua y jabón. Si es necesario utilice limpiadores suaves. NO utilice abrasivos. El despachador NO es apto para lavavajillas.

ULINE

800-295-5510
uline.mx

ULINE H-5858

**TORK^{MD} XPRESSNAP^{MD} –
DISTRIBUTEUR DE
SERVIETTES DE COMPTOIR**

1-800-295-5510
uline.ca

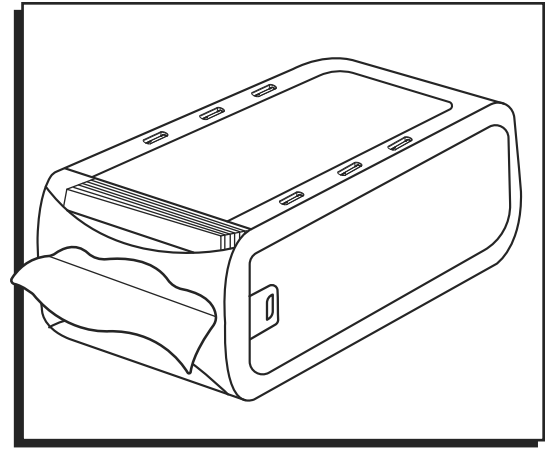

CHARGEMENT

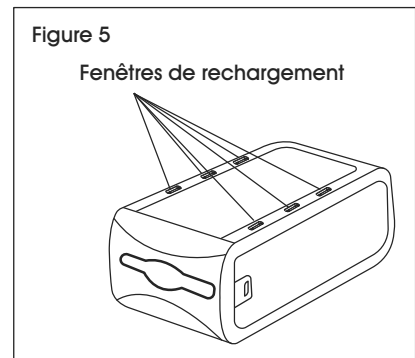
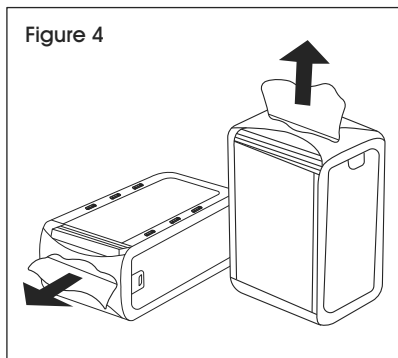
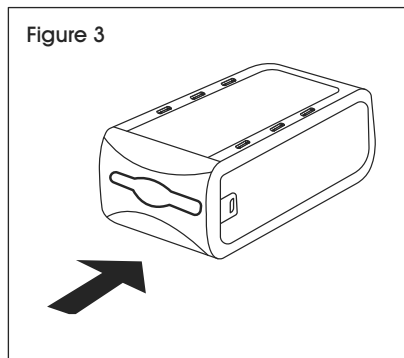
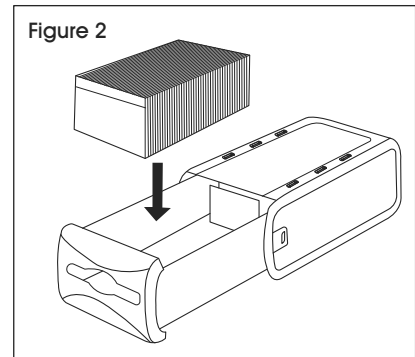
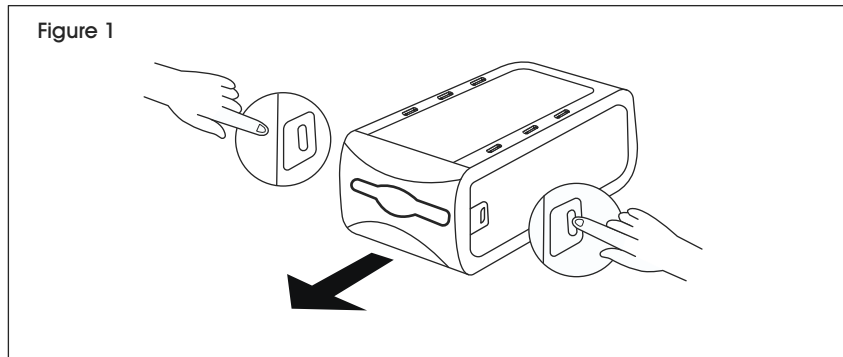

 **REMARQUE :** Utilisez le distributeur uniquement avec les serviettes Tork^{MD} Xpressnap^{MD}. Les serviettes générales ne pourront pas être distribuées efficacement avec ce distributeur.

1. Pour ouvrir le distributeur, appuyez sur les languettes se trouvant de chaque côté du distributeur et tirez dessus. (Voir Figure 1)
2. Placez les serviettes dans le distributeur. (Voir Figure 2). Faites passer la première serviette à travers l'ouverture de distribution. Le distributeur peut contenir jusqu'à 500 serviettes à la fois. Ne surchargez pas.

3. Refermez l'accès et le distributeur est prêt. (Voir Figures 3-4)

 **REMARQUE :** Les fenêtres de recharge se trouvent sur le panneau supérieur du distributeur. (Voir Figure 5)

FONCTION AD-A-GLANCE^{MD}

1. Pour l'utilisation de la fonction AD-a-Glance^{MD}, ouvrez le distributeur. (Voir Figure 6)

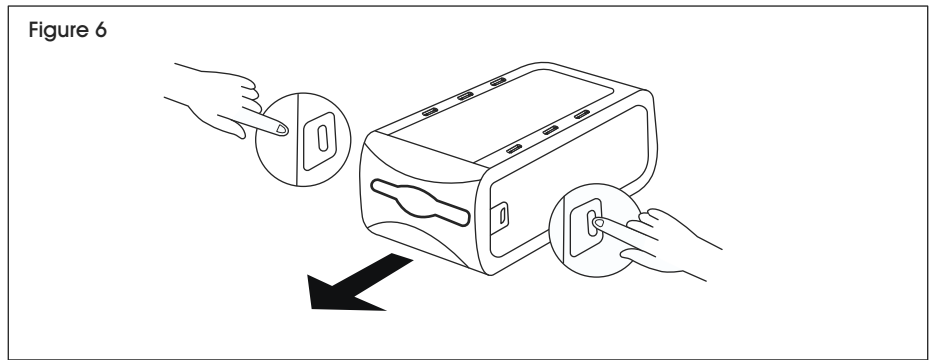

2. Tirez pour sortir la carte se trouvant à l'intérieur, dans la partie supérieure du distributeur. (Voir Figure 7)
3. Référez-vous aux modèles sur adaglance.torkusa.com pour créer vos propres illustrations. Les dimensions de l'encart AD-a-Glance^{MD} sont de 5,25 x 9 po.
4. Insérez votre illustration personnalisée dans le distributeur et refermez l'accès. (Voir Figure 8)

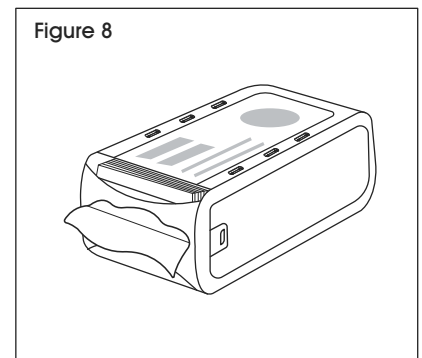
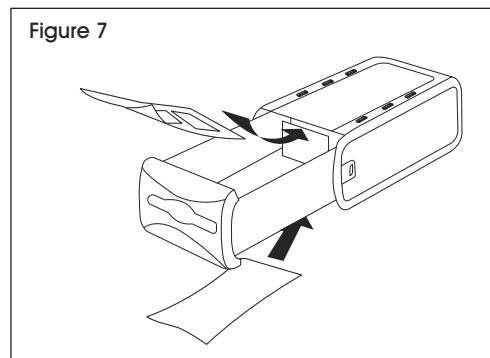

ENTRETIEN

Nettoyez avec un linge humide et du savon. Au besoin, utilisez des nettoyeurs doux. N'utilisez pas d'abrasif. Le distributeur n'est pas conçu pour un nettoyage au lave-vaisselle.

ULINE

1-800-295-5510
uline.ca