

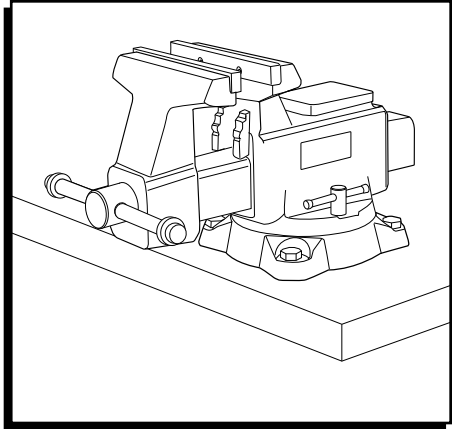



# ULINE H-7204 WILTON® BENCH VISE

WILTON MODEL NO. 676U

1-800-295-5510  
uline.com

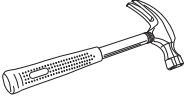
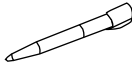

### TOOLS NEEDED

-   
Electric Drill
-   
7/16" Drill Bit
-   
Wrench
-   
Hammer
-   
Center Punch

## INSTALLATION

1. Select 676U circle from paper template provided. (See Figure 1)

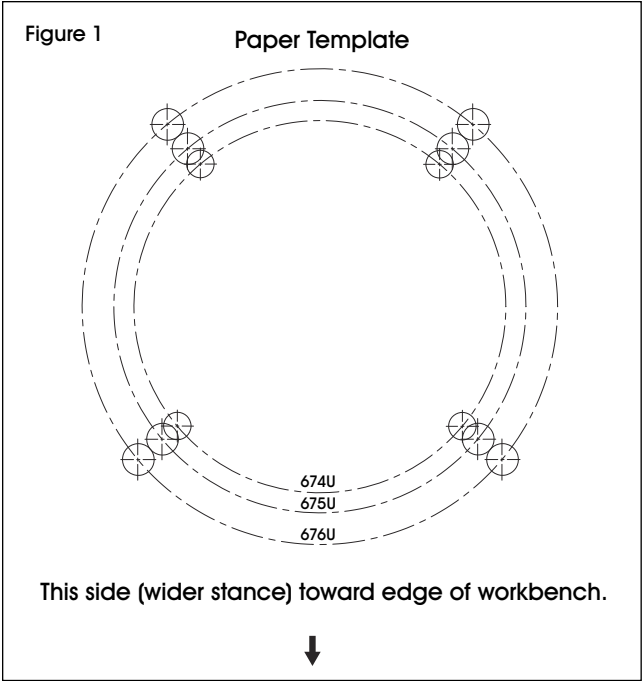

2. Tape paper template in place. Ensure base does not overhang edge of workbench when mounted. (See Figure 2)

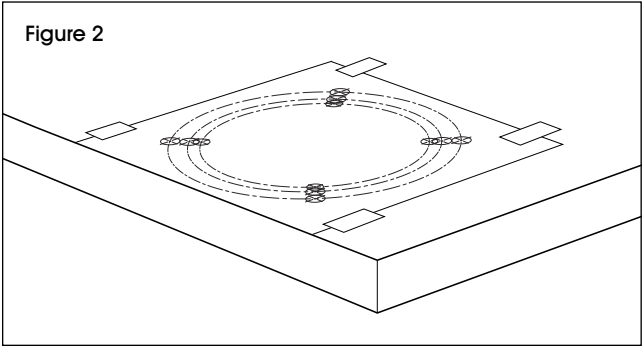

3. Puncture the four hole centers with an awl or center punch. Ensure underside of bolt hole locations is clear of legs, brackets, drawers, etc. (See Figure 3)

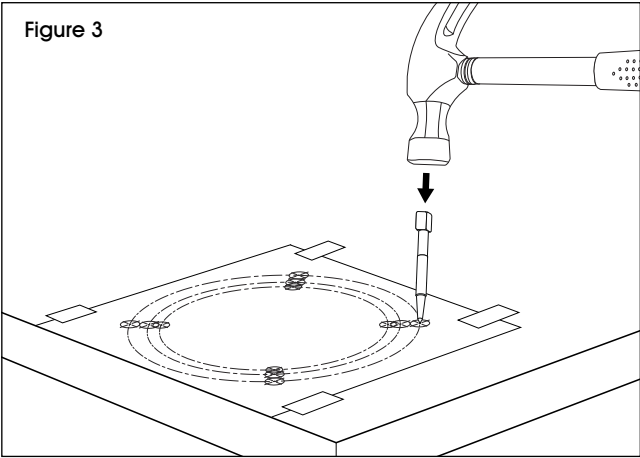

4. Drill four 1/2" diameter holes. (See Figure 4)

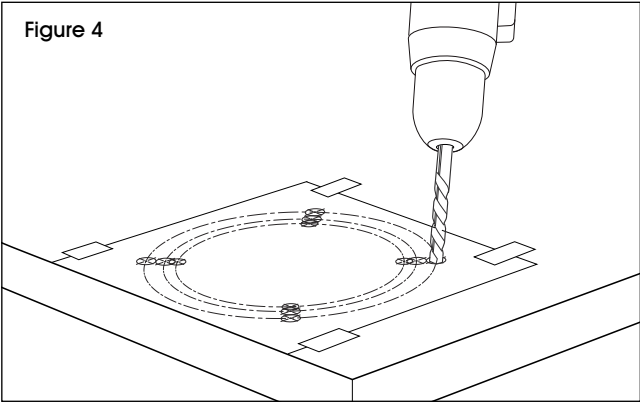

## INSTALLATION CONTINUED

5. Mount vise with four hex cap bolts, 2" longer than benchtop thickness. Use 7/16" diameter bolts. (See Figure 5)
6. Secure with washers and nuts.

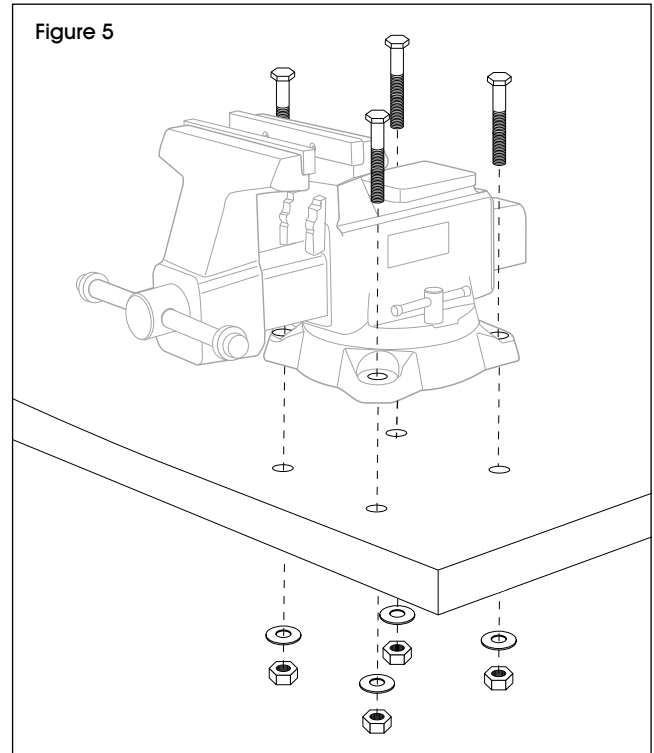

**ULINE**

1-800-295-5510  
uline.com

**ULINE** H-7204

**WILTON® TORNILLO DE BANCO**

WILTON MODELO NO. 676U

800-295-5510

uline.mx

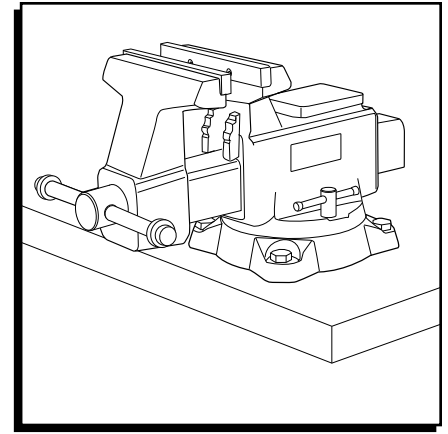

### HERRAMIENTAS NECESARIAS



Taladro Eléctrico



Broca de 7/16"



Llave Combinada

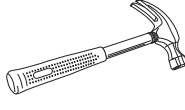

Martillo

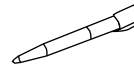

Perforadora

## INSTALACIÓN

1. Seleccione el círculo 676U de la plantilla de papel proporcionada. (Vea Diagrama 1)

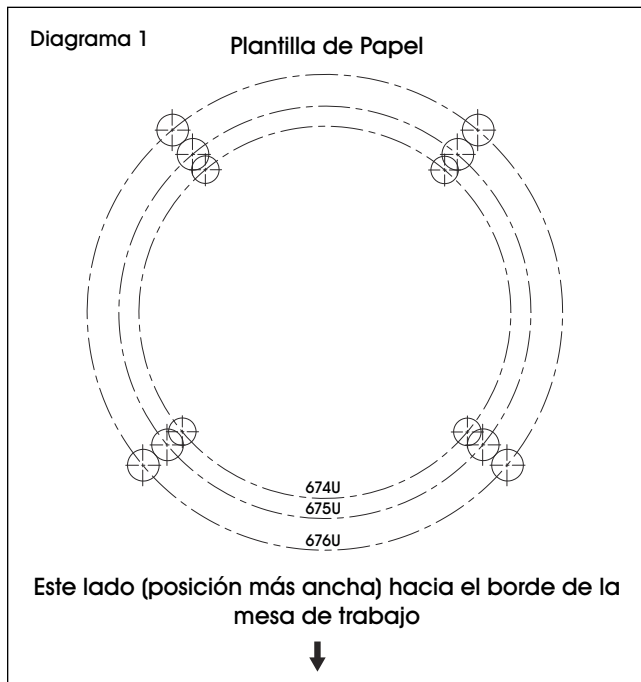

2. Pegue la plantilla de papel en su lugar. Asegúrese de que la base no sobresalga de la mesa de trabajo al instalarla. (Vea Diagrama 2)

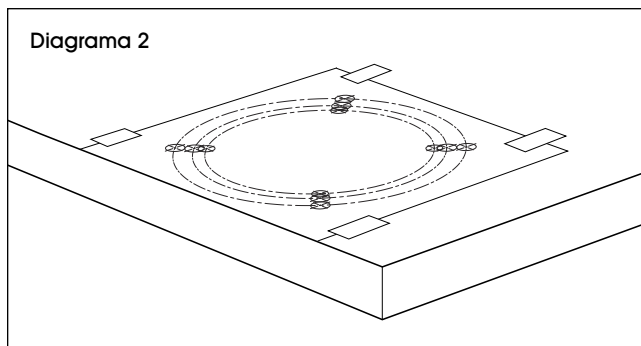

3. Perfore los cuatro centros de orificio con un punzón o perforadora. Asegúrese de que el lado inferior de las perforaciones esté libre de patas, soportes, cajones, etc. (Vea Diagrama 3)

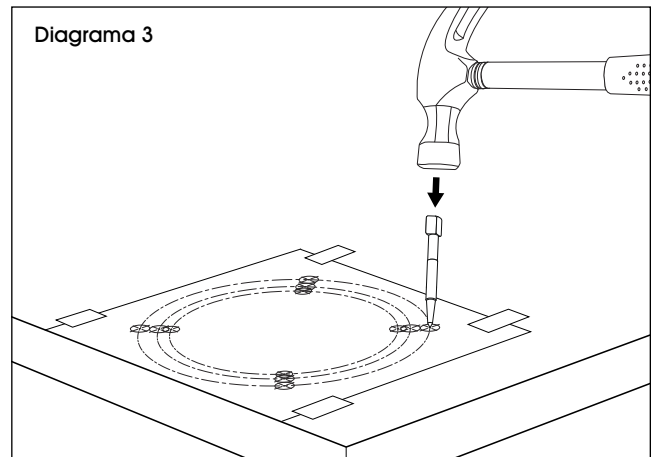

4. Taladre cuatro orificios de 1/2" de diámetro. (Vea Diagrama 4)

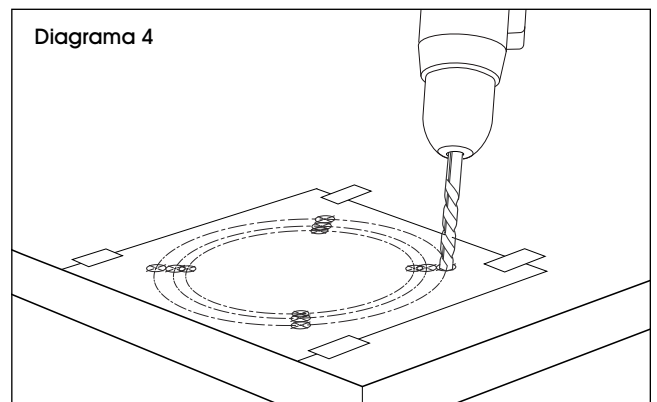

## CONTINUACIÓN DE INSTALACIÓN

5. Instale el tornillo de banco con cuatro pernos de cabeza hexagonal que sean 2" más largos que el grosor de la cubierta de la mesa. Utilice pernos de 7/16" de diámetro. (Vea Diagrama 5)
6. Asegure con rondanas y tuercas.

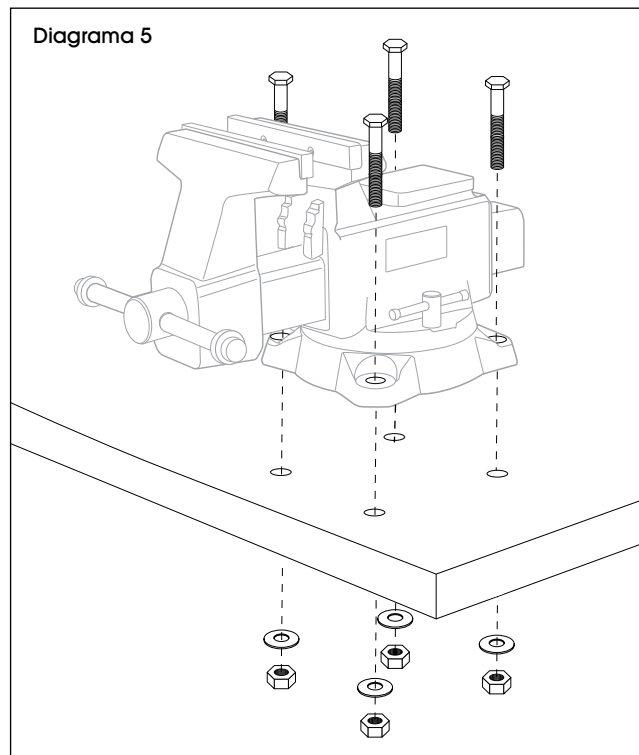

**ULINE H-7204**  
**WILTON<sup>MD</sup> – ÉTAU D'ÉTABLI**  
 N° DE MODÈLE WILTON 676U

1-800-295-5510  
 uline.ca

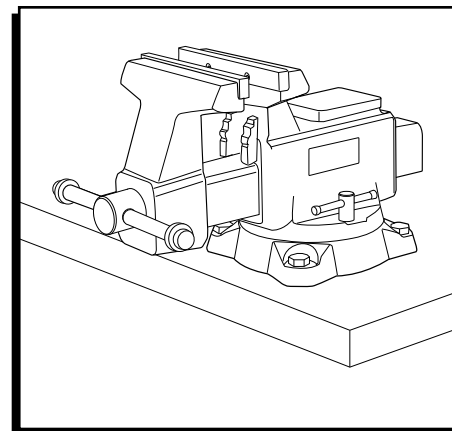

**OUTILS REQUIS**



Perceuse électrique



Mèche de perceuse de 7/16 po



Clé

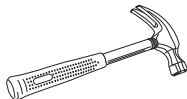

Marteau

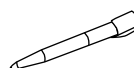

Pointeau

**INSTALLATION**

1. Sélectionnez le cercle 676U sur le modèle en papier fourni. (Voir Figure 1)

Figure 1

Modèle en papier

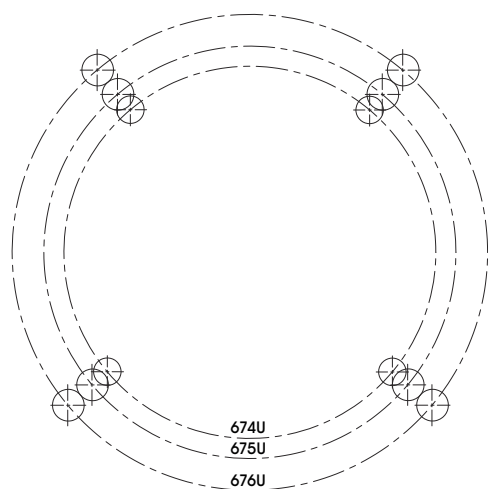

Le côté (plus large) est orienté vers le bord de l'établi.



2. Fixez le modèle en papier à l'aide de ruban adhésif. Veillez à ce que la base ne dépasse pas le bord de l'établi lorsqu'elle est montée. (Voir Figure 2)

Figure 2

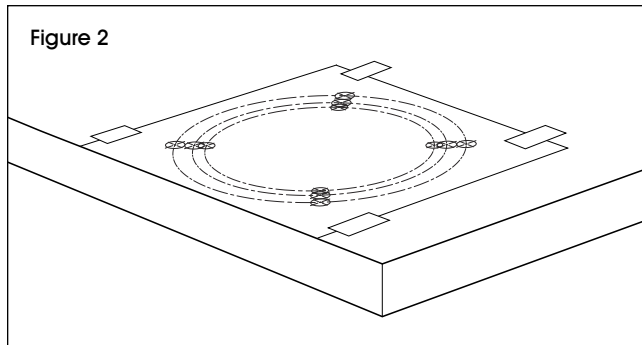

3. Percez le centre des quatre trous à l'aide d'une alène ou d'un pointeau. Veillez à ce que le dessous des trous pour boulons ne coïncide pas avec les pieds, les supports, les tiroirs, etc. (Voir Figure 3)

Figure 3

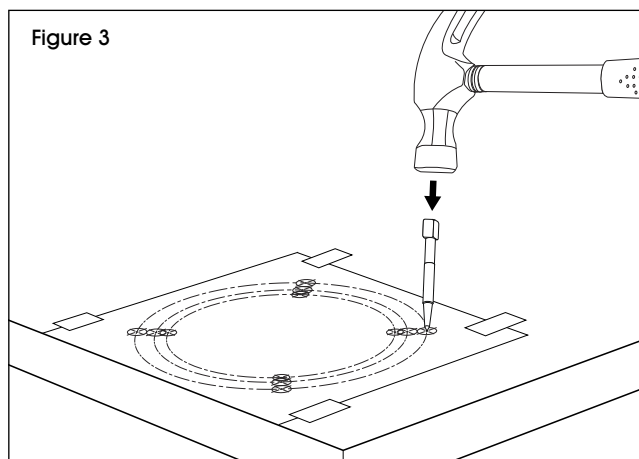

4. Percez quatre trous de 1/2 po de diamètre. (Voir Figure 4)

Figure 4

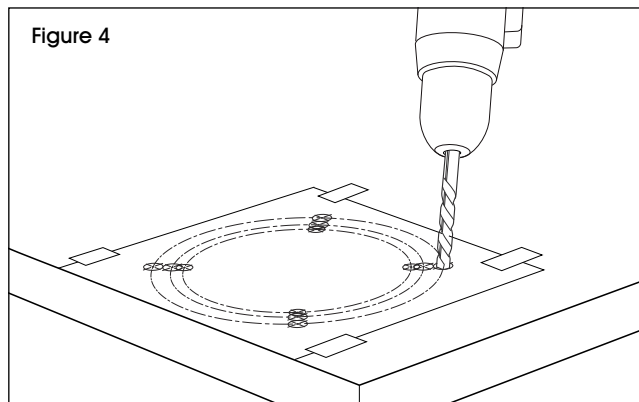

## INSTALLATION SUITE

5. Montez l'étau à l'aide de quatre boulons à tête hexagonale d'une longueur supérieure de 2 po à l'épaisseur de la table. Utilisez des boulons de 7/16 po de diamètre. (Voir Figure 5)
6. Fixez le tout à l'aide de rondelles et d'écrous.

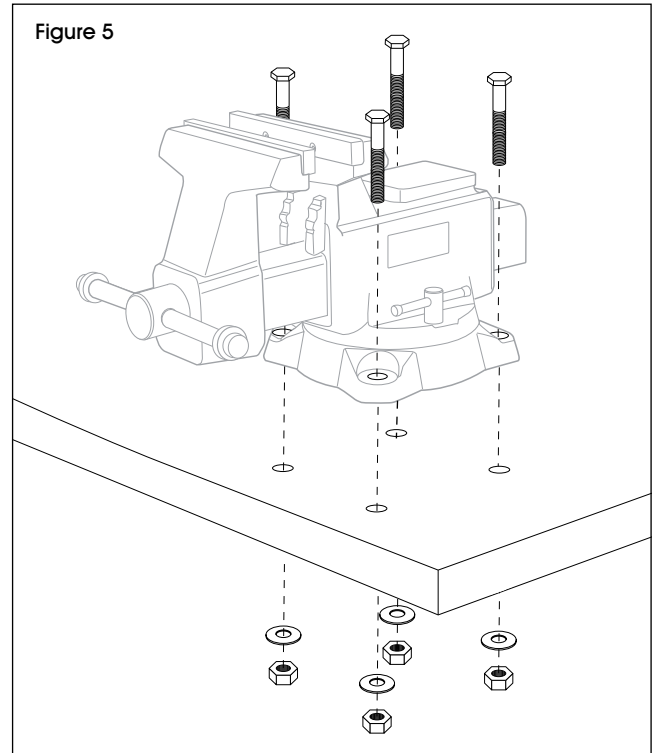

**ULINE**

1-800-295-5510  
uline.ca