

ULINE H-7628 DOWNTOWN MESH CHAIR

1-800-295-5510
uline.com

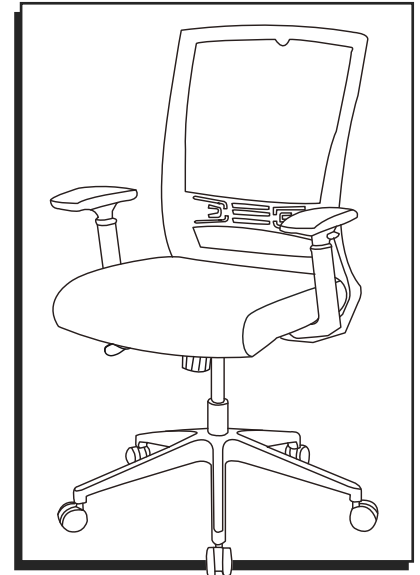

TOOL INCLUDED



PARTS

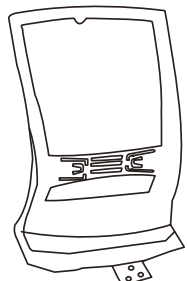

Back Support x 1



Seat Cushion x 1

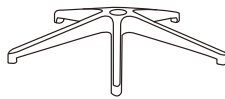

5-Star Base x 1



Caster x 5

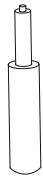

Gas Lift x 1

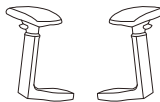

Armrest x 2

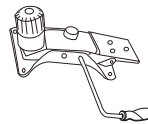

Mechanism x 1

Hardware Kit

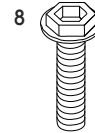

Screw x 6
1/4 x 1 1/2"

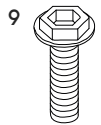

Screw x 4
1/4 x 1 1/4"

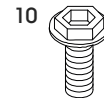

Screw x 3
5/16 x 7/8"



Washer x 6

ASSEMBLY

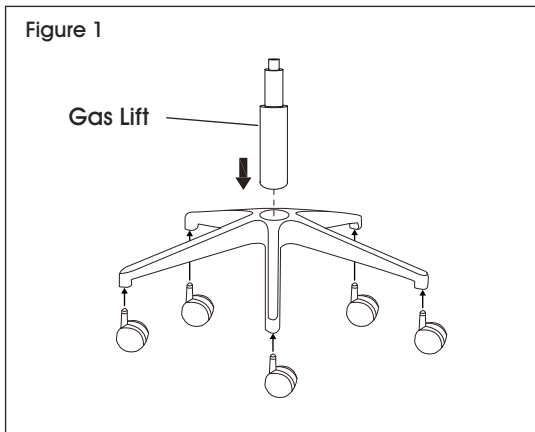

1. Turn base upside down. Insert casters into legs of five-star base. Turn base upright. Insert gas lift into center of base. (See Figure 1)

ASSEMBLY CONTINUED

Figure 2

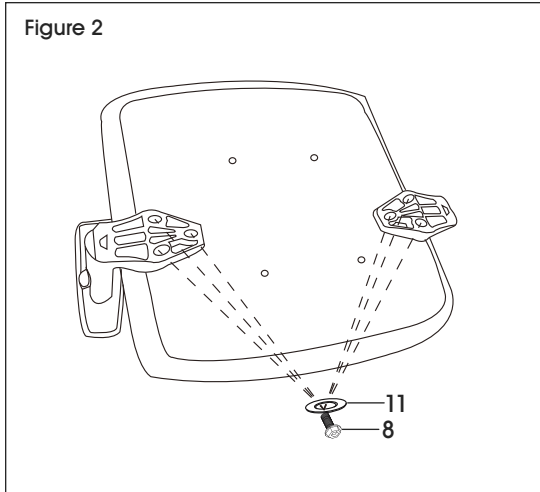

2. Align armrest with holes on bottom of seat cushion. Use three 1/4 x 1 1/2" screws (8) with three washers (11) to attach. Repeat on opposite side. (See Figure 2)

 **NOTE:** Use Allen wrench to tightly secure all screws.

Figure 3

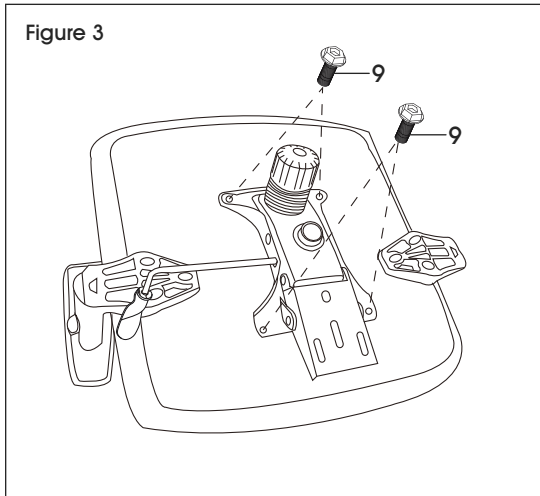

3. Align mechanism with holes on bottom of seat cushion with tension knob facing the front of seat. Use four 1/4 x 1 1/4" screws (9) to attach. (See Figure 3)

Figure 4

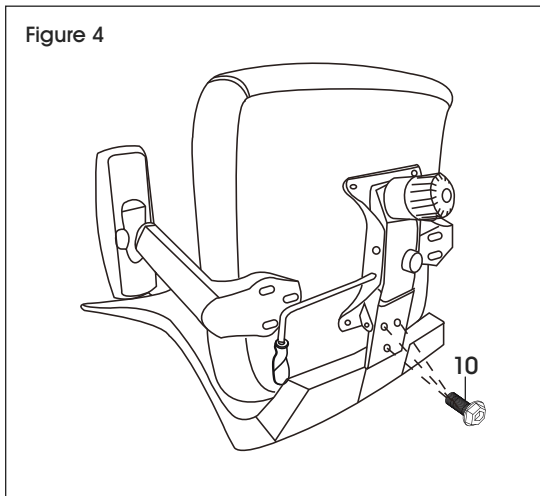

4. Position back support in slot on bottom of seat cushion. Align holes and use three 5/16 x 7/8" screws (10) to attach back support to mechanism. (See Figure 4)

ASSEMBLY CONTINUED

Figure 5

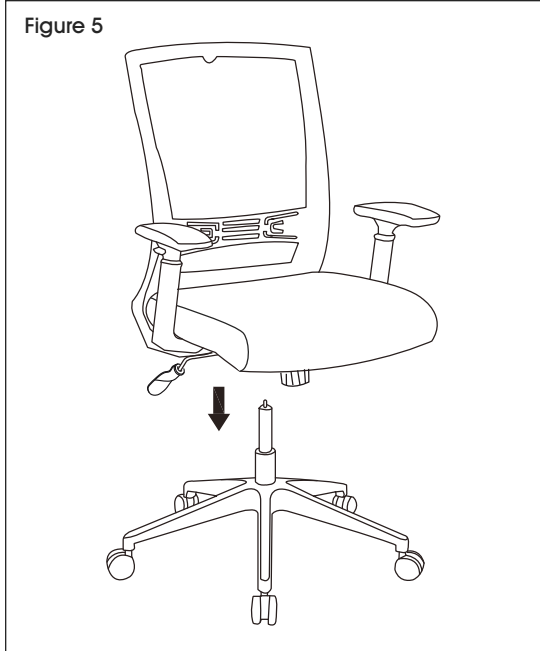

5. Slowly lower chair assembly onto the gas lift. Press down on seat cushion to secure. (See Figure 5)

CHAIR ADJUSTMENTS

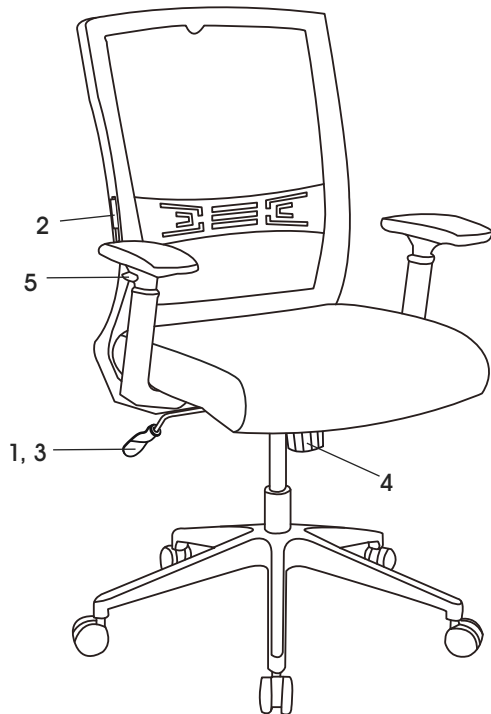

1. Seat Height Adjustment – To raise seat height, lift lever up with little to no weight on the seat. To lower seat height, lift lever up while sitting.
2. Lumbar Support – To position higher or lower on the back, slide the lumbar support up or down.
3. Upright Tilt Lock – To lock chair in an upright position, push the lever in toward the center of the seat. To restore tilt, pull lever out. Chair has synchro-tilt; the back tilts at a two-to-one ratio to the seat angle.
4. Tilt Tension – To increase tilt tension, turn knob clockwise. To decrease tilt tension, turn knob counterclockwise.
5. Armrest Height Adjustment – To adjust arm height, press the button on the side of each armrest and move the armrest up or down.

ULINE

1-800-295-5510

uline.com

ULINE H-7628
SILLA DE MALLA
URBANA

800-295-5510
 uline.mx

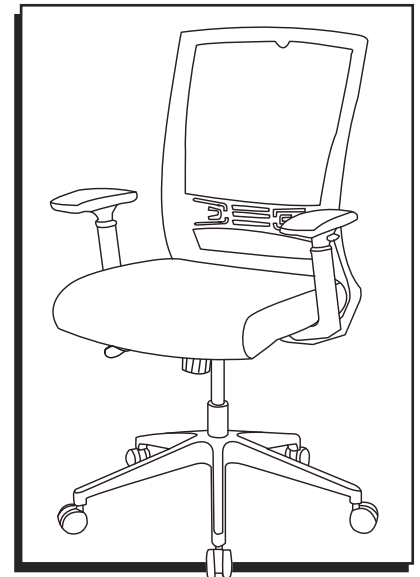

HERRAMIENTA INCLUIDA



Llave Allen

PARTES

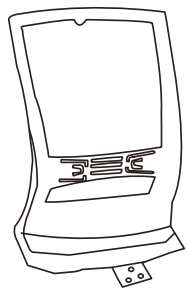

1 Respaldo



1 Asiento

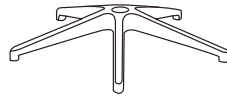

1 Base Estrella



5 Ruedas

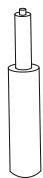

1 Pistón de Gas

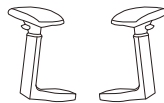

2 Descansabrazos

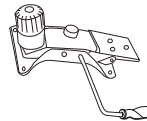

1 Mecanismo

Kit de Tornillería

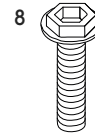

8
6 Tornillos
1/4 x 1 1/2"

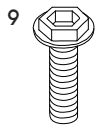

9
4 Tornillos
1/4 x 1 1/4"

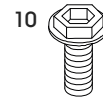

10
3 Tornillos
5/16 x 7/8"



11
6 Rondanas

ENSAMBLE

Diagrama 1

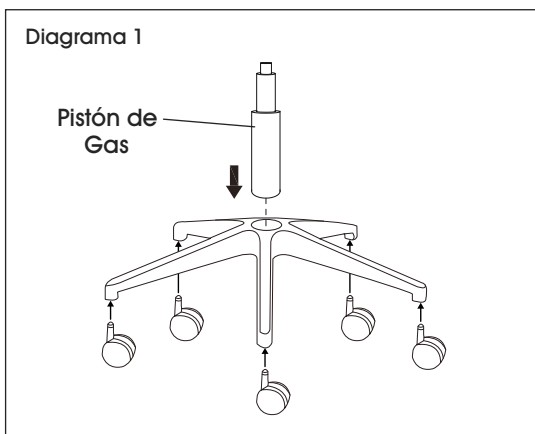

1. Voltee la base al revés. Inserte las ruedas en las patas de la base estrella. Voltee la base al derecho. Inserte el pistón de gas en el centro de la base. (Vea Diagrama 1)

CONTINUACIÓN DE ENSAMBLE

Diagrama 2

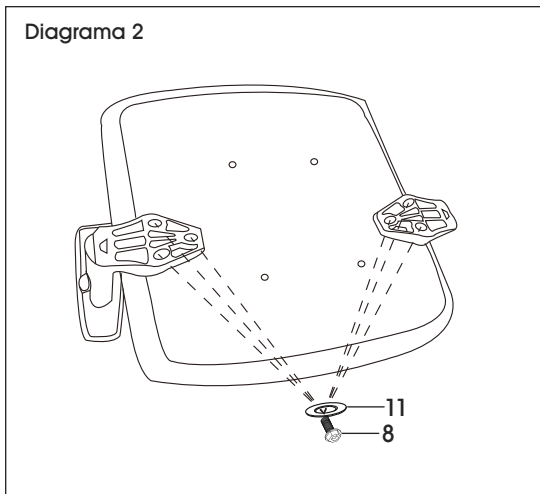

2. Alinee el descansabrazos con los orificios debajo del asiento. Use tres tornillos $1/4 \times 1/2$ " (8) con tres rondanas (11) para fijar. Repita en el lado opuesto. (Vea Diagrama 2)

 **NOTA:** Use la llave Allen para fijar bien todos los tornillos.

Diagrama 3

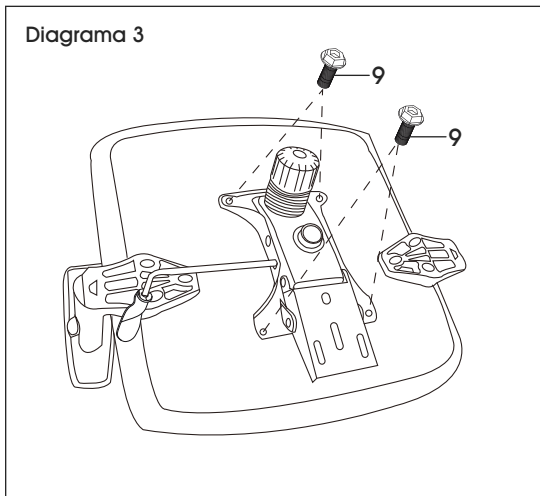

3. Alinee el mecanismo con los orificios debajo del asiento y con la perilla de tensión volteando hacia la parte frontal de éste. Use 4 tornillos $1/4 \times 1/4$ " (9) para fijar. (Vea Diagrama 3)

Diagrama 4

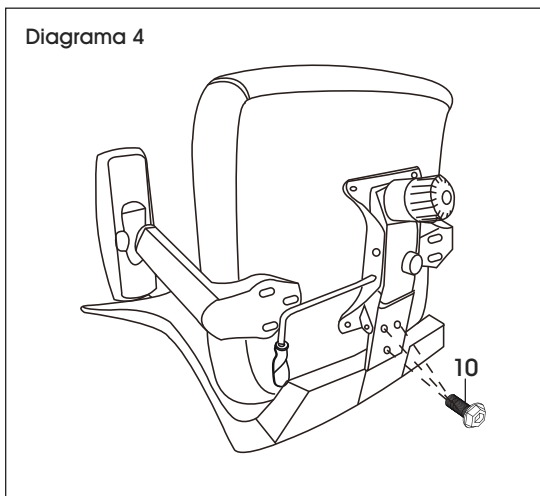

4. Posicione el respaldo en la ranura debajo del asiento. Alinee los orificios y use tres tornillos $5/16 \times 7/8$ " (10) para fijarlo al mecanismo. (Vea Diagrama 4)

CONTINUACIÓN DE ENSAMBLE

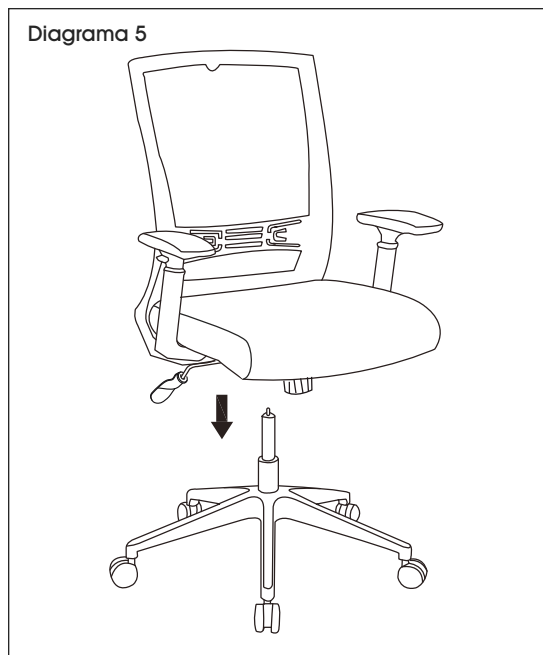

5. Baje lentamente el ensamble de la silla sobre el pistón de gas. Presione el asiento hacia abajo para asegurarlo. (Vea Diagrama 5)

AJUSTES DE LA SILLA

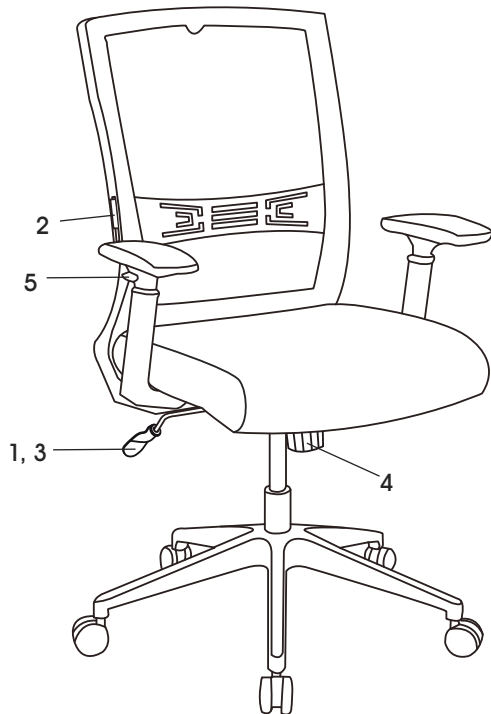

1. Ajuste de la Altura del Asiento – Para aumentar la altura del asiento, levante la palanca sin o con poco peso en el asiento. Para disminuir la altura del asiento, levante la palanca mientras esté sentado.
2. Soporte Lumbar – Para colocarlo en la parte alta o baja del respaldo, deslícelo hacia arriba o hacia abajo.
3. Bloqueo de la Inclinación del Poste – Para bloquear la silla en una posición vertical, empuje la palanca hacia el centro del asiento. Para restaurar la inclinación, jale la palanca. La silla cuenta con inclinación sincronizada; el respaldo se inclina en una proporción de dos a uno con respecto al ángulo del asiento.
4. Tensión de Inclinación – Para incrementar la tensión de la inclinación, gire la perilla en sentido de las manecillas del reloj. Para disminuir la tensión de la inclinación, gire la perilla en sentido contrario a las manecillas del reloj.
5. Ajuste de la Altura de los Descansabrazos – Para ajustar la altura de los brazos, presione el botón que está en los laterales de cada descansabrazos y mueva cada uno hacia arriba o hacia abajo.

ULINE

800-295-5510

uline.mx

ULINE H-7628

**DOWNTOWN –
CHAISE EN MAILLE**

1-800-295-5510

uline.ca

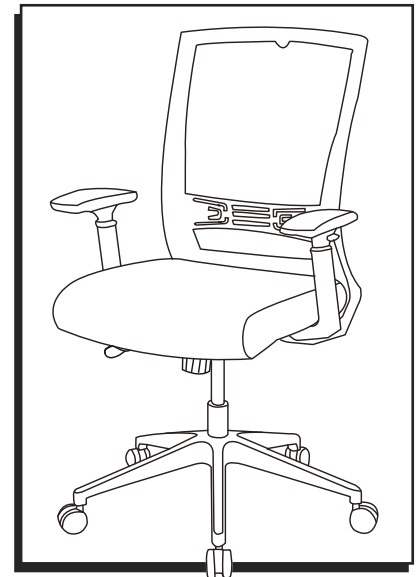

OUTIL INCLUS



Clé Allen

PIÈCES

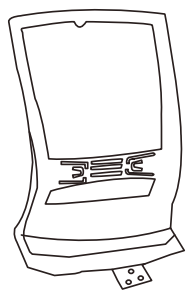

Dossier x 1



Siège x 1

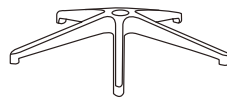

Base à 5 branches x 1



Roulette x 5

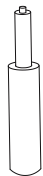

Vérin
pneumatique x 1

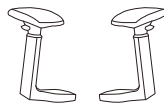

Accoudoir x 2

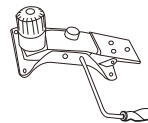

Mécanisme x 1

Matériel d'installation

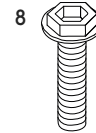

8
Vis x 6
1/4 x 1 1/2 po

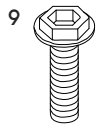

9
Vis x 4
1/4 x 1 1/4 po

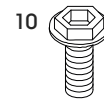

10
Vis x 3
5/16 x 7/8 po



11
Rondelle x 6

MONTAGE

Figure 1

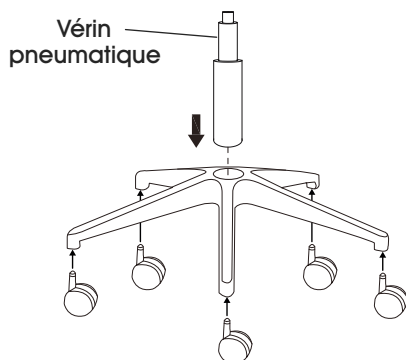

1. Placez la base à l'envers. Insérez les roulettes dans les pieds de la base à cinq branches. Placez la base à l'endroit. Insérez le vérin pneumatique dans le centre de la base. (Voir Figure 1)

MONTAGE SUITE

Figure 2

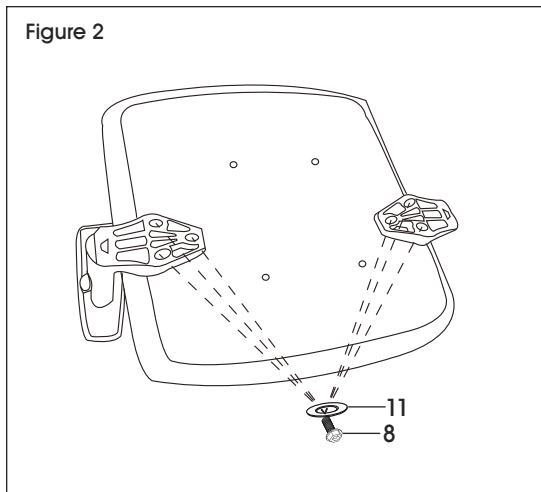

2. Alignez l'accoudoir avec les trous situés au bas du siège. Fixez avec trois vis de 1/4 x 1 1/2 po (8) et trois rondelles (11). Répétez la procédure sur le côté opposé. (Voir Figure 2)

 **REMARQUE :** Utilisez la clé Allen pour bien serrer toutes les vis.

Figure 3

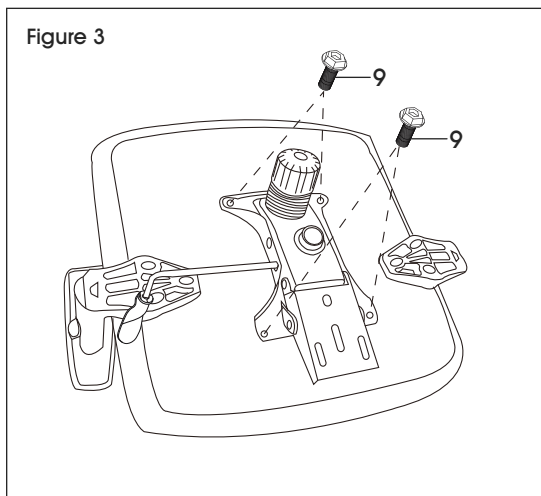

3. Alignez le mécanisme avec les trous situés au bas du siège, la molette de réglage de tension étant orienté vers l'avant du siège. Fixez avec quatre vis de 1/4 po x 1 1/4 po (9). (Voir Figure 3)

Figure 4

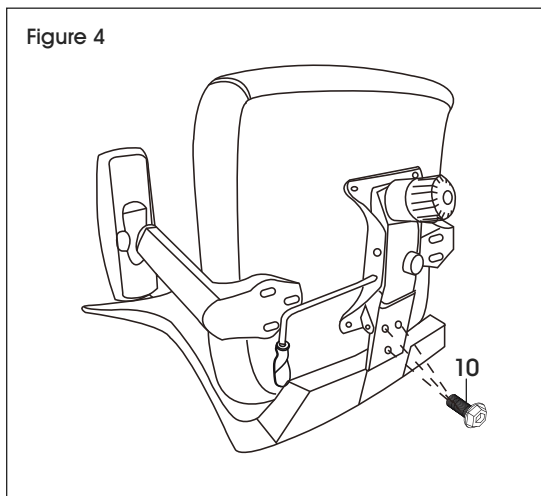

4. Insérez le dossier dans la fente située au bas du siège. Insérez trois vis de 5/16 x 7/8 po (10) pour fixer le dossier au mécanisme. (Voir Figure 4)

MONTAGE SUITE

Figure 5

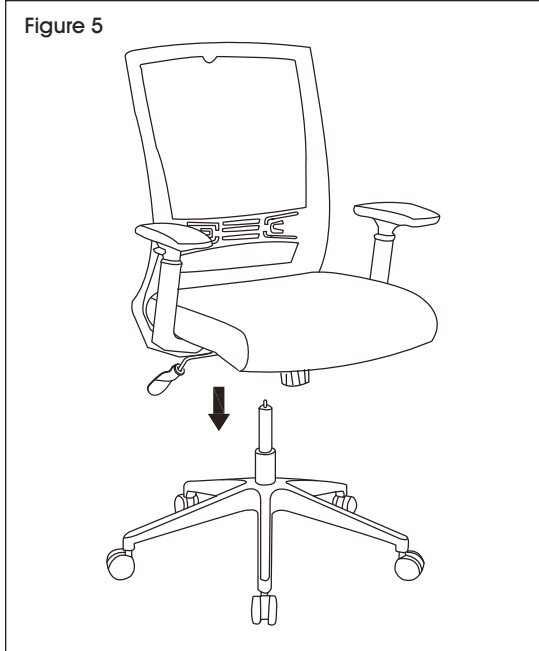

5. Abaissez lentement la chaise sur le vérin pneumatique. Appuyez sur le siège pour le fixer. (Voir Figure 5)

RÉGLAGES DE LA CHAISE

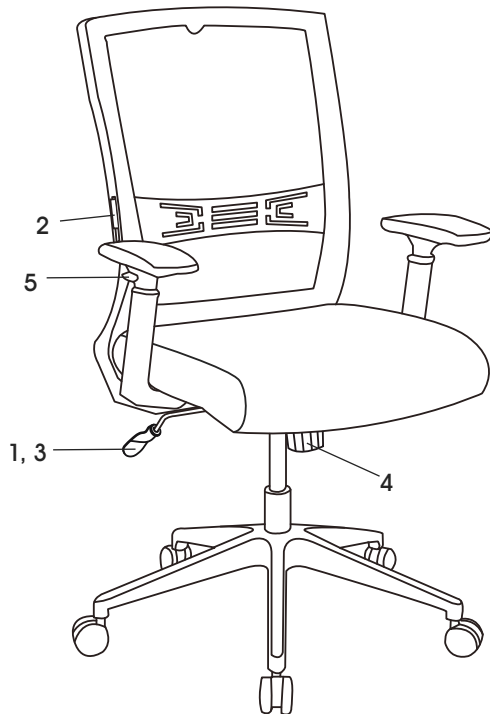

1. Réglage de la hauteur du siège – Pour élever la hauteur du siège, soulevez le levier avec peu ou sans poids sur le siège. Pour abaisser la hauteur du siège, soulevez le levier en position assise.
2. Soutien lombaire – Pour positionner le support lombaire plus haut ou plus bas sur le dos, glissez-le vers le haut ou vers le bas.
3. Inclinaison avec blocage en position verticale – Pour bloquer la chaise en position verticale, poussez le levier vers le centre du siège. Pour rétablir l'inclinaison, tirez le levier vers l'extérieur. La chaise comporte une inclinaison synchrone; l'angle d'inclinaison du dossier est de deux pour un par rapport à l'angle du siège.
4. Tension d'inclinaison – Pour augmenter la tension d'inclinaison, tournez la molette dans le sens horaire. Pour diminuer la tension d'inclinaison, tournez la molette dans le sens antihoraire.
5. Réglage de la hauteur des accoudoirs – Pour régler les accoudoirs en hauteur, appuyez sur le bouton situé sur le côté de chacun des accoudoirs, puis faites bouger ceux-ci de haut en bas.

ULINE

1-800-295-5510
uline.ca