

# ULINE H-7819

## VINYL SLED BASE CHAIR – BIG AND TALL

1-800-295-5510  
uline.com

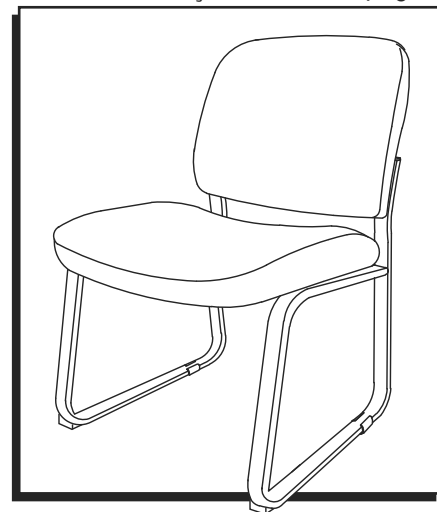

### TOOL NEEDED



Allen Wrench  
(included)

### PARTS

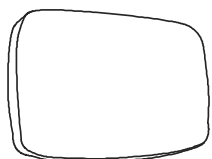

Back Cushion x 1



Seat Cushion x 1

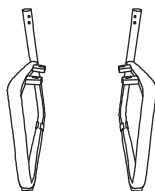

Leg x 2



Support Bar x 2

#### Hardware Kit

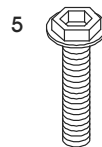

5

Screw x 4  
5/16 x 1 5/8"

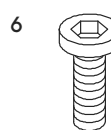

6

Screw x 2  
5/16 x 1"

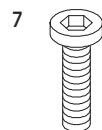

7

Screw x 2  
5/16 x 1 1/4"

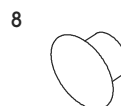

8

Plastic Cap x 4

### ASSEMBLY

Figure 1

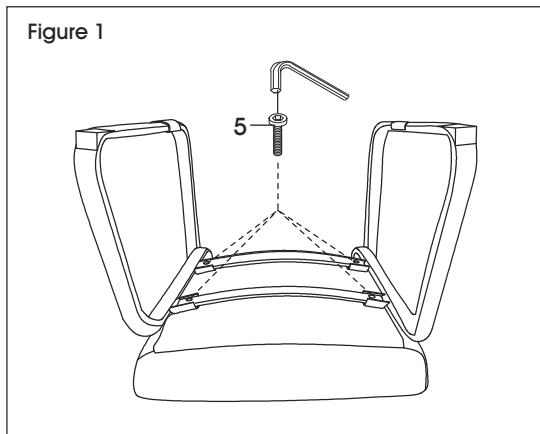

1. Align leg mounting brackets with holes on bottom of seat cushion. Insert support bars into mounting brackets and use two 5/16 x 1 5/8" screws (5) to loosely secure. Repeat on opposite side. (See Figure 1)



**NOTE:** Do not tighten screws until assembly is complete.

## ASSEMBLY CONTINUED

Figure 2

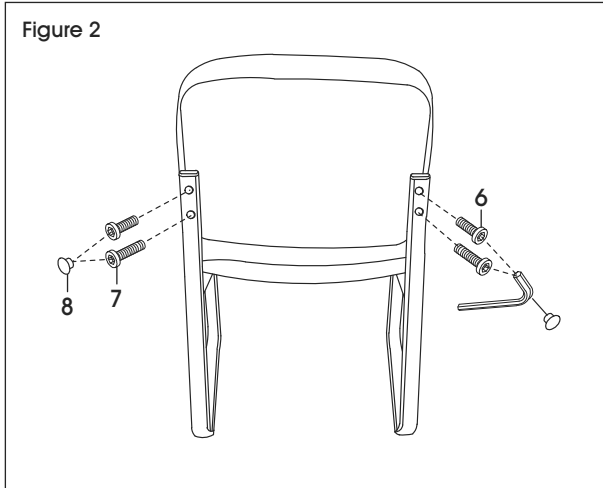

2. Align back cushion with mounting holes. Use one 5/16 x 1" screw (6) in top hole and one 5/16 x 1 1/4" screw (7) in bottom hole to loosely secure. Repeat on opposite side. (See Figure 2)



**NOTE:** Use Allen wrench to tighten all screws.

3. Insert plastic caps (8) in holes on back cushion to cover screws. (See Figure 2)

**ULINE**

1-800-295-5510  
uline.com

**ULINE** H-7819

# SILLA DE VINIL CON ARMAZÓN TIPO TRINEO – GRANDE Y ALTA

800-295-5510

uline.mx

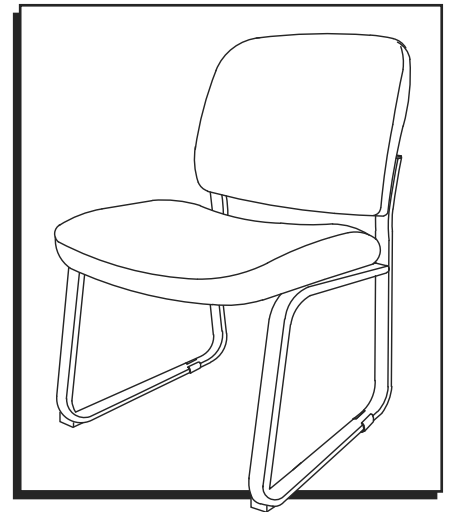

## HERRAMIENTA NECESARIA



Llave Allen  
(incluida)

## PARTES

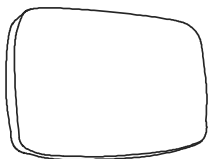

1 Respaldo



1 Asiento

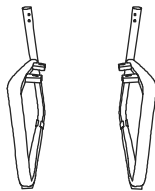

2 Patas

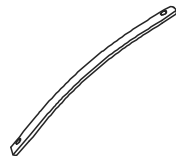

2 Barras de Soporte

### Kit de Tornillería

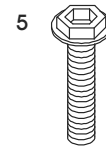

5

4 Tornillos  
5/16 x 1 5/8"

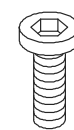

6

2 Tornillos  
5/16 x 1"

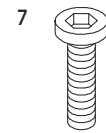

7

2 Tornillos  
5/16 x 1 1/4"



8

4 Tapas  
de Plástico

## ENSAMBLE

Diagrama 1

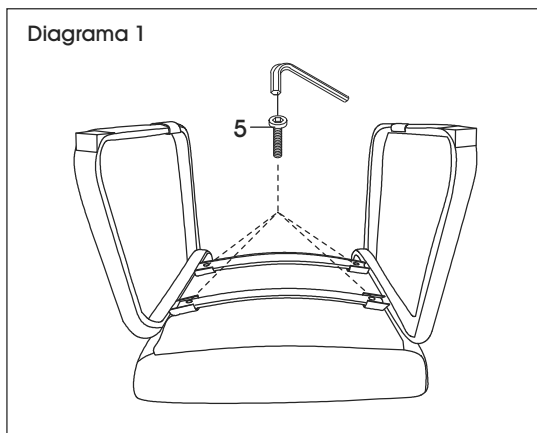

1. Alinee los soportes de instalación de las patas con los orificios de la parte inferior del asiento. Inserte las barras de soporte en los soportes de instalación y utilice dos tornillos de 5/16 x 1 5/8" (5) para asegurarlo sin apretar. Repita la operación en el lado opuesto. (Vea Diagrama 1)



**NOTA:** No apriete los tornillos hasta que termine de ensamblar.

## CONTINUACIÓN DEL ENSAMBLE

Diagrama 2

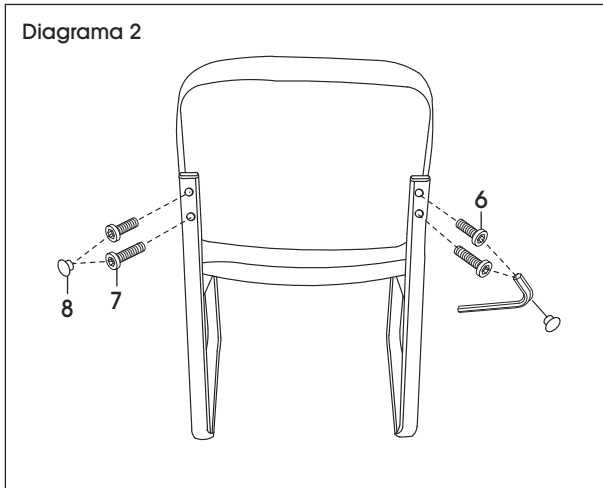

2. Alinee el respaldo con los orificios de instalación. Utilice un tornillo de 5/16 x 1" (6) en el orificio superior y un tornillo de 5/16 x 1¼" (7) en el orificio inferior para asegurarlo sin apretar. Repita la operación con el lado opuesto. (Vea Diagrama 2)

 **NOTA:** Utilice la llave Allen para apretar todos los tornillos.

3. Inserte las tapas de plástico (8) en los orificios del respaldo para cubrir los tornillos. (Vea Diagrama 2)

**ULINE**

800-295-5510  
uline.mx

**ULINE** H-7819

# CHAISE À BASE TRAÎNEAU EN VINYLE – TAILLES FORTES ET ÉLANCÉES

1-800-295-5510

uline.ca

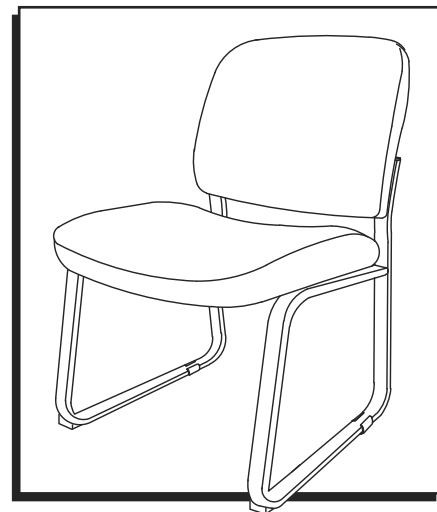

## OUTIL REQUIS



Clé Allen  
(inclus)

## PIÈCES

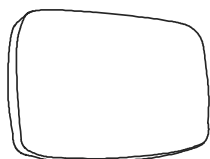

Dossier x 1



Siège x 1

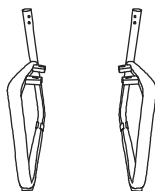

Pied x 2



Barre de soutien x 2

### Matériel d'installation

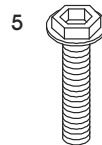

Vis x 4  
5/16 x 1 5/8 po

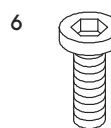

Vis x 2  
5/16 x 1 po

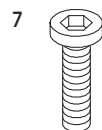

Vis x 2  
5/16 x 1 1/4 po

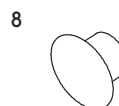

Capuchon en  
plastique x 4

## ASSEMBLAGE

Figure 1

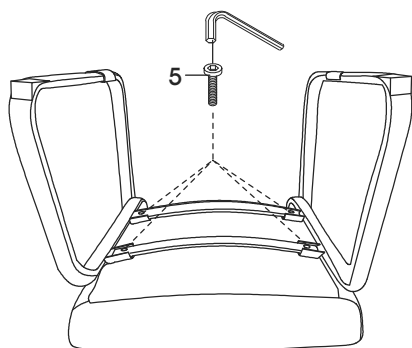

1. Alignez les supports de montage des pieds sur les trous situés sous le siège. Insérez les barres de soutien dans les supports de montage et fixez sans serrer avec deux vis de 5/16 x 1 5/8 po (5). Répétez la procédure sur le côté opposé. (Voir Figure 1)



**REMARQUE :** Attendez d'avoir terminé l'assemblage pour serrer complètement les vis.

## ASSEMBLAGE SUITE

Figure 2

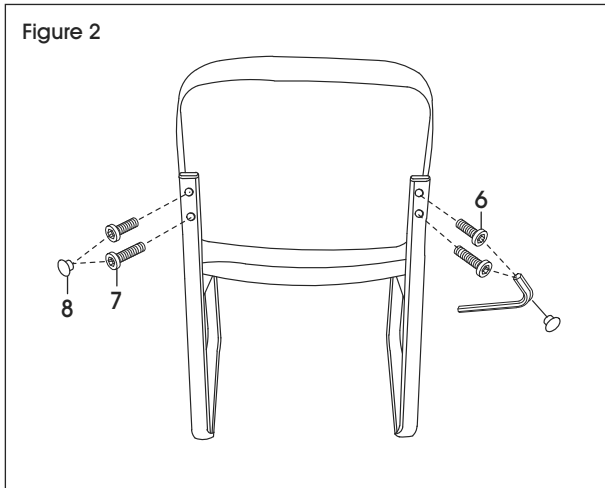

2. Alignez le dossier sur les trous de fixation. Utilisez une vis de 5/16 x 1 po (6) dans le trou supérieur et une vis de 5/16 x 1 ¼ po (7) dans le trou inférieur et fixez sans serrer. Répétez la procédure sur le côté opposé. (Voir Figure 2)

 **REMARQUE :** Utilisez la clé Allen pour serrer toutes les vis.

3. Insérez les capuchons en plastique (8) dans les trous du dossier pour couvrir les vis. (Voir Figure 2)

**ULINE**

1-800-295-5510  
uline.ca