

# ULINE H-7821 VINYL SLED BASE CHAIR

1-800-295-5510  
uline.com

Para Español, vea páginas 3-4.  
Pour le français, consulter la pages 5-6.

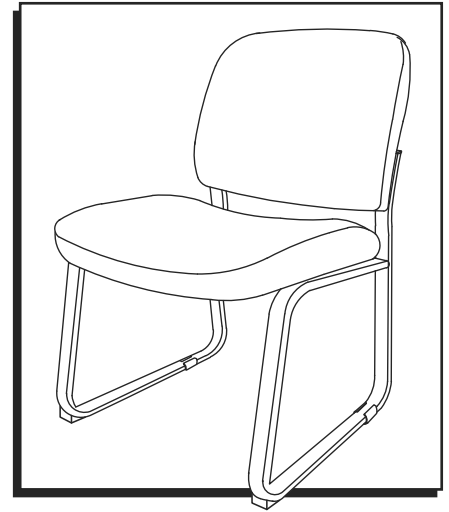

## TOOL NEEDED



Allen Wrench  
(included)

## PARTS

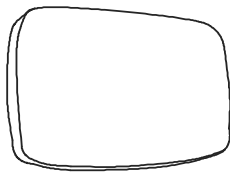

Back Cushion x 1



Seat Cushion x 1

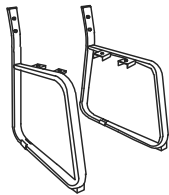

Leg x 2

### Hardware Kit

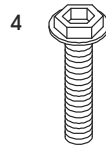

Screw x 4  
5/16 x 7/8"

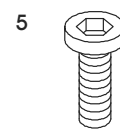

Screw x 2  
5/16 x 1"

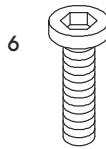

Screw x 2  
5/16 x 1 1/4"



Plastic Cap x 4

## ASSEMBLY

Figure 1

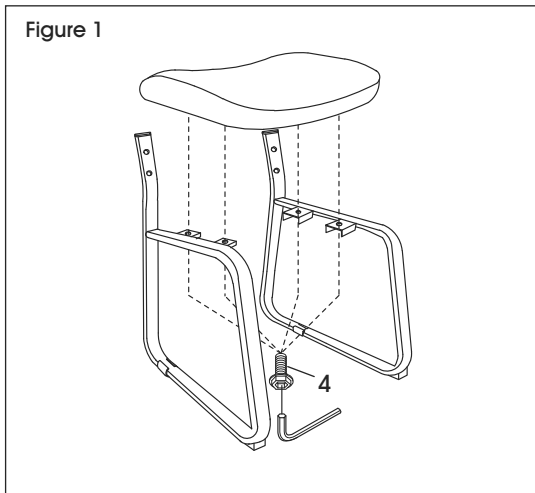

1. Align leg mounting plates with holes on bottom of seat cushion. Use two 5/16 x 7/8" screws (4) to loosely secure. Repeat on opposite side. (See Figure 1)



**NOTE:** Do not tighten screws until assembly is complete.

## ASSEMBLY CONTINUED

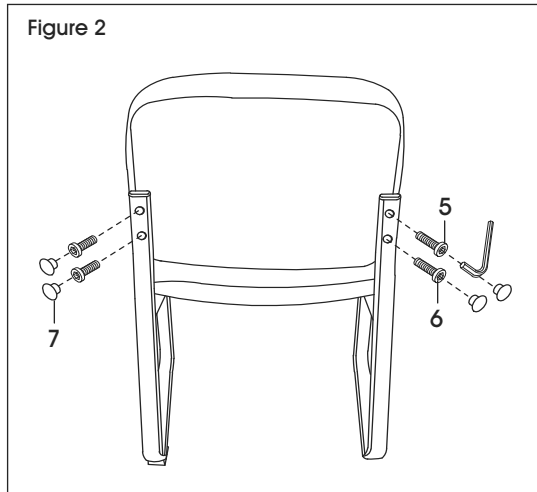

2. Align back cushion with mounting holes. Use one 5/16 x 1" screw (5) in top hole and one 5/16 x 1/4" screw (6) in bottom hole to loosely secure. Repeat on opposite side. (See Figure 2)

 **NOTE:** Use Allen wrench to tighten all screws.

3. Insert plastic caps (7) in holes on back cushion to cover screws. (See Figure 2)

**ULINE**

1-800-295-5510  
uline.com

**ULINE** H-7821

# SILLA DE VINIL CON ARMAZÓN TIPO TRINEO

800-295-5510  
uline.mx

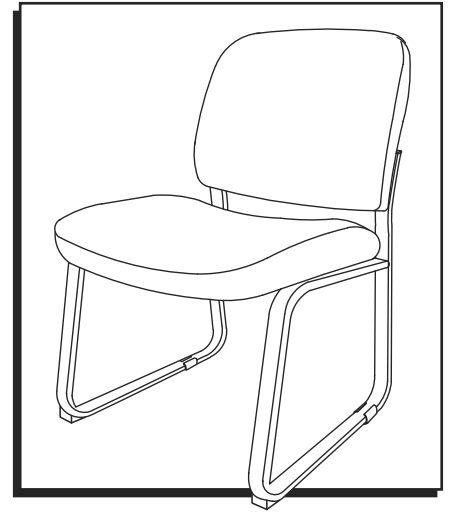

## HERRAMIENTA NECESARIA



Llave Allen  
(incluida)

## PARTES

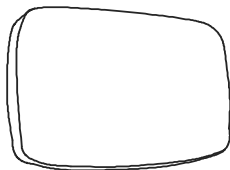

1 Respaldo



1 Asiento

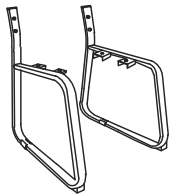

2 Patas

Kit de Tornillería

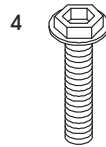

4 Tornillos  
5/16 x 7/8"

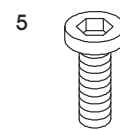

2 Tornillos  
5/16 x 1"

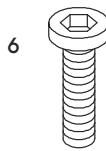

2 Tornillos  
5/16 x 1 1/4"



4 Tapas  
de Plástico

## ENSAMBLE

Diagrama 1

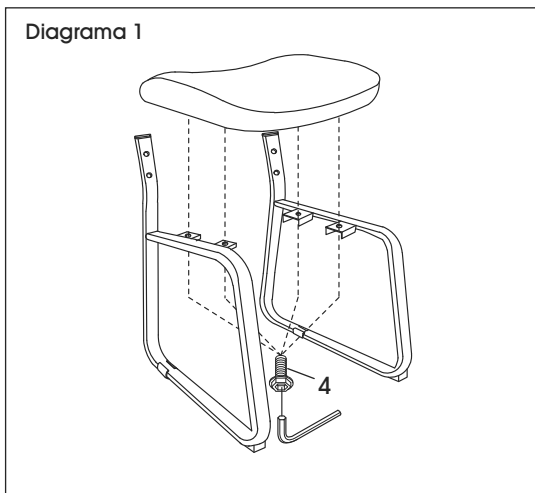

1. Alinee las placas de instalación de las patas con los orificios en la parte inferior del asiento. Utilice dos tornillos de 5/16 x 7/8" (4) para asegurarlo sin apretar. Repita la operación con el lado opuesto. (Vea Diagrama 1)



**NOTA:** No apriete los tornillos hasta que termine de ensamblar.

## CONTINUACIÓN DEL ENSAMBLE

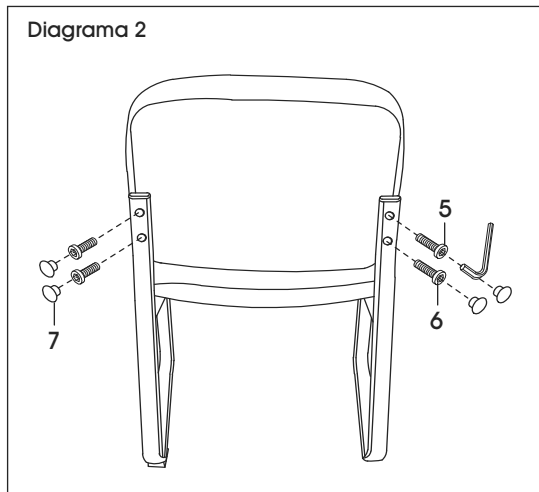

2. Alinee el respaldo con los orificios de instalación. Utilice un tornillo de 5/16 x 1" (5) en el orificio superior y un tornillo de 5/16 x 1 1/4" (6) en el orificio inferior para asegurarlo sin apretar. Repita la operación con el lado opuesto. (Vea Diagrama 2)

 **NOTA:** Utilice la llave Allen para apretar todos los tornillos.

3. Inserte las tapas de plástico (7) en los orificios del respaldo para cubrir los tornillos. (Vea Diagrama 2)

**ULINE**

800-295-5510  
uline.mx

**ULINE** H-7821

1-800-295-5510

uline.ca

# CHAISE À BASE TRAÎNEAU EN VINYLE

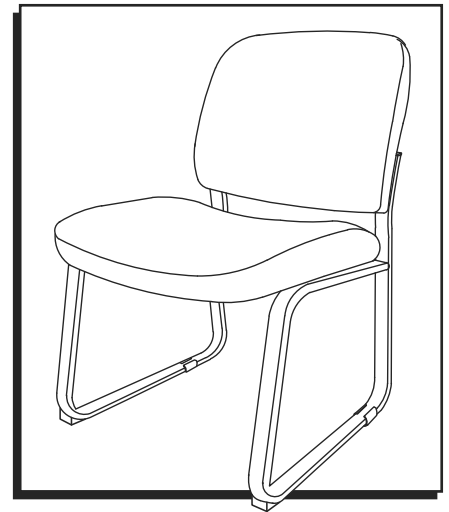

## OUTIL REQUIS



Clé Allen  
(inclus)

## PIÈCES

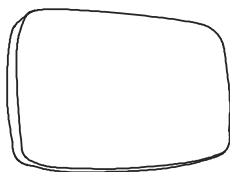

Dossier x 1



Siège x 1

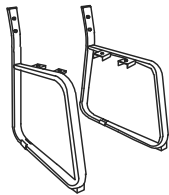

Pied x 2

### Matériel de fixation

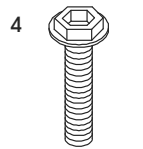

Vis x 4  
5/16 x 7/8 po

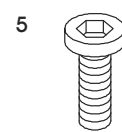

Vis x 2  
5/16 x 1 po

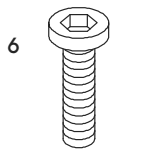

Vis x 2  
5/16 x 1 1/4 po



Capuchon en  
plastique x 4

## ASSEMBLAGE

Figure 1

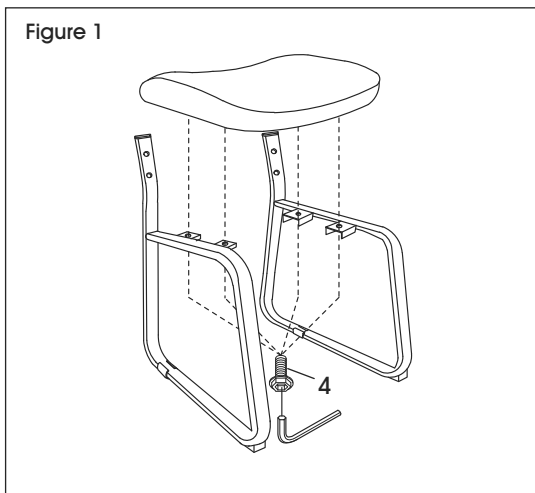

1. Alignez les trous des plaques de montage des pieds contre ceux de la partie inférieure du siège. À l'aide de deux vis de 5/16 x 7/8 po (4), fixez sans serrer. Répétez la procédure sur le côté opposé. (Voir Figure 1)



**REMARQUE :** Attendez d'avoir terminé l'assemblage pour serrer complètement les vis.

## ASSEMBLAGE SUITE

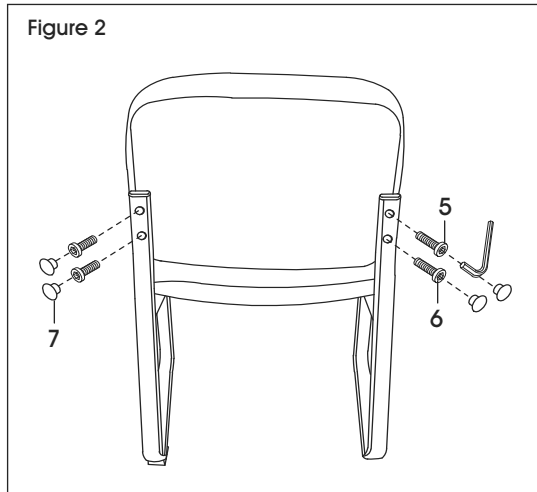

2. Alignez le dossier sur les trous de fixation. Utilisez une vis de 5/16 x 1 po (5) dans le trou supérieur et une vis de 5/16 x 1 1/4 po (6) dans le trou inférieur, puis fixez sans serrer. Répétez la procédure sur le côté opposé. (Voir Figure 2)



**REMARQUE :** Utilisez la clé Allen pour serrer toutes les vis.

3. Insérez les capuchons en plastique (7) dans les trous du dossier pour couvrir les vis. (Voir Figure 2)

**ULINE**

1-800-295-5510  
uline.ca