

ULINE H-8423-LOCKQ

LOCK AND KEYS FOR MODULAR DRAWER CABINETS

1-800-295-5510
uline.com

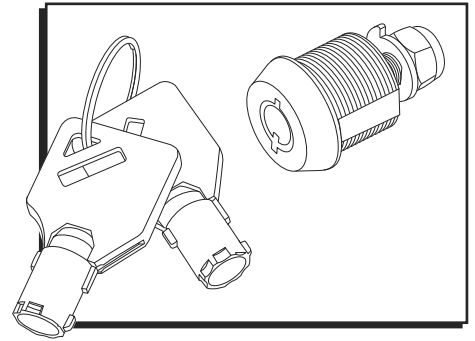

TOOLS NEEDED

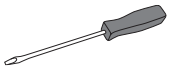

Flathead
Screwdriver

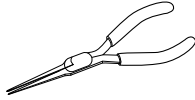

Needlenose
Pliers



7/16" Wrench

ASSEMBLY

REMOVE TOP DRAWER

1. Unlock cabinet with provided key. (See Figure 1)

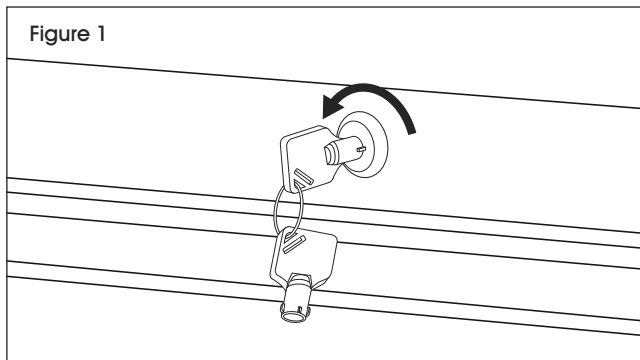

2. Open top drawer as far as it will go. (See Figure 2)

 **NOTE:** Only one drawer can be opened at a time.

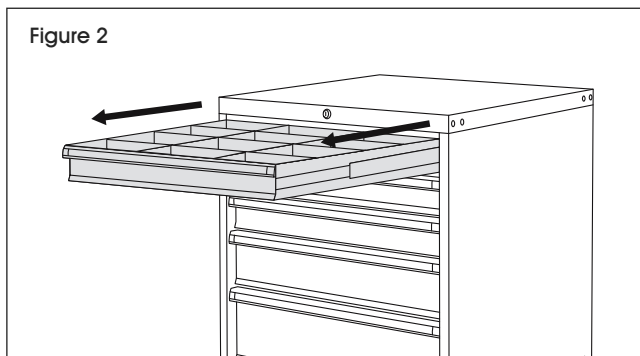

3. Pull latch on extended drawer slide outward and up. Repeat on opposite side. (See Figure 3)

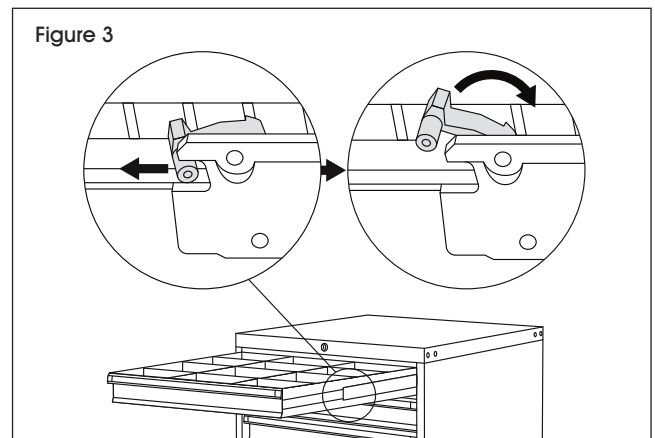

4. Lift drawer up and out of cabinet. (See Figure 4)

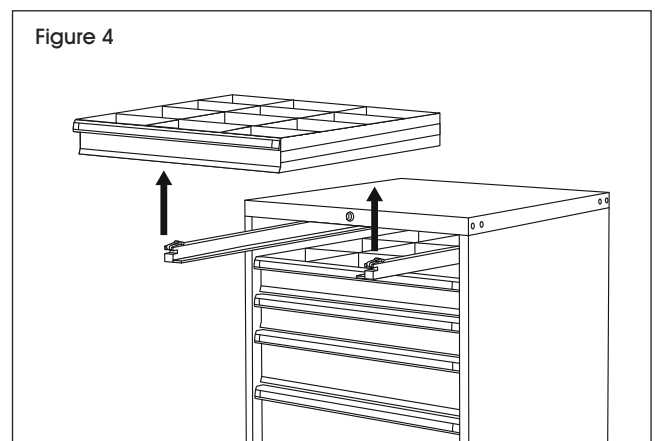

ASSEMBLY CONTINUED

5. Remove some width dividers in the second drawer to create more working space inside the cabinet. (See Figure 5)

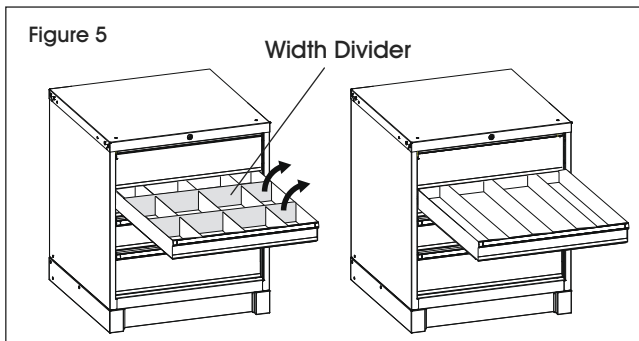

REPLACE THE LOCK

1. Using needlenose pliers or a small flathead screwdriver, carefully remove the lock cylinder clip on the inside of the cabinet holding the lock cylinder in place. (See Figure 6)

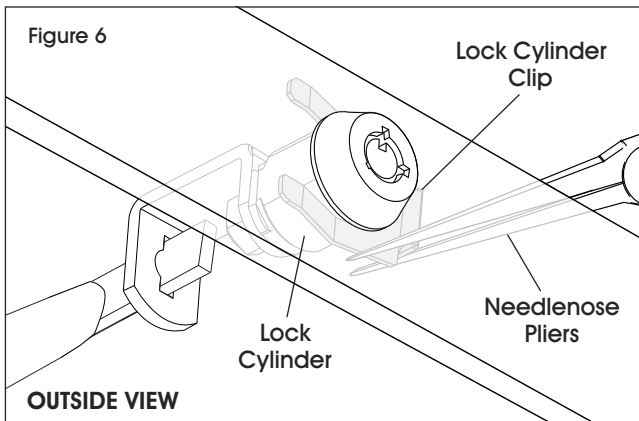

2. Pull the metal axle bar out of the steel U-bracket at the front of the cabinet. (See Figure 7)

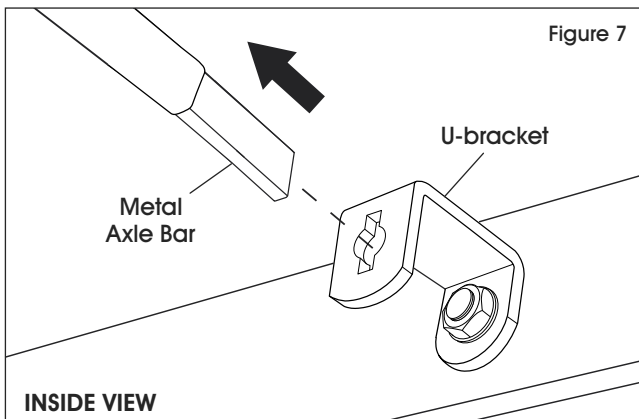

3. With the lock cylinder clip removed and the bar removed from the U-bracket, pull the lock cylinder and U-bracket out through the front of the cabinet in one piece. (See Figures 8-13)

 **NOTE:** Rotate the assembly at various angles to remove it through the front hole.

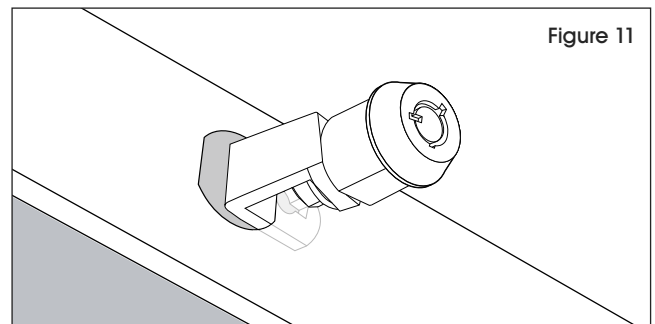
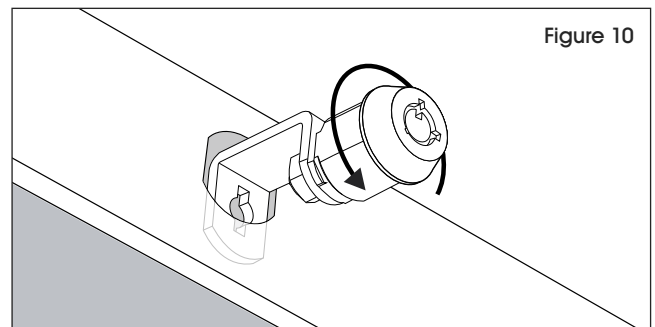
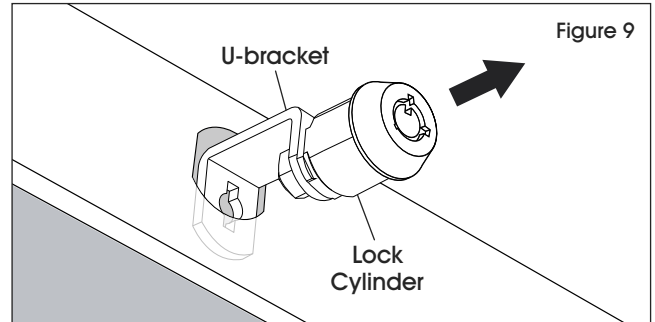
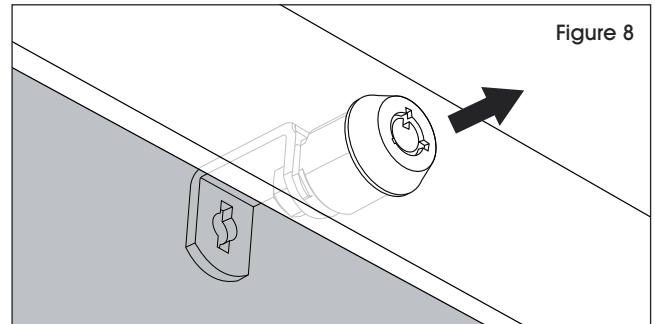

ASSEMBLY CONTINUED

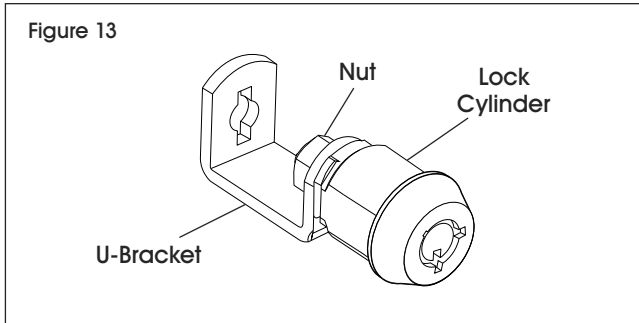
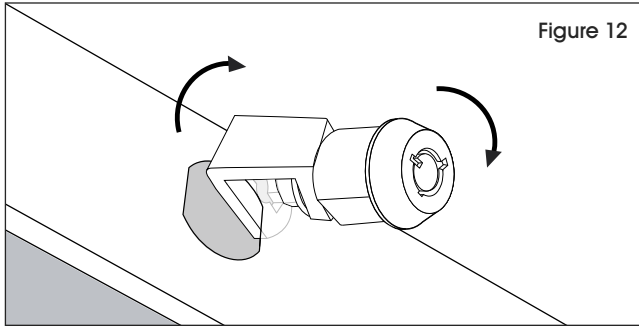

- Using a 7/16" wrench, unscrew the nut that is holding the lock cylinder in place. Note the orientation of the lock, blocking washer and U-bracket. Replace with the new lock cylinder and blocking washer. Tighten the nut back in place using the wrench. (See Figure 14)

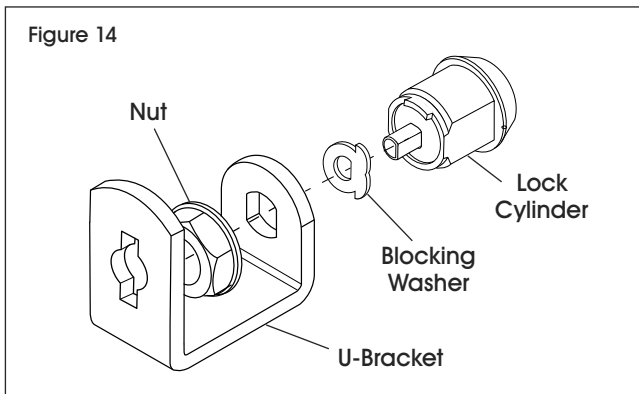

- Test the lock with keys to ensure it is functioning and that the orientation of the blocking washer is correct.
- Reverse the removal process by working the lock cylinder and U-bracket back through the hole and put the metal axle bar back in place through the steel U-bracket.
- Secure lock cylinder clip in place.

- Reinsert width dividers in the second drawer. (See Figure 15)

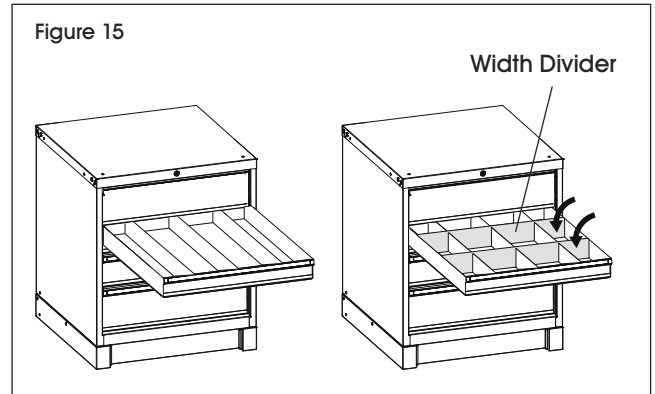

REPLACE TOP DRAWER

- Pull drawer slides fully out of cabinet. (See Figure 16)



NOTE: Only one set of drawer slides can be opened at a time.



NOTE: Latches on drawer slides should be in the "up" position.

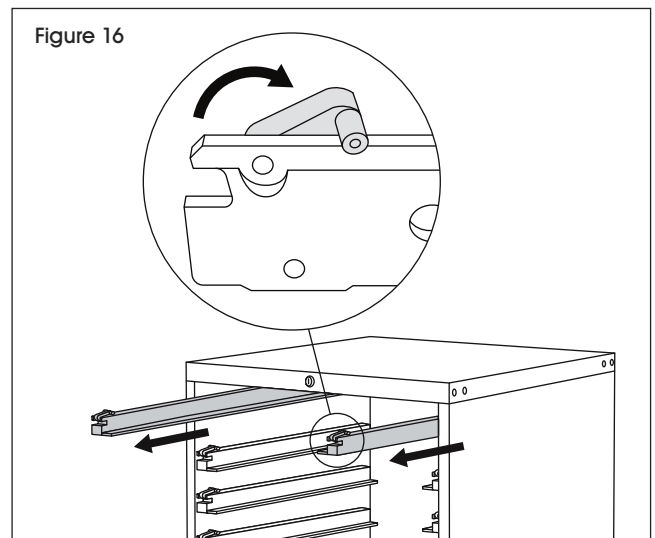

ASSEMBLY CONTINUED

2. Slide drawer onto drawer slides. (See Figure 17)



NOTE: It is recommended to have one person hold the drawer slides in place while drawer is installed.



NOTE: Drawer slides must remain fully extended as drawer is installed on drawer slides.

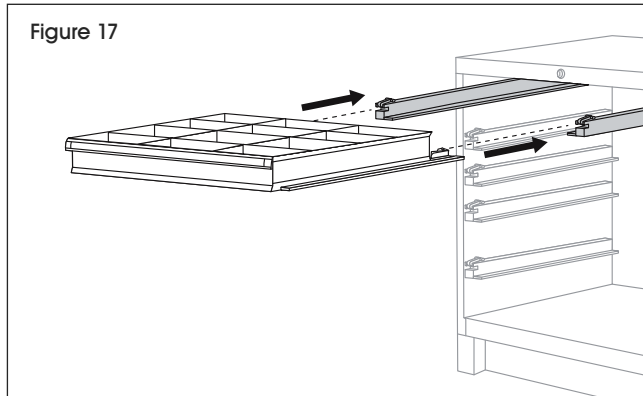

3. With drawer fully installed on drawer slides, flip slide latch down and lock into place. Repeat on opposite side. (See Figure 18)

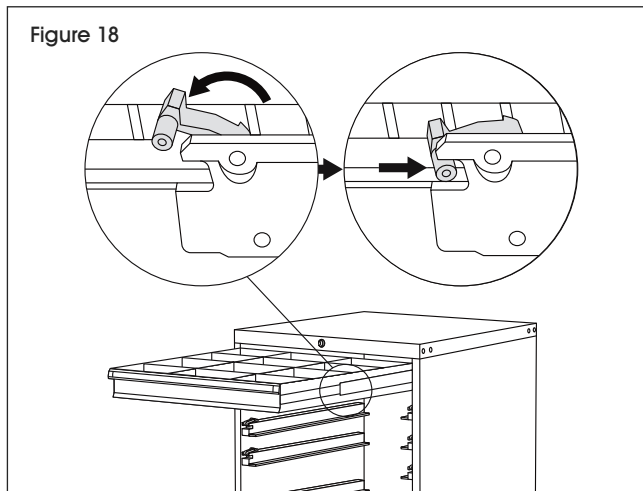

4. Push drawer fully into cabinet. (See Figure 19)

