

ULINE H-6745GR

SIX TIER LOCKER

1 WIDE – GRAY

1-800-295-5510
 uline.com

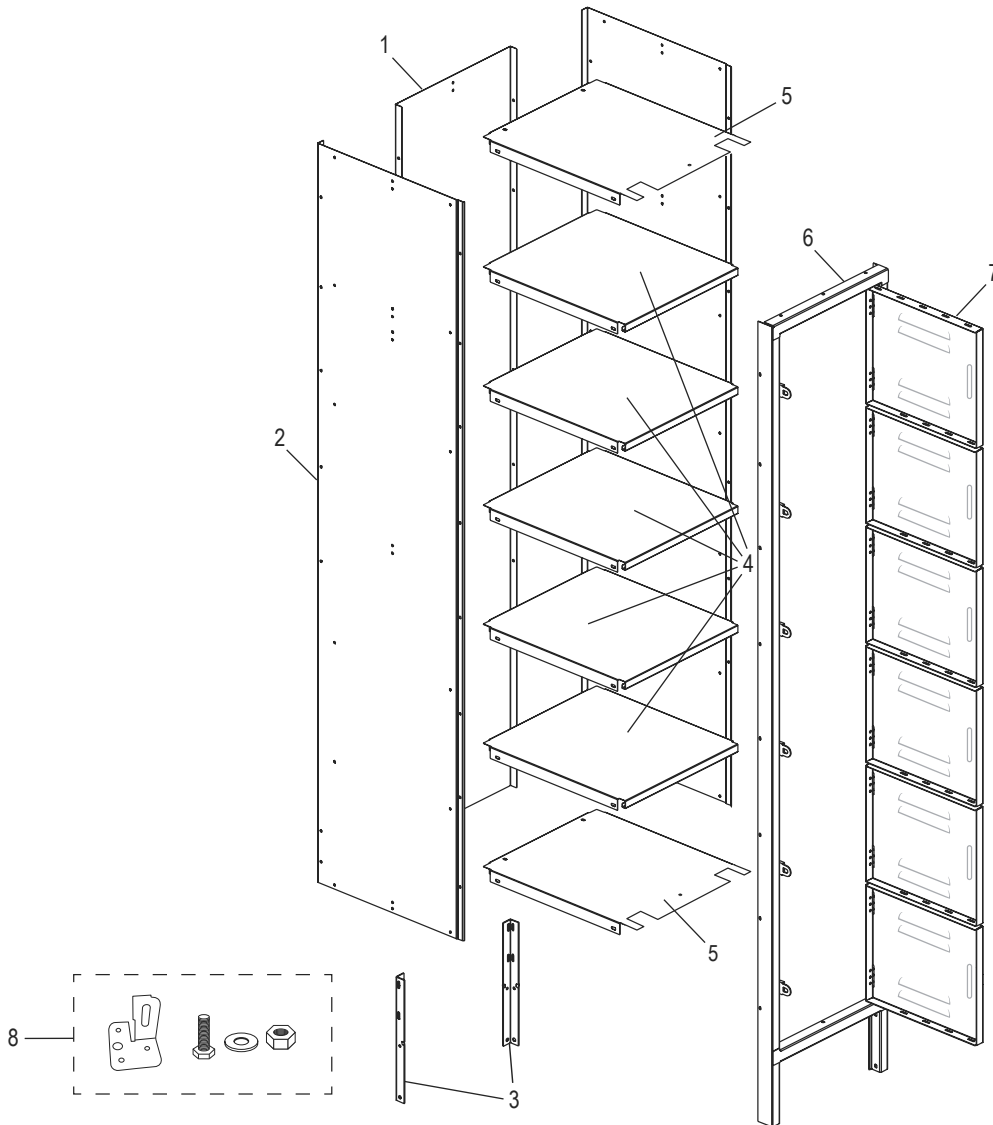
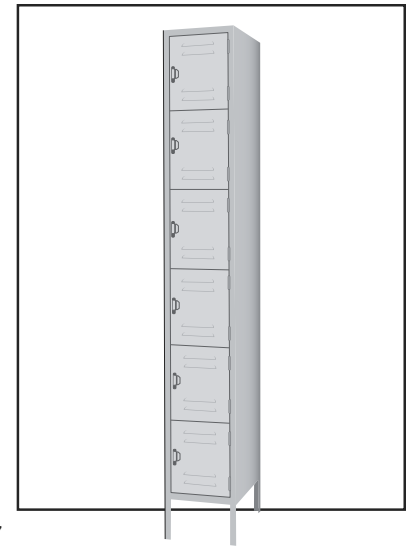

#	DESCRIPTION	QTY.	ULINE PART NO.	MFG. PART NO.
1	Back	1	-----	A11227BCJ04-GRAY
2	Side	2	H-4291-GSPQ	A11827BCJ03-GRAY
3	Rear Leg	2	H-7148	A11227BCJ10-GRAY
4	Shelf	5	-----	A11827BCJ07-GRAY
5	Top/Bottom Shelves	2	-----	A11827BCJ05-06-GRAY
6	Door Frame Assembly	1	H-4291GRASSM	12-78JJ6MMK-GRAY
7	Locker Door	6	-----	018-AD61227BCJ02-GRAY
8	Leveling Foot with Hardware	4	H-5997	018-DMGTZJ
	Hardware Pack (Not Shown)	1	H-4291HRDW	-----

ULINE H-6745GR
LOCKER DE SEIS PUERTAS
UNO DE ANCHO – GRIS

800-295-5510
 uline.mx

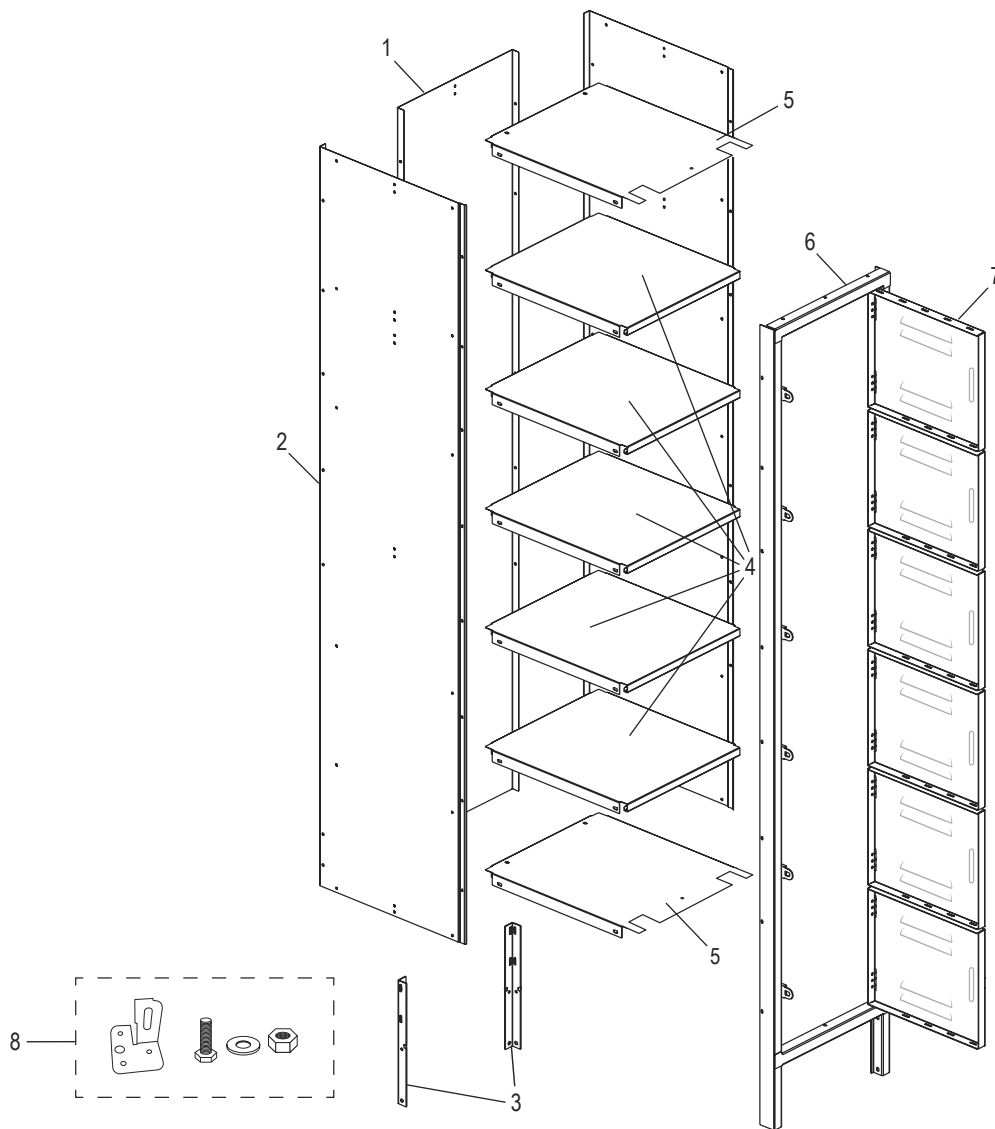
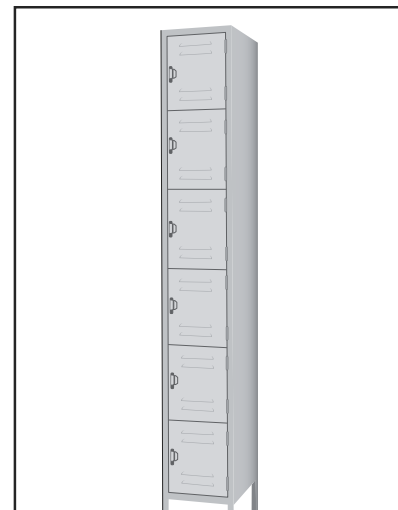

#	DESCRIPCIÓN	CANT.	NO. DE PARTE DE ULINE	NO. DE PARTE DEL FABRICANTE
1	Parte Trasera	1	-----	A11227BCJ04-GRAY
2	Lado	2	H-4291-GSPQ	A11827BCJ03-GRAY
3	Pata Trasera	2	H-7148	A11227BCJ10-GRAY
4	Repisa	5	-----	A11827BCJ07-GRAY
5	Repisas Superiores/Inferiores	2	-----	A11827BCJ05-06-GRAY
6	Ensamble de la Estructura de la Puerta	1	H-4291GRASSM	12-78JJ6MMK-GRAY
7	Puerta del Locker	6	-----	018-AD61227BCJ02-GRAY
8	Pata Niveladora con Herrajes	4	H-5997	018-DMGTZJ
	Paquete de Tornillería (No se Muestra)	1	H-4291HRDW	-----

ULINE H-6745GR
CASIER À SIX RANGÉES
UN DE LARGE – GRIS

1-800-295-5510
 uline.ca

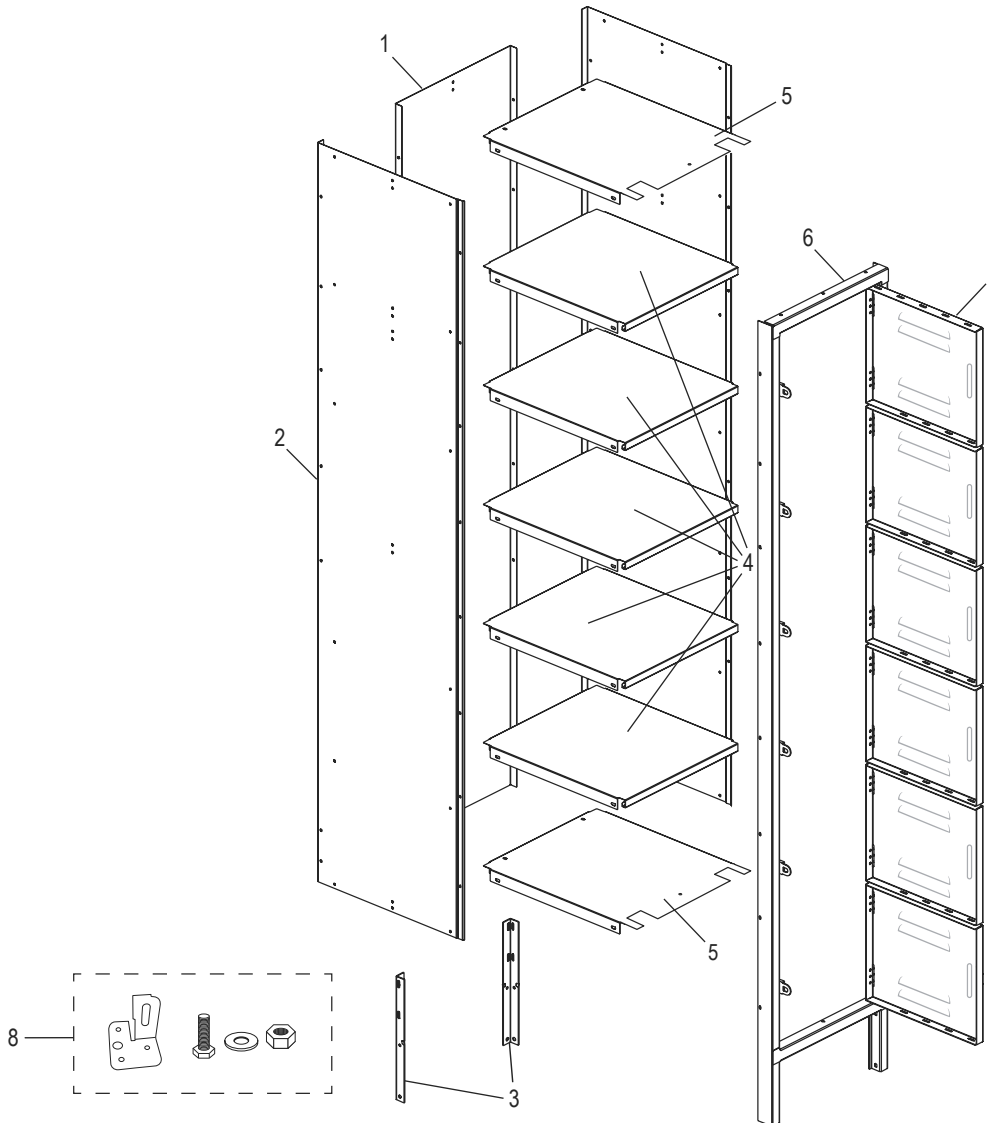
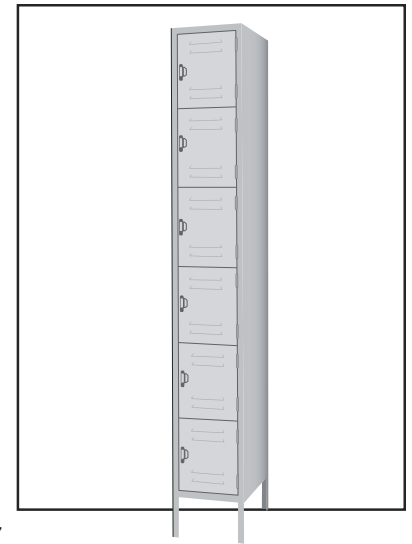

#	DESCRIPTION	QTÉ	RÉF. ULINE	RÉF. DU FABRICANT
1	Arrière	1	-----	A11227BCJ04-GRAY
2	Panneau latéral	2	H-4291-GSPQ	A11827BCJ03-GRAY
3	Patte arrière	2	H-7148	A11227BCJ10-GRAY
4	Tablette	5	-----	A11827BCJ07-GRAY
5	Tablettes supérieure et inférieure	2	-----	A11827BCJ05-06-GRAY
6	Cadre de la porte	1	H-4291GRASSM	12-78JJ6MMK-GRAY
7	Porte de l'armoire-vestiaire	6	-----	018-AD61227BCJ02-GRAY
8	Patte de nivellement avec quincaillerie	4	H-5997	018-DMGTZJ
	Matériel d'installation (non illustré)	1	H-4291HRDW	-----