

QUALIFICATION REPORT – ANSI/ESD S20.20

ADJUSTABLE ELASTIC WRIST STRAP

ANSI/ESD S20.20	HETEK Test Results	Test Methods
--------------------	-----------------------	--------------

Resistance (ohms), N=6 speciments, 10V-100V

Wrist Strap (Band and Cord)	0.8×10^6 to 1.2×10^6	See Table 1	ANSI/ESD S1.1 (Section 6.1)
Wristband Interior	$< 1.0 \times 10^5$	See Table 1	ANSI/ESD S1.1 (Section 6.2)
Wristband Exterior	$> 1.0 \times 10^7$	See Table 1	ANSI/ESD S1.1 (Section 6.2)
Wrist Strap System	$< 3.5 \times 10^7$	See Table 1	ANSI/ESD S1.1 (Section 6.10)

Test Data:

Table 1 – Resistance (ohms)

	Sample#1	Sample#2	Sample#3	Sample#4	Sample#5	Sample#6
Wrist Strap ANSI/ESD S1.1- Figure 2	1.02×10^6	1.01×10^6	1.05×10^6	1.0×10^6	1.0×10^6	1.0×10^6
Wristband Interior ANSI/ESD S1.1- Figure 4	1.0×10^3	1.0×10^3	0.9×10^3	0.7×10^3	0.8×10^3	0.7×10^3
Wristband Exterior ANSI/ESD S1.1- Figure 4	1.7×10^9	1.8×10^9	1.7×10^9	1.7×10^9	1.8×10^9	1.8×10^9
Wrist Strap System ANSI/ESD S1.1- Figure 8	1.5×10^7	1.35×10^7	1.2×10^7	1.5×10^7	1.3×10^7	1.6×10^7

References:

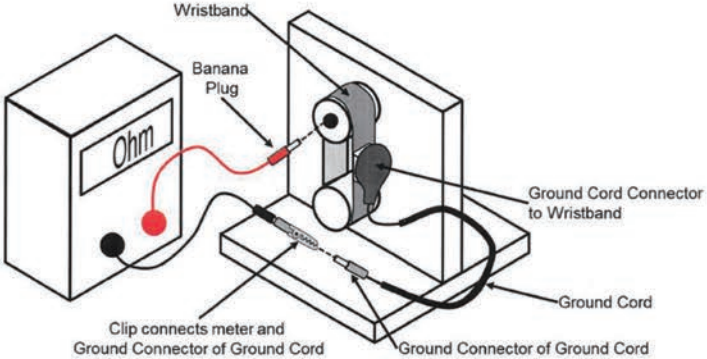

ANSI/ESD S1.1 – Figure 2: Set-up for Wrist Strap Resistance Test

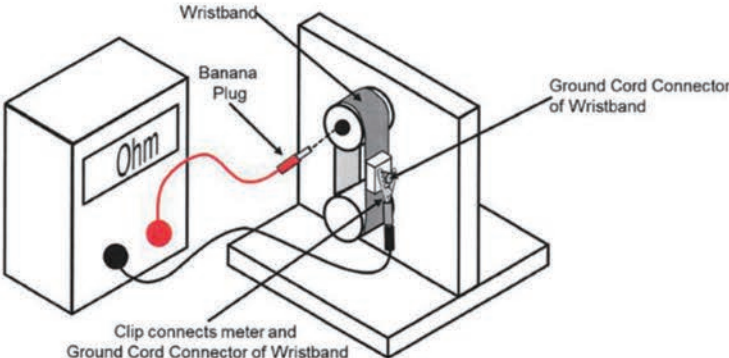

ANSI/ESD S1.1 – Figure 4: Set-up for Wristband Resistance Test

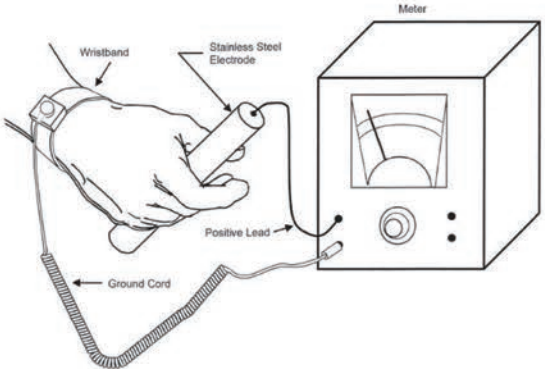

ANSI/ESD S1.1– Figure 8: Wrist Strap System Resistance Test